

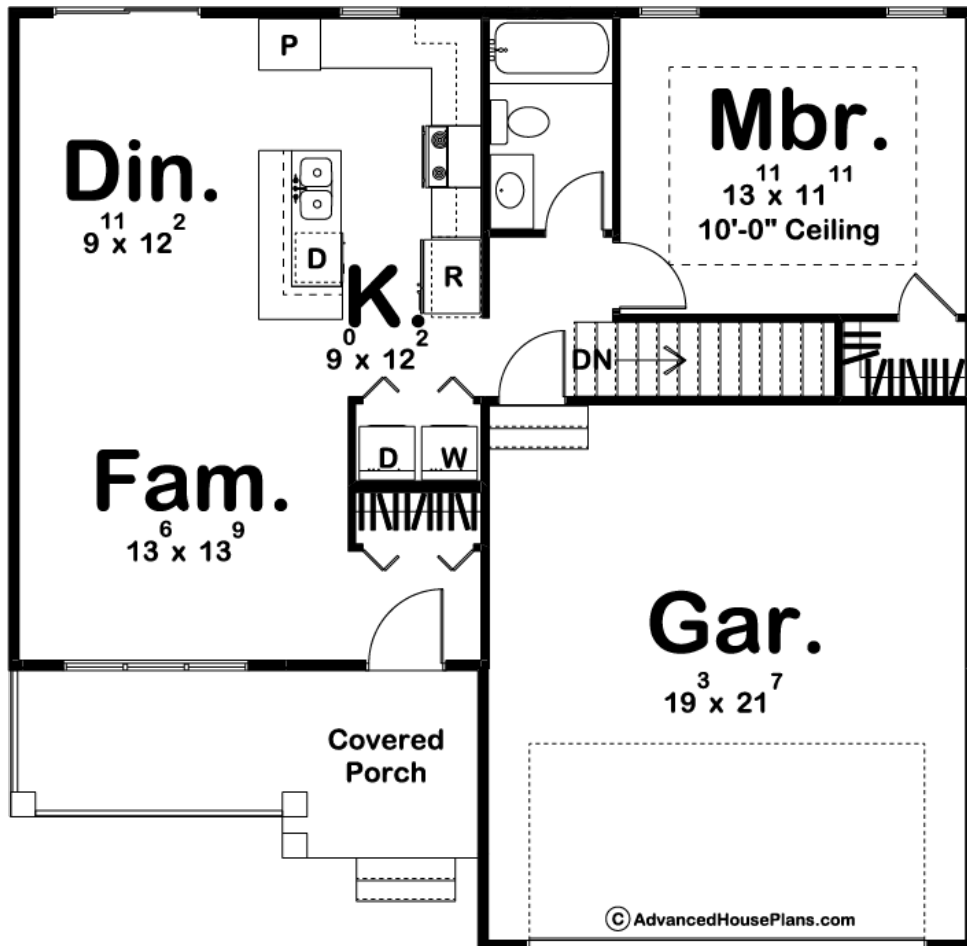

**29284 - Alure Data Sheet**

831 SQ FT	1 BEDS	1 BATHS	2 BAYS	39' 0" WIDE	38' 0" DEEP
--------------	-----------	------------	-----------	----------------	----------------



**Construction Specs**

Layout

Bedrooms

Bathrooms	1
Garage Bays	2
<b>Square Footage</b>	
Main Level	831 Sq. Ft.
Garage	436 Sq. Ft.
Total Finished Area	831 Sq. Ft.
<b>Exterior Dimensions</b>	
Width	39' 0"
Depth	38' 0"
Ridge Height <i>Calculated from main floor line</i>	21' 0"
<b>Default Construction Stats</b> <i>Stats are unique to the individual plan.</i>	
Foundation Type	Basement
Exterior Wall Construction	2x4
Roof Pitches	6/12
Foundation Wall Height	9'
Main Wall Height	9'

## Plan Description

The Alure is a handsome traditional style 1 story house plan with a great floor plan to match! The covered porch is an inviting approach to this house plan with detailed wood columns and board and batten siding. This 1 bedroom home has an open great room perfect for entertaining. The master suite also has a roomy walk-in closet not found in homes this size. The footprint will fit almost any lot and the curb appeal will welcome you home. Be sure to check out our other small house plans.