

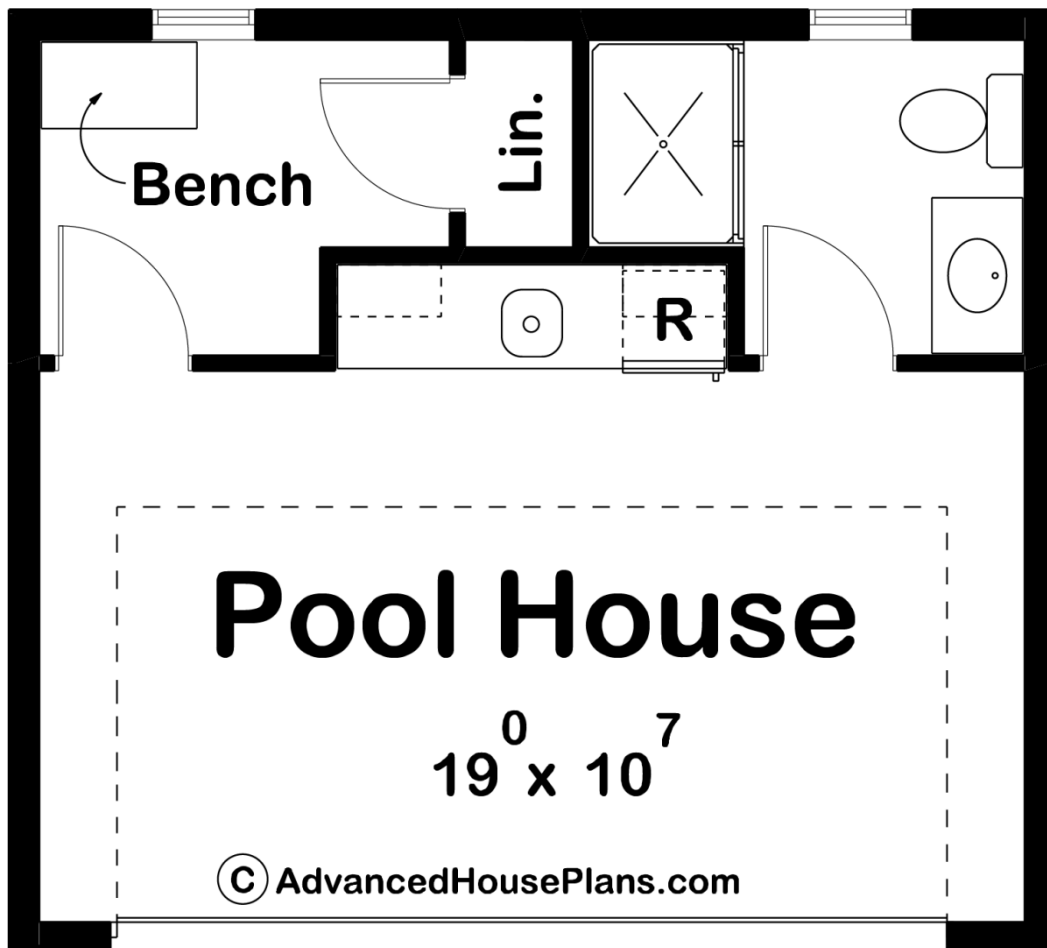

29563 - Alvarado Data Sheet

360 SQ FT	0 BEDS	1 BATHS	0 BAYS	20' 0" WIDE	18' 0" DEEP
--------------	-----------	------------	-----------	----------------	----------------



Construction Specs

Layout

Bathrooms

Square Footage

Main Level	360 Sq. Ft.
Total Finished Area	360 Sq. Ft.

Exterior Dimensions

Width	20' 0"
Depth	18' 0"
Ridge Height <i>Calculated from main floor line</i>	13' 0"

Default Construction Stats

Stats are unique to the individual plan.

Foundation Type	Slab
Exterior Wall Construction	2x4
Main Wall Height	9'

Plan Description

This small pool house design has everything you need! The Alvarado invites all guests through a large front facing garage door. Inside is the perfect space for entertaining. It allows enough room to chose the furnishings of your liking. Centered in the middle of the pool house is a bar equipped with a sink and refrigerator space. This unique pool house design gives owners a storage place for towles and other belongings in the "locker room" area. Perfect for all guest needing a place to slip into their pool attire. Located on the other side of the pool house is a 3/4 bath. The Alvarado plan is practical for any pool owner. Be sure to check out our other pool houses. As always any of our plans at Advanced House Plans can be customized to fit your needs with our alteration department. Whether you need to change the front elevation style, stretch it larger or just make the plan more affordable for your budget we can do that and more for you at Ahp.