

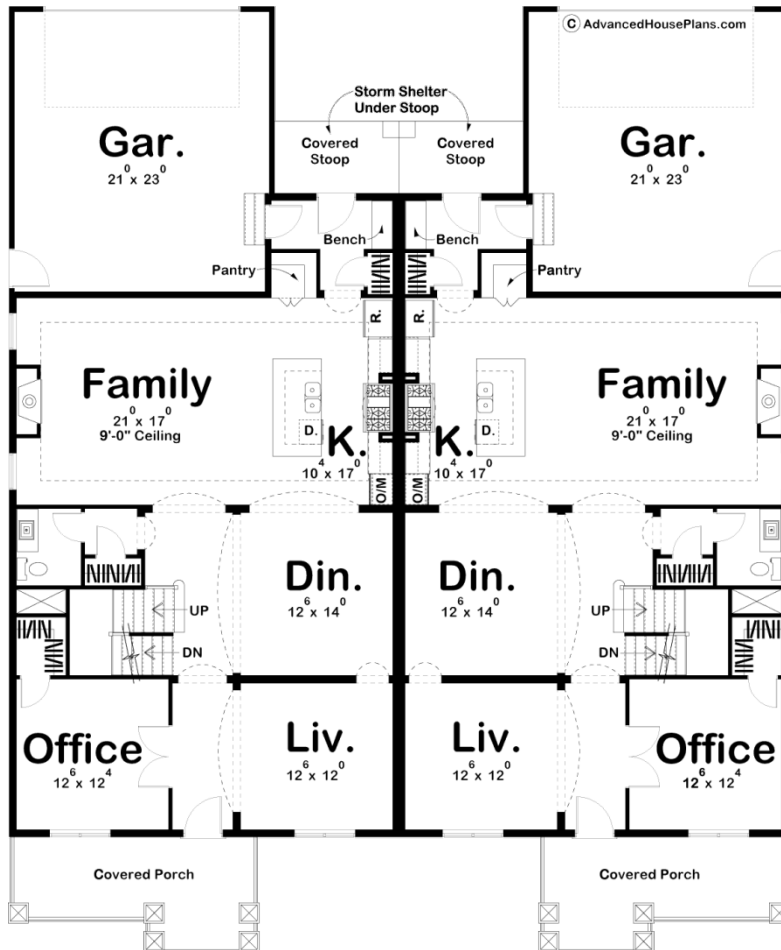

29360 - Arbor Gate Data Sheet

3002 SQ FT	4 BEDS	4 BATHS	2 BAYS	64' 0" WIDE	78' 0" DEEP
---------------	-----------	------------	-----------	----------------	----------------

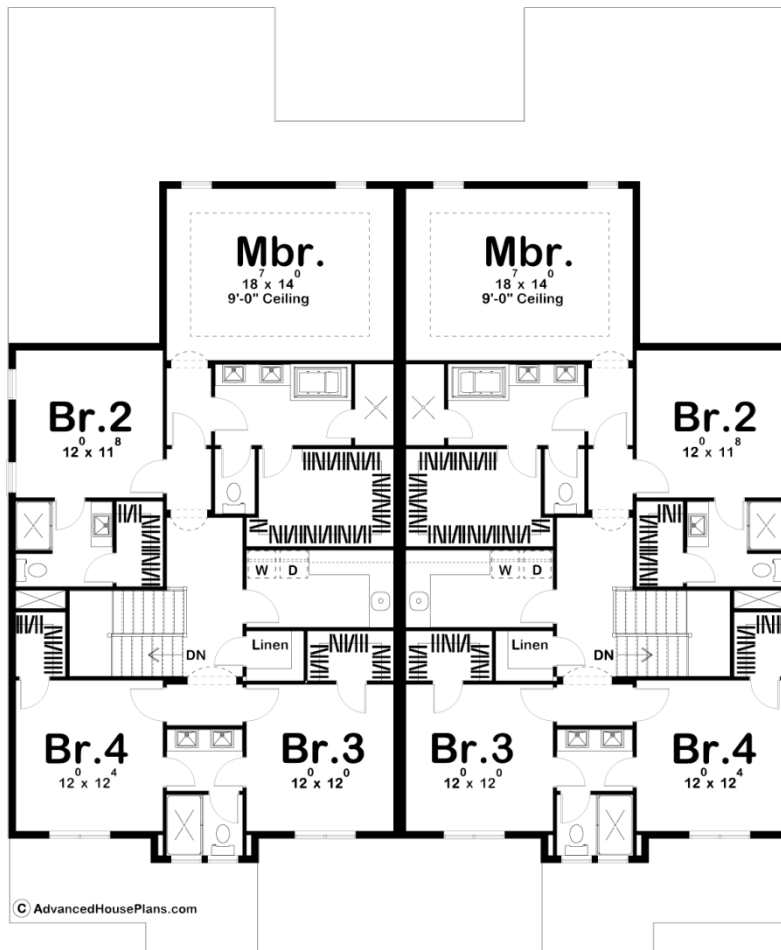



Construction Specs

Layout

Bedrooms	4
Bathrooms	4
Garage Bays	2

Square Footage

Main Level	1506 Sq. Ft.
Second Level	1496 Sq. Ft.
Garage	504 Sq. Ft.
Total Finished Area	3002 Sq. Ft.

Exterior Dimensions

Width	64' 0"
Depth	78' 0"
Ridge Height	30' 0"
<i>Calculated from main floor line</i>	

Default Construction Stats

Stats are unique to the individual plan.

Foundation Type	Basement
Exterior Wall Construction	2x4
Roof Pitches	6/12
Foundation Wall Height	9'
Main Wall Height	9'
Second Wall Height	8'

Plan Description

Solid Craftsman styling on the outside and sleek, fluid room arrangements on the inside make this 3,002 sq. ft. multi-family house plan an attractive choice. Stout columns occupy the front covered porch, where upon entering the home, guests are greeted by views into a living room on one side and a home office on the other. The office, accessed through French doors, features a walk-in closet and has views to the front. A pass-through connects the living room and dining room, which lies just a few steps farther inside. Adjoining the dining room is the kitchen, with its island breakfast bar and pantry. The kitchen lies open to the family room, which showcases a fireplace flanked by windows. Just off the kitchen, a mud room with bench and coat closet accesses the 2-car garage, as well as a covered stoop that sits atop a storm shelter below. Upstairs, the master suite enjoys privacy from the secondary bedrooms and features a bathroom with dual sinks, soaking tub, shower, compartmented toilet and large walk-in closet. All of the secondary bedrooms feature walk-in closets. Bedroom 2 has its own bath, while bedrooms 3 and 4 share a Jack-n-Jill bath. A centrally located laundry with soaking sink and generous counter space conveniently serves all bedrooms.