

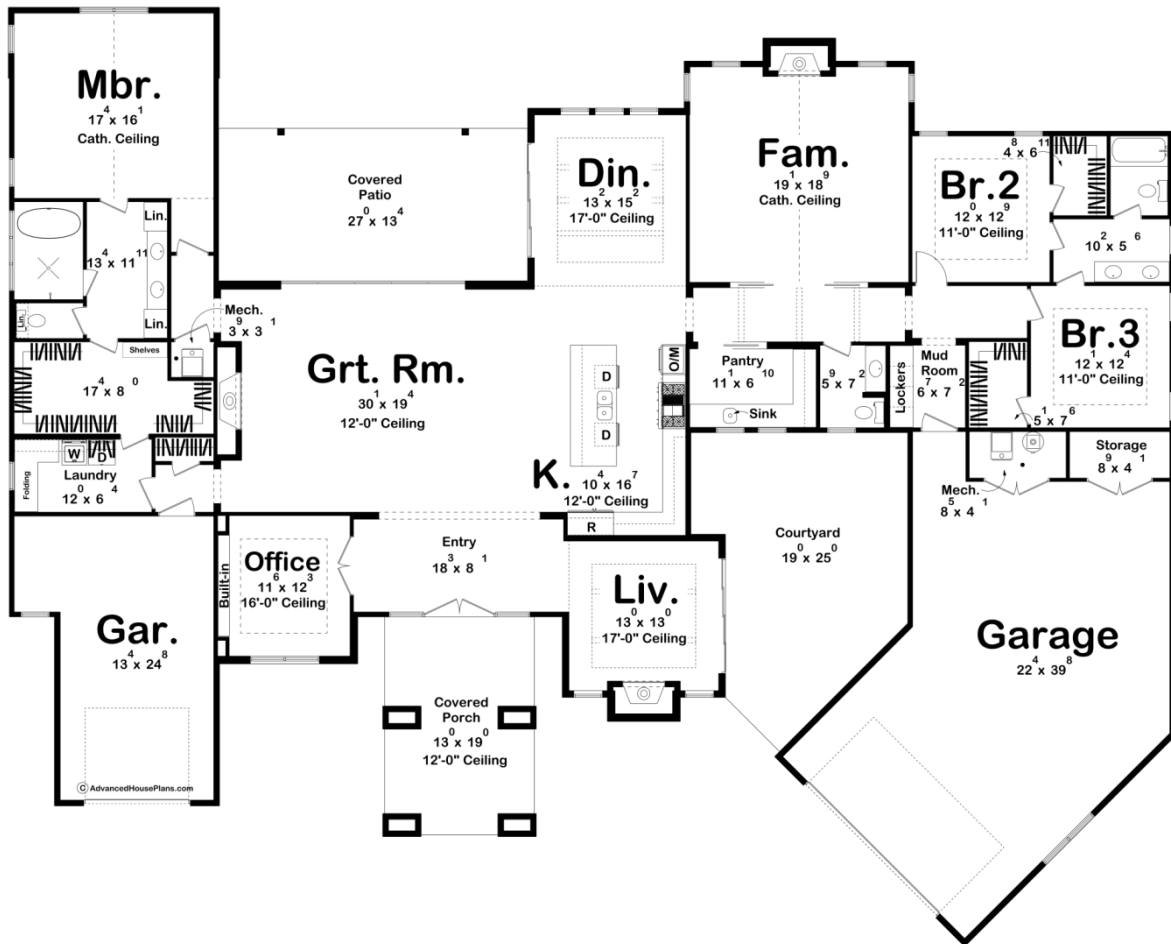

30465 - Arlington Data Sheet

3584 SQ FT	3 BEDS	3 BATHS	3 BAYS	101' 0" WIDE	81' 2" DEEP
---------------	-----------	------------	-----------	-----------------	----------------



Construction Specs

Layout

Bedrooms

Bathrooms	3
Garage Bays	3
Square Footage	
Main Level	3584 Sq. Ft.
Covered Area	605 Sq. Ft.
Garage	1279 Sq. Ft.
Total Finished Area	3584 Sq. Ft.
Exterior Dimensions	
Width	101' 0"
Depth	81' 2"
Ridge Height <i>Calculated from main floor line</i>	24' 10"
Default Construction Stats <i>Stats are unique to the individual plan.</i>	
Foundation Type	Slab
Exterior Wall Construction	2x4
Roof Pitches	Primary 8/12, Secondary 6/12, 5/12
Main Wall Height	10'

Plan Description

The Arlington is a stunning Texas Hillside home blending classic style with modern elegance. Inside, grand ceilings define the spaces—a 17' ceiling with faux wood beams in the living room, cathedral ceilings in the family room and master bedroom, and a soaring 16' ceiling in the office. The master suite offers a serene retreat with a spa-like bathroom featuring a unique tub-in-shower design and an oversized walk-in closet. For everyday ease, enjoy the walk-in pantry, mudroom, and dedicated laundry room. Outside, relax on the expansive covered patio or courtyard, making this 3-bed, 3-bath haven perfect for entertaining and unwinding.