

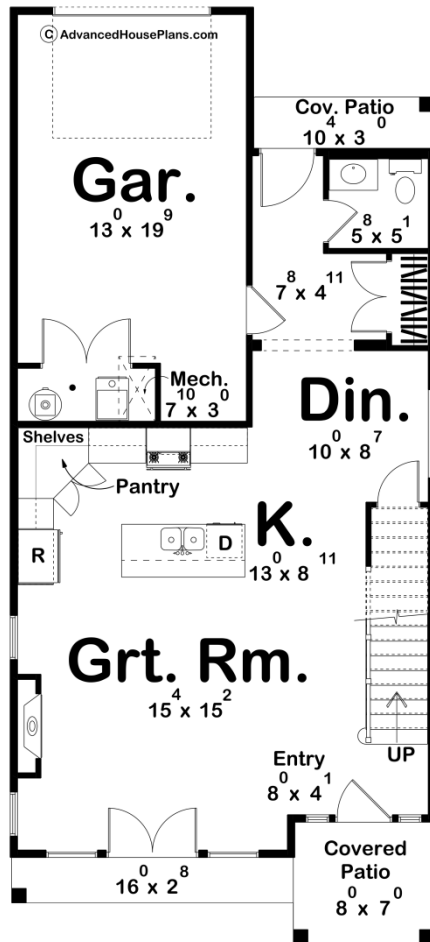

30559 - Beckford Data Sheet

1645 SQ FT	3 BEDS	3 BATHS	1 BAYS	24' 0" WIDE	53' 0" DEEP
---------------	-----------	------------	-----------	----------------	----------------

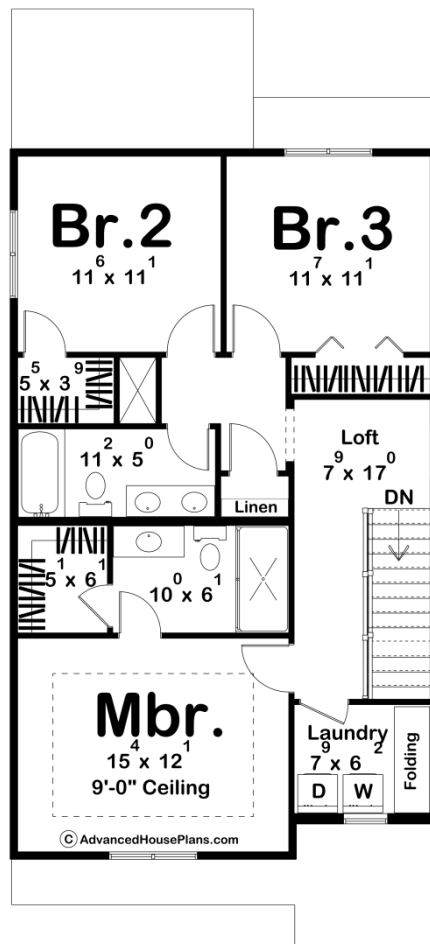



Construction Specs

Layout

Bedrooms	3
Bathrooms	3
Garage Bays	1

Square Footage

Main Level	739 Sq. Ft.
Second Level	906 Sq. Ft.
Covered Area	129 Sq. Ft.
Garage	290 Sq. Ft.
Total Finished Area	1645 Sq. Ft.

Exterior Dimensions

Width	24' 0"
Depth	53' 0"
Ridge Height	27' 4"
<i>Calculated from main floor line</i>	

Default Construction Stats

Stats are unique to the individual plan.

Foundation Type	Slab
Exterior Wall Construction	2x4
Roof Pitches	Primary 8/12
Main Wall Height	9'
Second Wall Height	8'

Plan Description

Introducing the Beckford, a charming two-story home that seamlessly blends traditional style with modern amenities. This thoughtfully designed residence offers three spacious bedrooms and three bathrooms, providing ample space and comfort for your family. Step into the welcoming great room, where a fireplace creates a warm and inviting atmosphere, perfect for relaxing evenings and family gatherings. The covered patio at the front of the house adds to the home's curb appeal and provides a lovely spot for enjoying morning coffee or evening sunsets. Upstairs, convenience reigns with a dedicated laundry room strategically located near the bedrooms, making daily chores easier and more efficient. Each bedroom offers ample space and comfort, ensuring everyone in the family has their own private retreat. Experience the perfect blend of traditional charm and modern functionality in the Beckford. This home is designed to meet all your needs while providing a beautiful and comfortable living environment.