

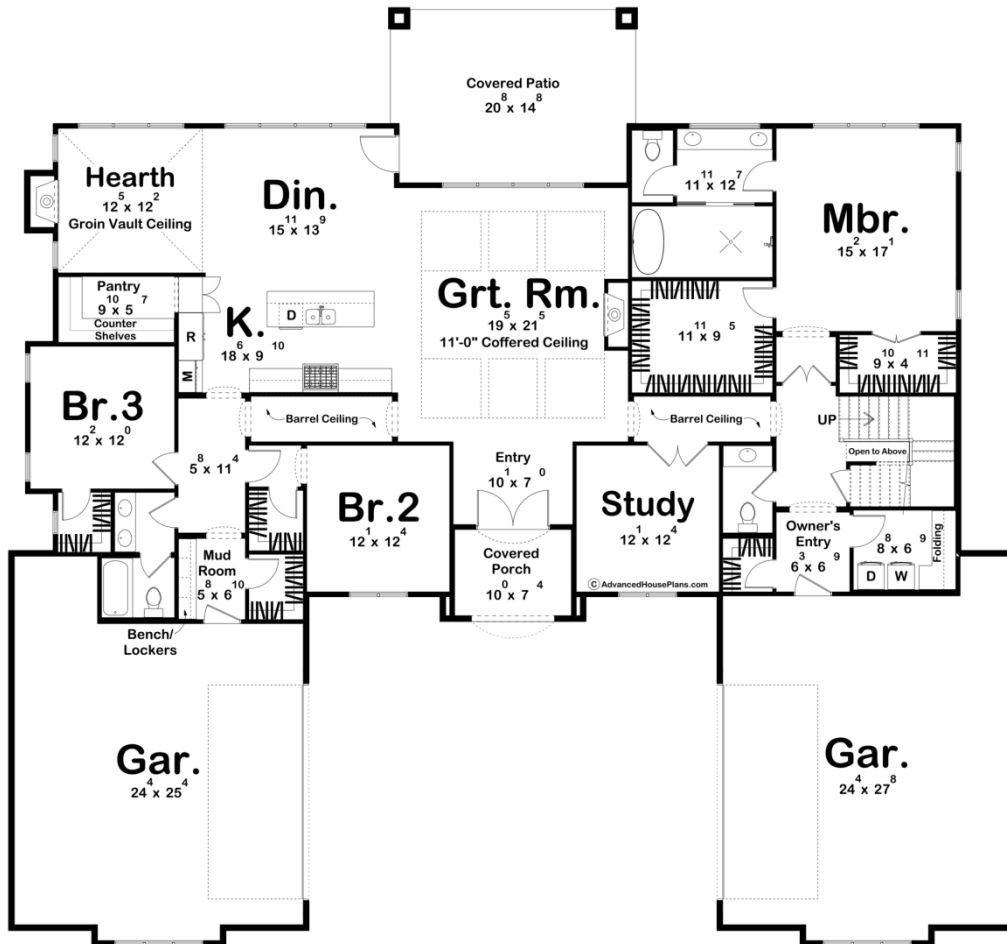

30298 - Blackwood Data Sheet

| | | | | | |
|---------------|-----------|------------|-----------|----------------|----------------|
| 2938 SQ FT | 3 BEDS | 3 BATHS | 4 BAYS | 84' 8" WIDE | 78' 8" DEEP |
|---------------|-----------|------------|-----------|----------------|----------------|

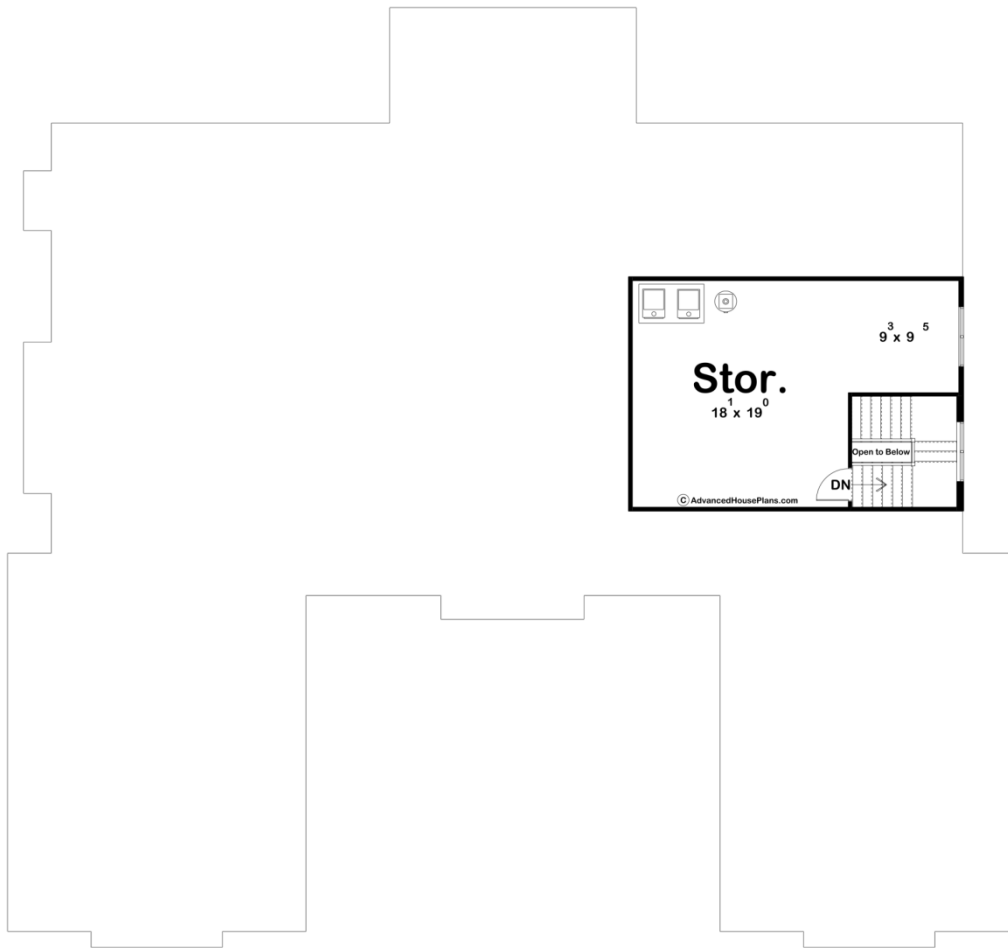



Construction Specs

Layout

| | |
|-------------|---|
| Bedrooms | 3 |
| Bathrooms | 3 |
| Garage Bays | 4 |

Square Footage

| | |
|---------------------|--------------|
| Main Level | 2938 Sq. Ft. |
| Covered Area | 376 Sq. Ft. |
| Garage | 1429 Sq. Ft. |
| Total Finished Area | 2938 Sq. Ft. |

Exterior Dimensions

| | |
|--|--------|
| Width | 84' 8" |
| Depth | 78' 8" |
| Ridge Height | 28' 8" |
| <i>Calculated from main floor line</i> | |

Default Construction Stats

Stats are unique to the individual plan.

| | |
|----------------------------|--------------------------------------|
| Foundation Type | Slab |
| Exterior Wall Construction | 2x4 |
| Roof Pitches | Primary 10/12, Secondary 14/12, 4/12 |
| Main Wall Height | 10' |

Plan Description

This Modern Cottage-style house plan features a timeless and balanced design, showcasing a brick exterior that exudes warmth and classic charm. The facade is adorned with wood shutters, adding a touch of traditional elegance to the overall aesthetic. On both sides of the house, spacious garages provide ample parking space while helping the home maintain a cohesive and harmonious look. Upon entering through the covered stoop, you are greeted by an open floor plan that seamlessly connects various living spaces. The hearth room serves as a cozy retreat, featuring a fireplace that adds both warmth and a touch of old-world charm to the interior. The layout emphasizes an openness that is great for entertaining. The master suite boasts his and hers closets, offering convenient and well-organized storage space. Ascending to the second level, you'll discover a dedicated storage room, providing additional space for belongings. Overall, this colonial-style house plan combines classic architectural elements with modern functionality, creating a welcoming and comfortable home for residents.