

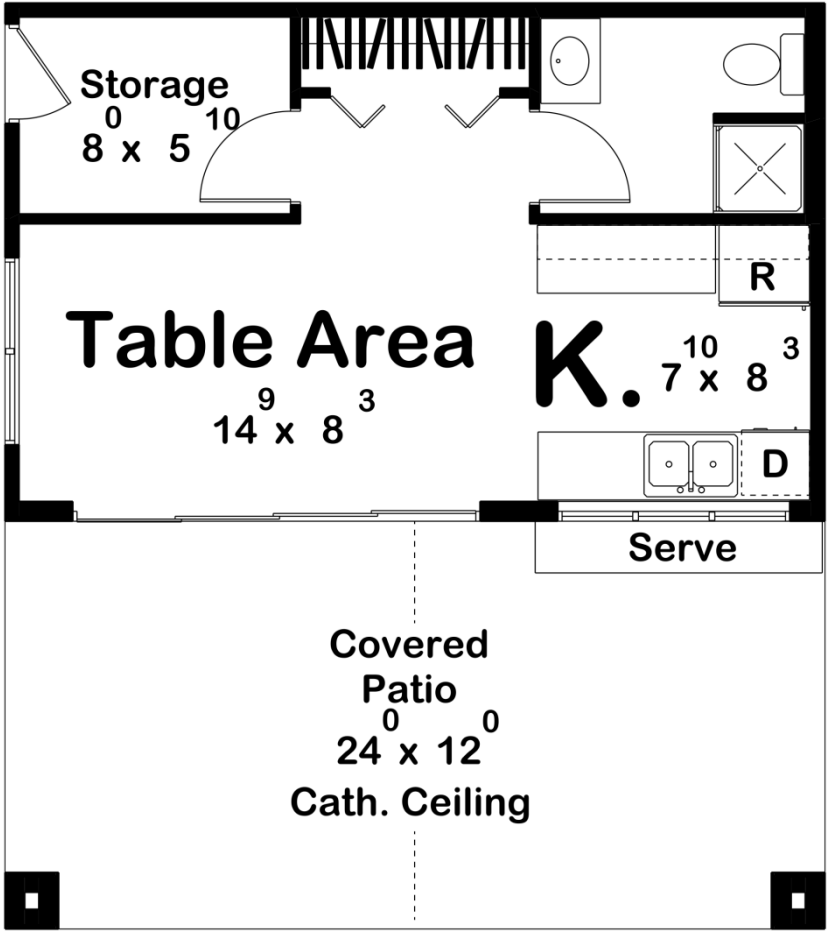

30157 - Bridges Bay Data Sheet

360 SQ FT	0 BEDS	1 BATHS	0 BAYS	24' 0" WIDE	27' 0" DEEP
--------------	-----------	------------	-----------	----------------	----------------



Construction Specs

Layout

Bathrooms

Square Footage		
Main Level		360 Sq. Ft.
Covered Area		288 Sq. Ft.
Total Finished Area		360 Sq. Ft.
Exterior Dimensions		
Width		24' 0"
Depth		27' 0"
Default Construction Stats		
<i>Stats are unique to the individual plan.</i>		
Foundation Type		Slab
Exterior Wall Construction		2x4
Roof Pitches		4/12 Primary
Main Wall Height		10'

Plan Description

The Bridges Bay pool house plan is a perfect addition for any pool owner. Decorative wood trusses and stone accents create an appealing look for the exterior. A large, covered patio accesses the interior through a large sliding glass door. Just inside the door is a large table area and kitchen. The kitchen includes a refrigerator and dishwasher. A full bathroom with a walk-in shower can be found inside as well.