

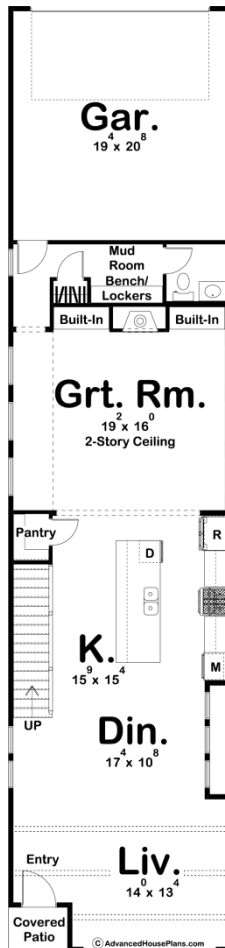

**29843 - Brownville Data Sheet**

|               |           |            |           |                |                |
|---------------|-----------|------------|-----------|----------------|----------------|
| 3209<br>SQ FT | 3<br>BEDS | 4<br>BATHS | 2<br>BAYS | 20' 0"<br>WIDE | 85' 0"<br>DEEP |
|---------------|-----------|------------|-----------|----------------|----------------|

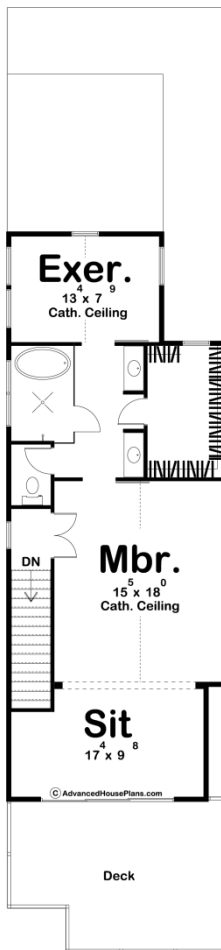

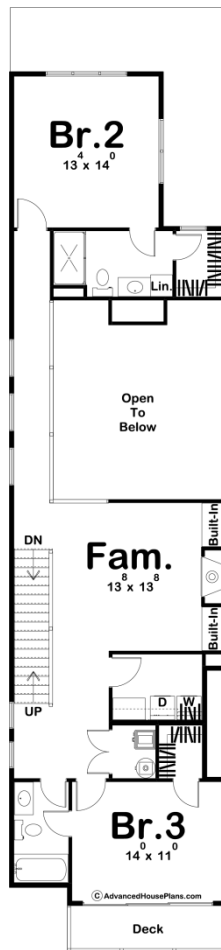

## Construction Specs

## Layout

|             |   |
|-------------|---|
| Bedrooms    | 3 |
| Bathrooms   | 4 |
| Garage Bays | 2 |

## Square Footage

|                     |              |
|---------------------|--------------|
| Main Level          | 1239 Sq. Ft. |
| Second Level        | 1072 Sq. Ft. |
| Third Level         | 898 Sq. Ft.  |
| Garage              | 420 Sq. Ft.  |
| Total Finished Area | 3209 Sq. Ft. |

## Exterior Dimensions

|       |        |
|-------|--------|
| Width | 20' 0" |
| Depth | 85' 0" |

## Default Construction Stats

*Stats are unique to the individual plan.*

|                            |                               |
|----------------------------|-------------------------------|
| Foundation Type            | Slab                          |
| Exterior Wall Construction | 2x4                           |
| Roof Pitches               | 10/12 Primary, 4/12 Secondary |
| Main Wall Height           | 10'                           |
| Second Wall Height         | 8'                            |

## Plan Description

The Brownville is a stunning Modern Farmhouse narrow home. The exterior blends board and batten siding with gable rooflines to give the home a modern farmhouse look. At only 20' wide, this home packs a ton of great features into a home that can fit in almost any lot. On the main level, the living room, dining room, and kitchen flow seamlessly in this open floor plan. The kitchen includes a large island with a snack bar and a walk-in pantry. The great room is warmed by a fireplace that is flanked by built-in bookshelves. The second floor includes a family room and 2 bedrooms. Both bedrooms have access to their own bathroom and each has its own walk-in closet. The second floor family room includes a fireplace that is flanked by built-in bookshelves. The third floor is where you will find the luxurious master suite. The master suite includes a sitting room with access to its own private deck. The master bathroom includes a wet room, his/her vanities, an enclosed toilet, and a large walk-in closet. An exercise room helps complete the master suite.