

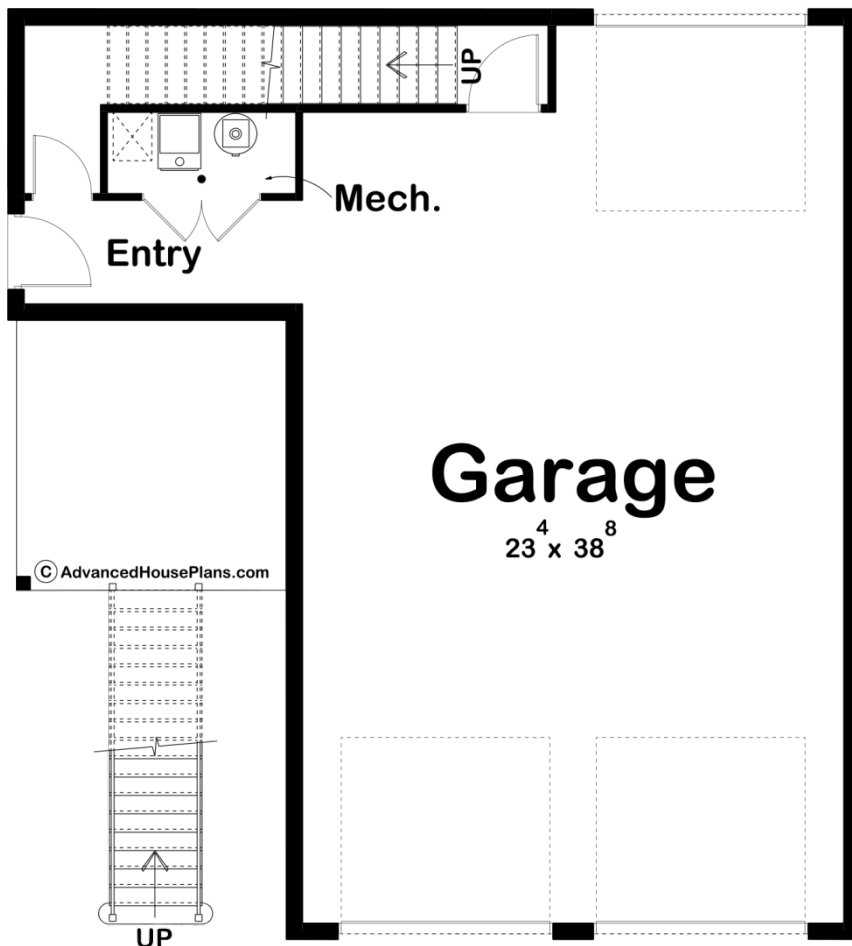

**30195 - Canterbury Data Sheet**

1116 SQ FT	1 BEDS	1 BATHS	3 BAYS	36' 8" WIDE	39' 4" DEEP
---------------	-----------	------------	-----------	----------------	----------------

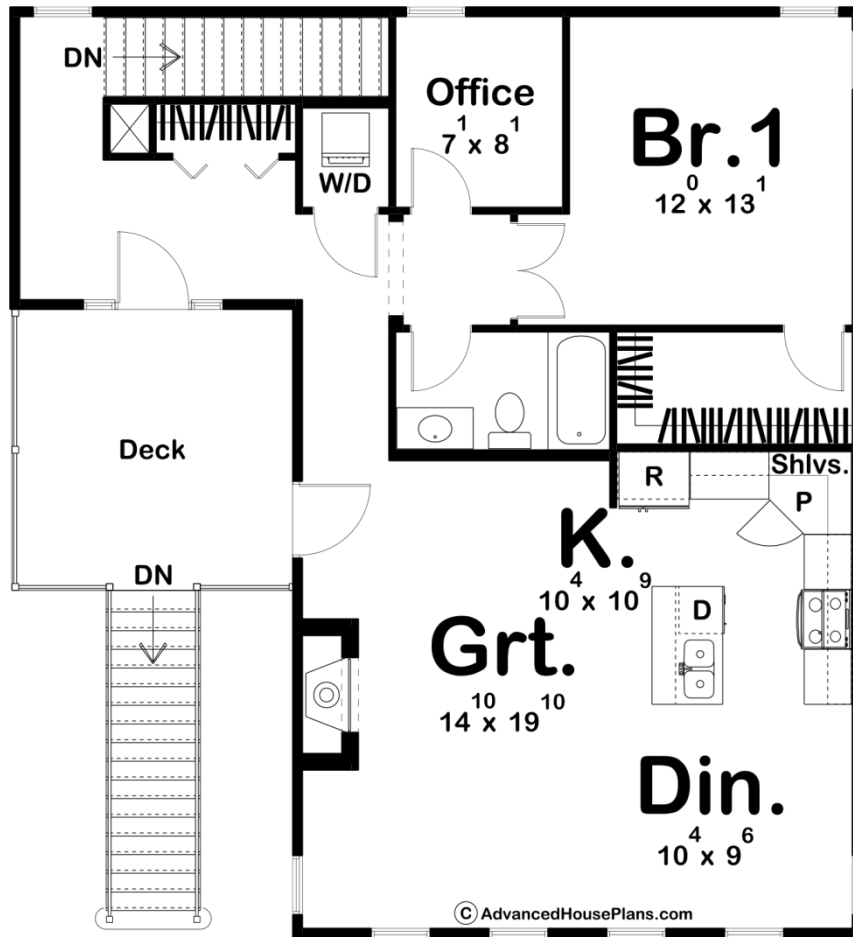



## Construction Specs

### Layout

Bedrooms	1
Bathrooms	1
Garage Bays	3

### Square Footage

Main Level	65 Sq. Ft.
Second Level	1051 Sq. Ft.
Garage	995 Sq. Ft.
Total Finished Area	1116 Sq. Ft.

### Exterior Dimensions

Width	36' 8"
Depth	39' 4"
Ridge Height	29' 1"
<i>Calculated from main floor line</i>	

## Default Construction Stats

*Stats are unique to the individual plan.*

Foundation Type	Slab
Exterior Wall Construction	2x4
Roof Pitches	8/12 Primary
Main Wall Height	10'
Second Wall Height	9'

## Plan Description

The Canterbury plan is a traditional style carriage house plan that is perfect for a small family or person who wants something unique and practical. The exterior of the home with combinations of brick, wood accents, and stucco make this home have a mediterranean feel with true traditional aspects. Heading up the exterior stairs leads you to a gorgeous deck and entrance into either the great room or entryway. Entering through the great room entrance takes you into a beautifully open concept room with the great room, dining, and kitchen. The great room provides a built-in fireplace, and the kitchen with lots of counter space and a gorgeous island. This large room is complete with plenty of windows to allow natural light to peer in and make this space cozy and comfortable. Head down the hallway to find a quaint office, perfect for working from home, with a full bath just across the way. The bedroom can also be found here, complete with a walk-in closet. Downstairs takes you to the two car garage, with garage doors on both the front and rear sides, making the entrance to the home seamless and easy.