

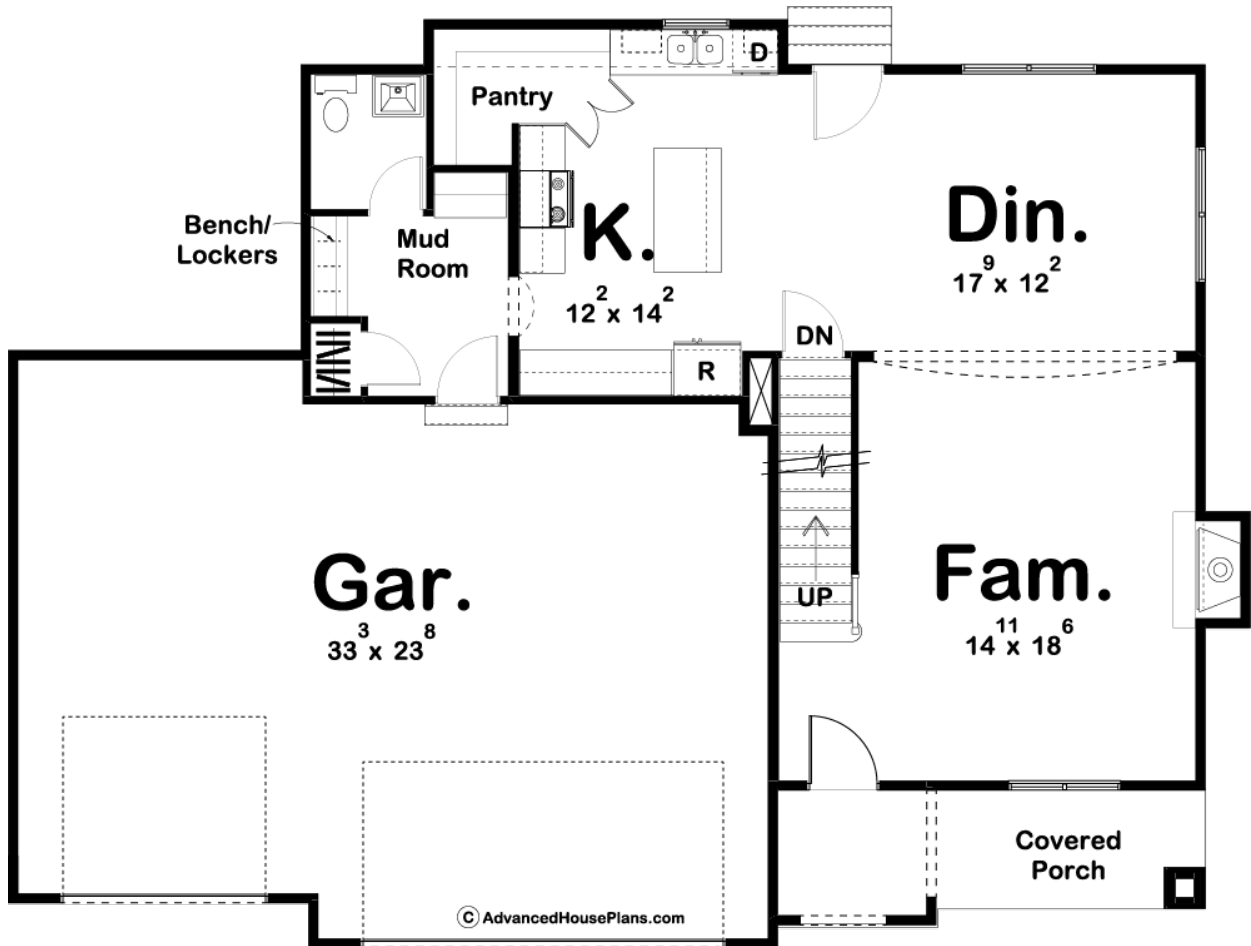

29401 - Captiva Data Sheet

2251 SQ FT	4 BEDS	3 BATHS	3 BAYS	55' 0" WIDE	41' 0" DEEP
---------------	-----------	------------	-----------	----------------	----------------

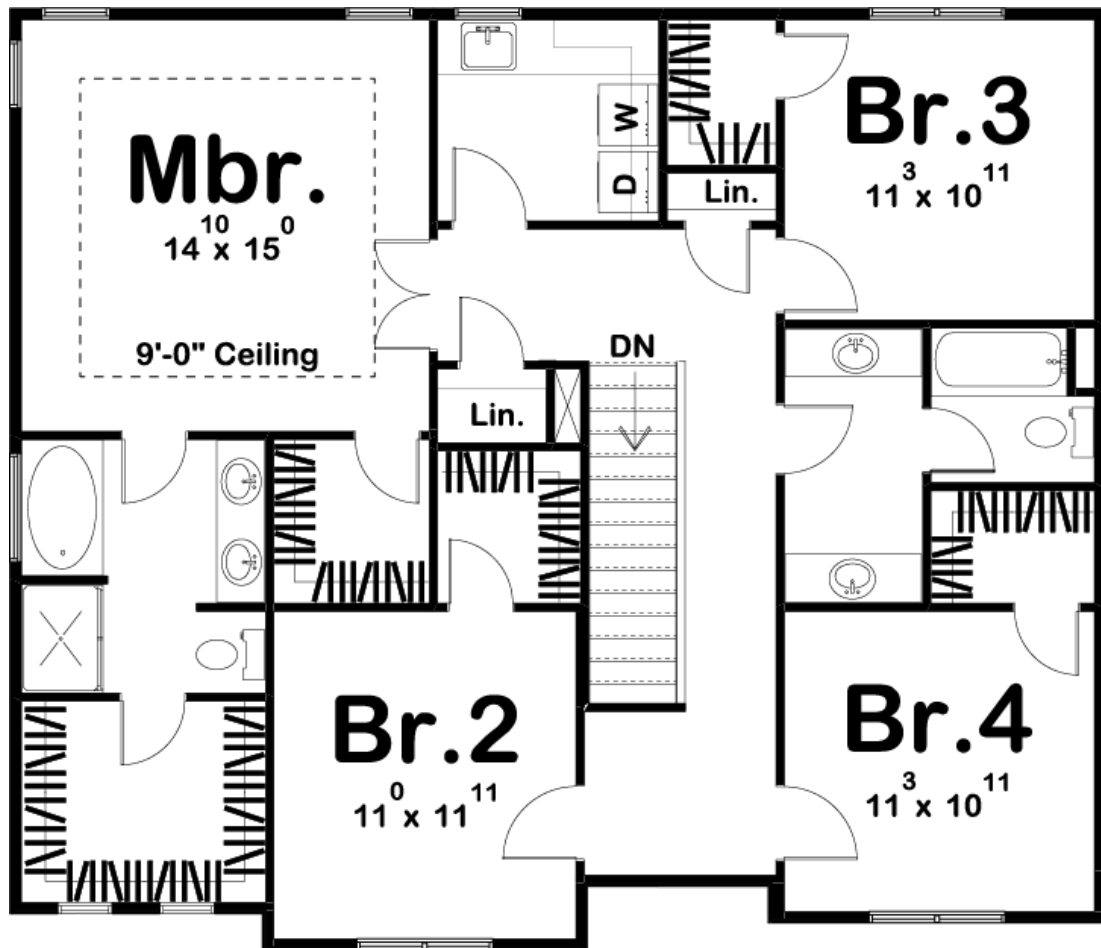



Construction Specs

Layout

Bedrooms	4
Bathrooms	3
Garage Bays	3

Square Footage

Main Level	961 Sq. Ft.
Second Level	1290 Sq. Ft.
Garage	811 Sq. Ft.
Total Finished Area	2251 Sq. Ft.

Exterior Dimensions

Width	55' 0"
Depth	41' 0"
Ridge Height	30' 0"
<i>Calculated from main floor line</i>	

Default Construction Stats

Stats are unique to the individual plan.

Foundation Type	Basement
Exterior Wall Construction	2x4
Roof Pitches	6/12
Foundation Wall Height	9'
Main Wall Height	9'
Second Wall Height	8'

Plan Description

Distinct Mediterranean accents embellish the front of this smartly designed, 2-story house plan. Just inside from the shelter of the covered front porch, guests are welcomed by expansive views of the family room and naturally illuminated dining area beyond. The dining area lies open to the kitchen which features an island with breakfast bar, ample counter space, and roomy walk-in pantry. Just off the kitchen, a mudroom with bench, lockers, coat closet and powder bath, provides a buffer between the home's living areas and the 3-car garage. Upstairs bedrooms are configured for family life, with the master suite well separated from the secondary bedrooms. This master suite features his and her walk-in closets and a bath with dual sinks, soaking tub and shower. Bedrooms 2, 3 and 4 each have walk-in closets and share a centrally located hall bath. An upstairs laundry with folding counter, soaking sink, and nearby linen closet is convenient to all of the bedrooms.