

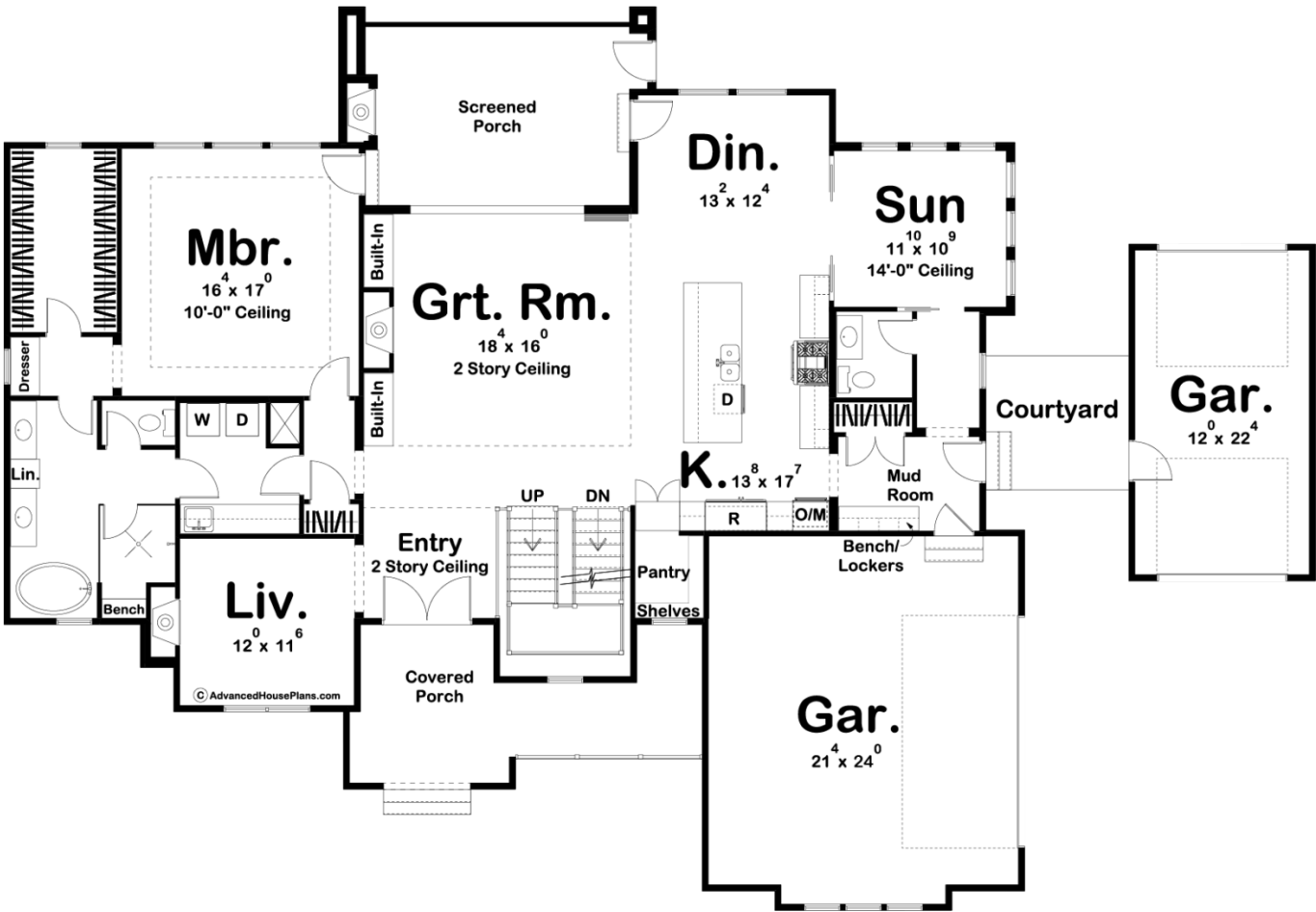

30142 - Cherrywood Data Sheet

3289 SQ FT	4 BEDS	4 BATHS	3 BAYS	90' 0" WIDE	62' 0" DEEP
---------------	-----------	------------	-----------	----------------	----------------





Construction Specs

Layout

Bedrooms	4
Bathrooms	4
Garage Bays	3

Square Footage

Main Level	2216 Sq. Ft.
Second Level	1073 Sq. Ft.
Covered Area	444 Sq. Ft.
Garage	849 Sq. Ft.
Total Finished Area	3289 Sq. Ft.

Exterior Dimensions

Width	90' 0"
Depth	62' 0"

Default Construction Stats

Stats are unique to the individual plan.

Foundation Type	Basement
Exterior Wall Construction	2x4
Roof Pitches	6/12 Primary, 10/12 Secondary
Foundation Wall Height	9'
Main Wall Height	10'
Second Wall Height	8'

Plan Description

If you are looking for luxury, look no further than the Cherrywood. The Cherrywood is a stunning 1.5 Story Modern Farmhouse. The modern exterior of the home features contrasting board and batten siding, metal roof accents, and wood garage doors. The inviting front covered porch welcomes guests into the home. Just inside the front set of French doors, you'll find yourself in a 2 story entry way. To the left of the entry is a wonderful formal living room that includes a fireplace. The home's great room, dining room, and kitchen flow seamlessly in a wide-open layout. The great room is warmed by a fireplace that is flanked by built-in bookshelves. The great room opens up to the rear screened porch through a large set of doors. The kitchen in this home includes a large island with a snack bar, tons of counter space, and a large walk-in pantry. You'll find an amazing sun room off the kitchen and dining room. The master suite is conveniently located on the main level. The master bedroom lies under a decorative trayed ceiling and has it's own door to the screened porch. The master bathroom includes a soaking tub, his/her vanities, and a large walk-in shower. The master bathroom also includes access to the laundry room. The second floor includes 3 additional bedrooms and a wonderful loft space. There is a stunning walkway that overlooks the living spaces below. Bedroom 2 has access to its own bathroom while bedrooms 3 and 4 share a Hollywood bath. Back on the main level, the homes split 3 car garage accesses the home through a convenient mud room with a bench, lockers, and coat closet.