

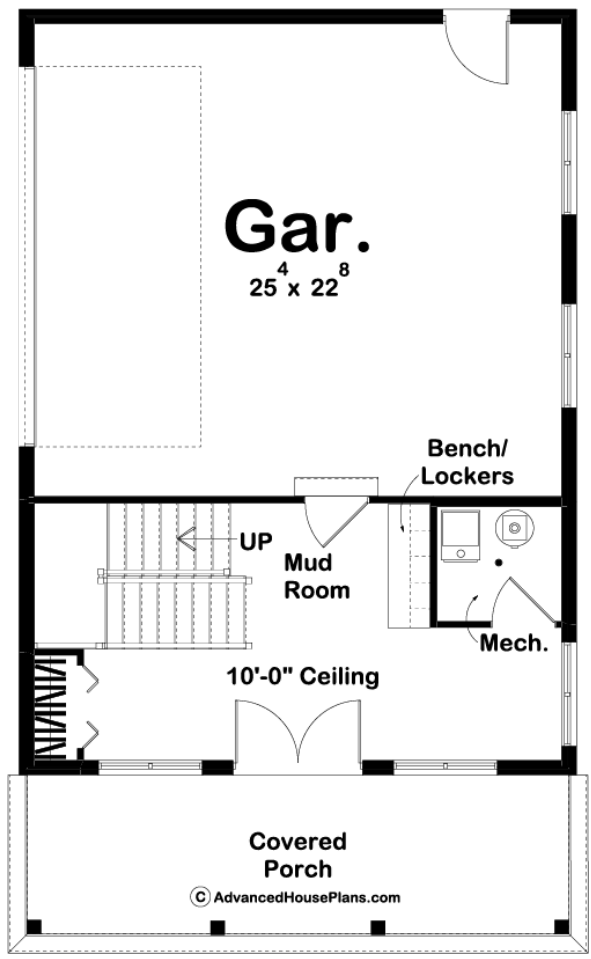

### 29746 - Chesapeake Bay Data Sheet

|               |           |            |           |                |                |
|---------------|-----------|------------|-----------|----------------|----------------|
| 1215<br>SQ FT | 1<br>BEDS | 1<br>BATHS | 2<br>BAYS | 26' 0"<br>WIDE | 36' 0"<br>DEEP |
|---------------|-----------|------------|-----------|----------------|----------------|

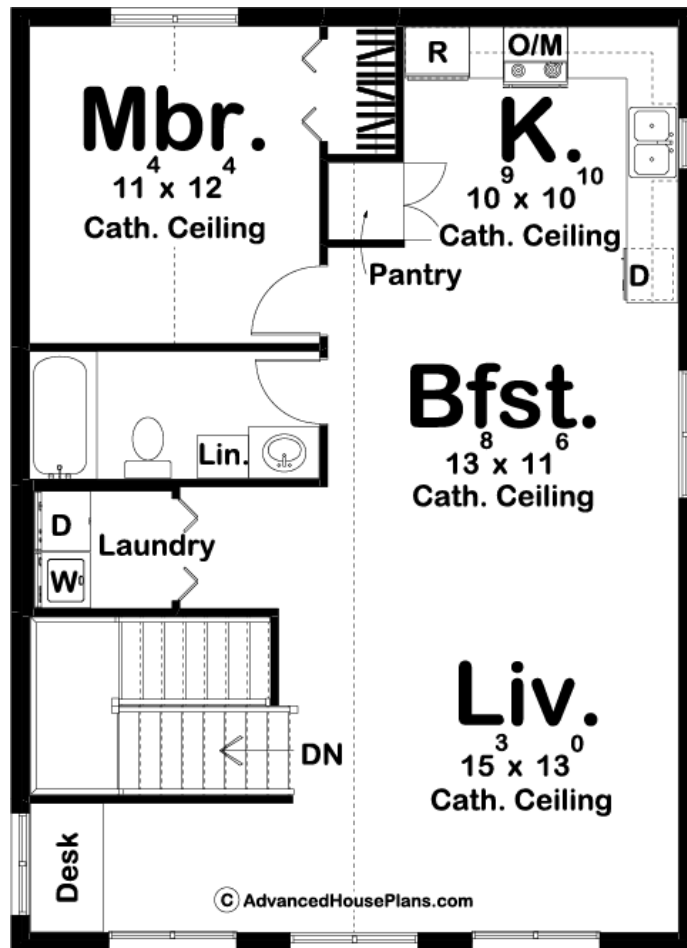



## Construction Specs

### Layout

|             |   |
|-------------|---|
| Bedrooms    | 1 |
| Bathrooms   | 1 |
| Garage Bays | 2 |

### Square Footage

|                     |              |
|---------------------|--------------|
| Main Level          | 348 Sq. Ft.  |
| Second Level        | 867 Sq. Ft.  |
| Garage              | 600 Sq. Ft.  |
| Total Finished Area | 1215 Sq. Ft. |

### Exterior Dimensions

|       |        |
|-------|--------|
| Width | 26' 0" |
| Depth | 36' 0" |

### Default Construction Stats

*Stats are unique to the individual plan.*

|                 |      |
|-----------------|------|
| Foundation Type | Slab |
|-----------------|------|

|                            |                              |
|----------------------------|------------------------------|
| Exterior Wall Construction | 2x4                          |
| Roof Pitches               | 6/12 Primary, 4/12 Secondary |
| Main Wall Height           | 10'                          |
| Second Wall Height         | 8'                           |

## Plan Description

If you are looking for some extra parking space and a place for the family to stay, the Chesapeake Bay is the perfect plan for you. The classic brick exterior gives this apartment garage a traditional feel. On the main level, you'll find a 2 car garage with a mudroom. On the upper level of this garage, you will find an efficient apartment that has a full kitchen.