

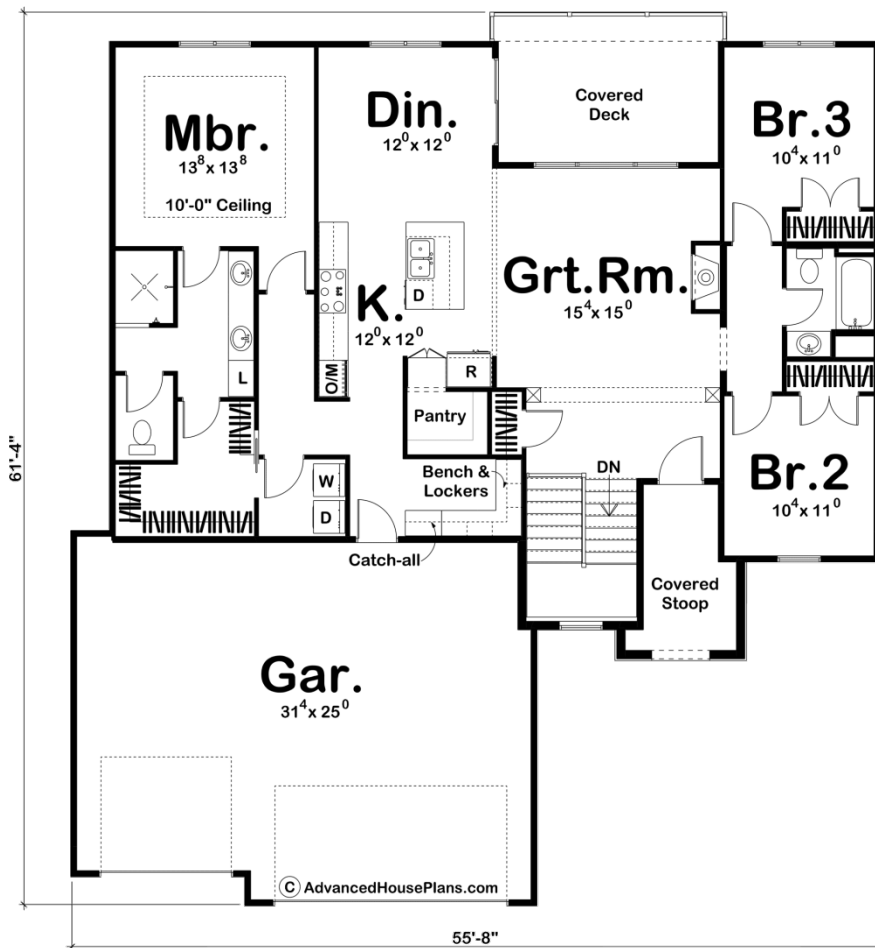

**29330 - Cleveland Data Sheet**

1734 SQ FT	3 BEDS	2 BATHS	3 BAYS	56' 0" WIDE	62' 0" DEEP
---------------	-----------	------------	-----------	----------------	----------------



**Construction Specs**

**Layout**

Bedrooms

Bathrooms	2
Garage Bays	3

### Square Footage

Main Level	1734 Sq. Ft.
Garage	774 Sq. Ft.
Total Finished Area	1734 Sq. Ft.

### Exterior Dimensions

Width	56' 0"
Depth	62' 0"
Ridge Height <i>Calculated from main floor line</i>	21' 0"

### Default Construction Stats

*Stats are unique to the individual plan.*

Foundation Type	Basement
Exterior Wall Construction	2x4
Roof Pitches	6/12
Foundation Wall Height	9'
Main Wall Height	9'

## Plan Description

Stylish Mediterranean details on the outside, coupled with efficiently designed spaces inside, make this 1,734 sq. ft, 1-story house plan an attractive choice for those seeking a home design under 1,800 sq. ft. Just inside from the covered stoop, guests are greeted by views into the great room and the rear covered deck beyond. The great room, with fireplace, has open views to the kitchen and dining area -- which expands entertaining options with access to the rear covered deck. The kitchen features a practical island workspace with breakfast bar, in addition to a handy walk-in pantry. Just off the kitchen, a mudroom with built-in bench, lockers, and catch-all area, acts as a buffer between the 3-car garage and the home's living spaces. The secluded master suite features a 10-foot-high boxed ceiling and a bath area that includes dual sinks, compartmented toilet, and a generous walk-in closet. Bedrooms 2 and 3 are located on the opposite side of the home and share a central hall bath.