

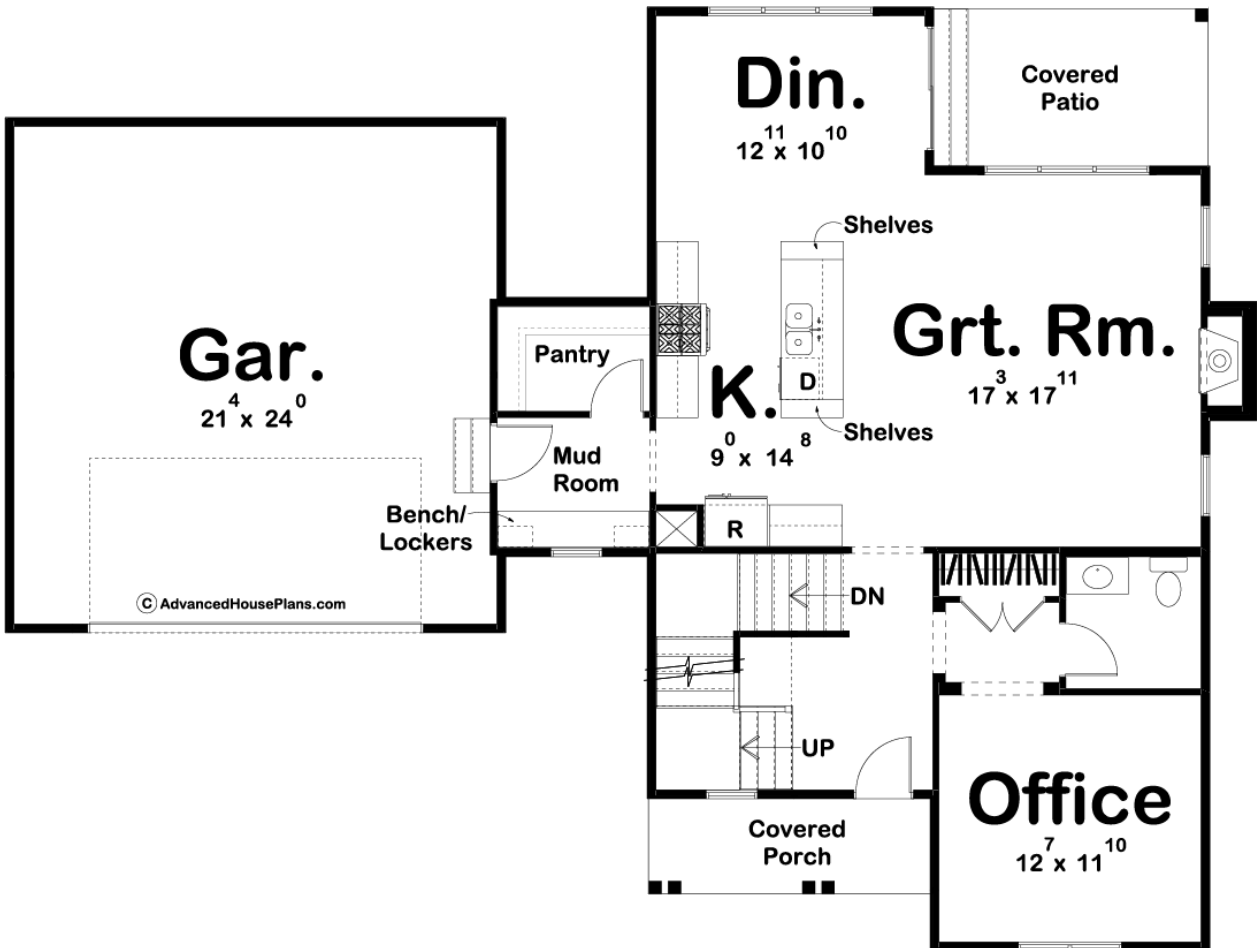

29642 - Collins Data Sheet

1994 SQ FT	3 BEDS	3 BATHS	2 BAYS	60' 0" WIDE	45' 4" DEEP
---------------	-----------	------------	-----------	----------------	----------------

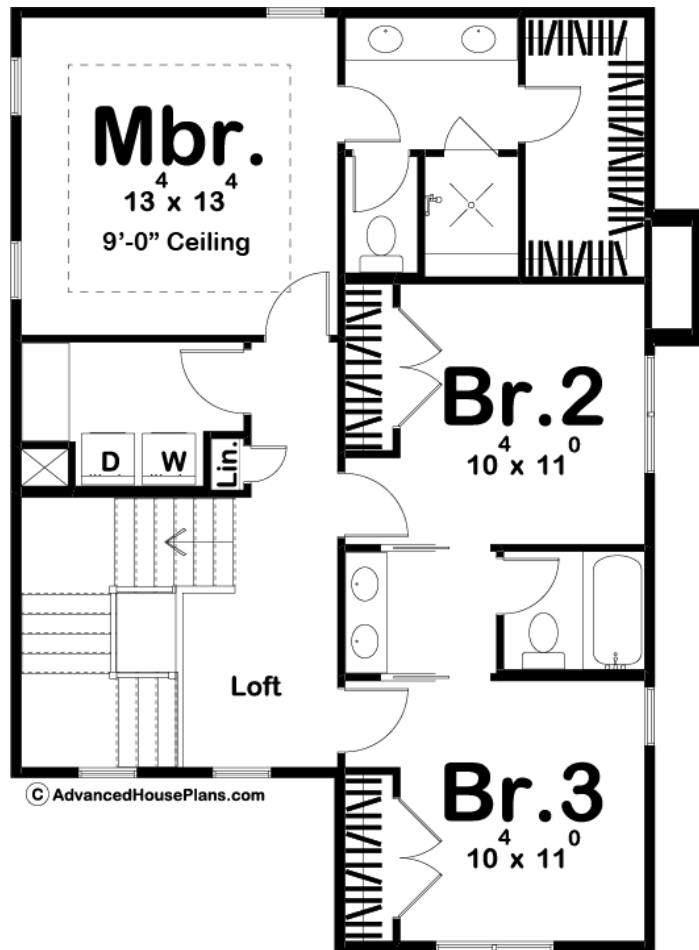



Construction Specs

Layout

Bedrooms	3
Bathrooms	3
Garage Bays	2

Square Footage

Main Level	1112 Sq. Ft.
Second Level	882 Sq. Ft.
Total Finished Area	1994 Sq. Ft.

Exterior Dimensions

Width	60' 0"
Depth	45' 4"
Ridge Height <i>Calculated from main floor line</i>	30' 0"

Default Construction Stats

Stats are unique to the individual plan.

Foundation Type	Basement
Exterior Wall Construction	2x4
Roof Pitches	8/12 Primary, 12/12 4/12 Secondary
Foundation Wall Height	9'
Main Wall Height	9'
Second Wall Height	8'

Plan Description

This beautifully configured Modern Farmhouse plan offers an open efficient floor plan. On the outside, board and batten siding and a covered porch put on a striking display of curb appeal. Just inside, you'll be amazed at the open floor plan including a magnificent great room, which is warmed by a fireplace and flows into the open kitchen and dining room. The kitchen boasts a spacious island with a breakfast bar. Just beyond the dining room, a covered patio extends entertaining options. Upstairs, the master suite enjoys an efficient bath, complete with a compartmented toilet, walk-in shower, dual vanities, and a large walk-in closet. Bedrooms 2 and 3 share a convenient Jack and Jill bathroom. Back on the main floor, the large 2 car garage accesses the home through a convenient mudroom complete with a bench and lockers.