

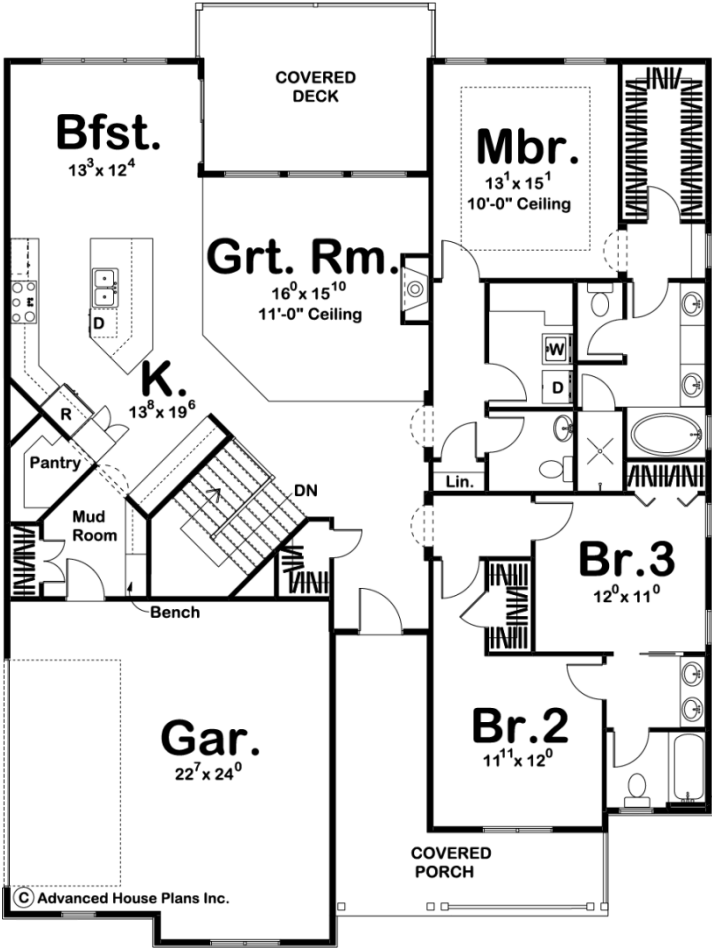

29295 - Copperden Data Sheet

2122 SQ FT	3 BEDS	3 BATHS	2 BAYS	50' 0" WIDE	63' 0" DEEP
---------------	-----------	------------	-----------	----------------	----------------



Construction Specs

Layout

Bedrooms

Bathrooms	3
Garage Bays	2
Square Footage	
Main Level	2122 Sq. Ft.
Garage	543 Sq. Ft.
Total Finished Area	2122 Sq. Ft.
Exterior Dimensions	
Width	50' 0"
Depth	63' 0"
Ridge Height <i>Calculated from main floor line</i>	25' 0"
Default Construction Stats <i>Stats are unique to the individual plan.</i>	
Foundation Type	Basement
Exterior Wall Construction	2x4
Foundation Wall Height	9'
Main Wall Height	9'

Plan Description

A pair of gables rises above a deep covered front porch, giving this 2,122 sq. ft., 1-story house plan an undeniable sense of country charm. Once inside, welcoming views extend into the great room, with 11-foot-high ceiling and covered rear deck beyond. The kitchen boasts ample counter space, island work area with a breakfast bar and a walk-in pantry. The breakfast area accesses the rear covered deck for outdoor dining options. Just off the kitchen, a mudroom with built-in bench intercepts traffic between the home's living areas and the side-load, 2-car garage. The master suite is privately situated from the hustle and bustle of the home. Its bath area includes his and her vanities, soaking tub, shower, compartmented toilet and walk-in closet. Bedrooms 2 and 3 share a Jack-n-Jill bath. A central hall laundry room handily serves all bedrooms. As always any Advanced House Plans home plan can be customized to fit your needs with our alteration department. Whether you need to add another garage stall, change the front elevation, stretch the home larger or just make the home plan more affordable for your budget we can do that and more for you at Ahp.