

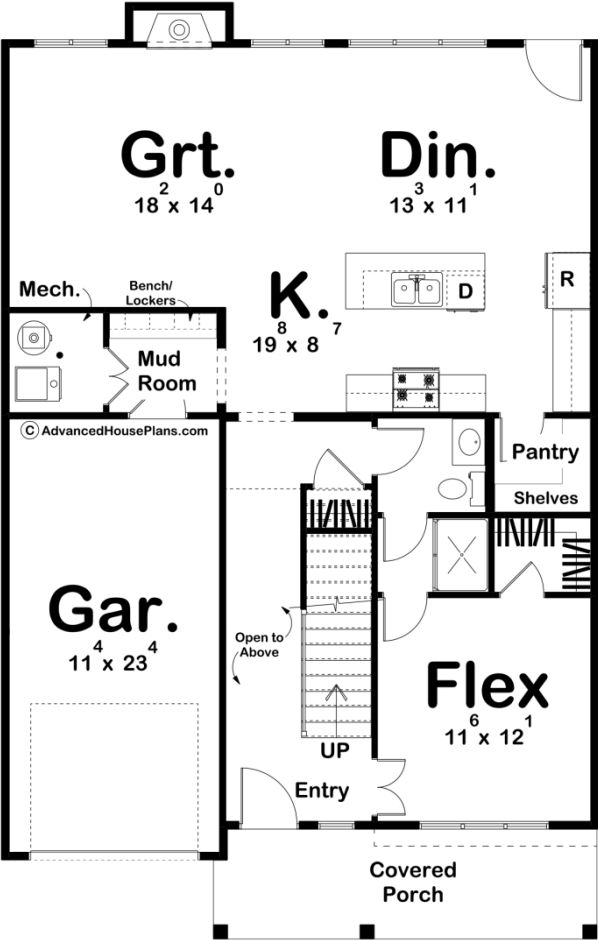

30246 - Crandall Data Sheet

|               |           |            |           |                |                |
|---------------|-----------|------------|-----------|----------------|----------------|
| 2177<br>SQ FT | 3<br>BEDS | 3<br>BATHS | 1<br>BAYS | 32' 0"<br>WIDE | 50' 4"<br>DEEP |
|---------------|-----------|------------|-----------|----------------|----------------|





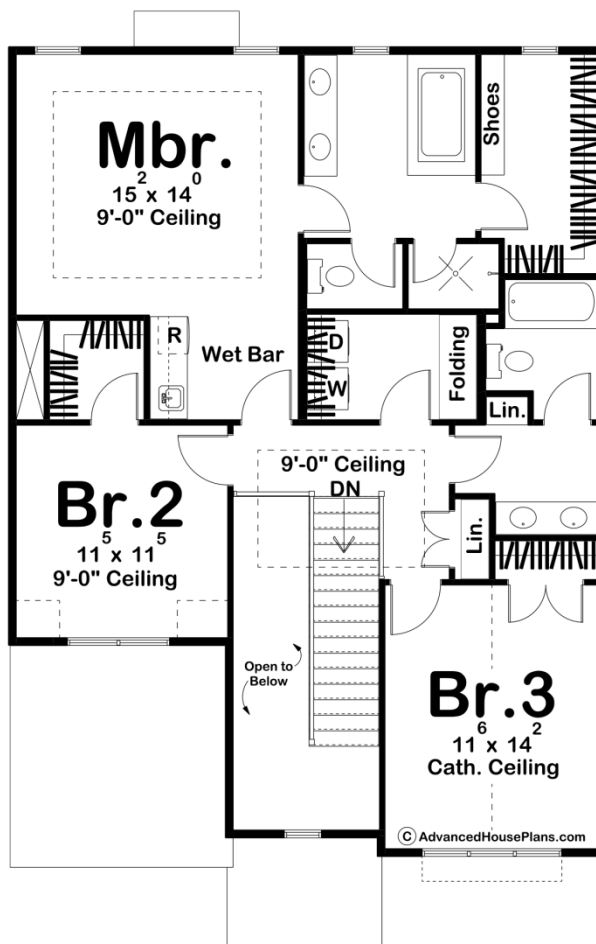

## Construction Specs

### Layout

|             |   |
|-------------|---|
| Bedrooms    | 3 |
| Bathrooms   | 3 |
| Garage Bays | 1 |

### Square Footage

|                     |              |
|---------------------|--------------|
| Main Level          | 1071 Sq. Ft. |
| Second Level        | 1106 Sq. Ft. |
| Covered Area        | 123 Sq. Ft.  |
| Garage              | 277 Sq. Ft.  |
| Total Finished Area | 2177 Sq. Ft. |

### Exterior Dimensions

|                                        |        |
|----------------------------------------|--------|
| Width                                  | 32' 0" |
| Depth                                  | 50' 4" |
| Ridge Height                           | 27' 0" |
| <i>Calculated from main floor line</i> |        |



**Default Construction Stats**  
*Stats are unique to the individual plan.*

|                            |                                     |
|----------------------------|-------------------------------------|
| Foundation Type            | Slab                                |
| Exterior Wall Construction | 2x4                                 |
| Roof Pitches               | Primary 10/12, Secondary 6/12, 4/12 |
| Main Wall Height           | 9'                                  |
| Second Wall Height         | 8'                                  |

**Plan Description**

To see this plan in duplex form, head over to our Abilene plan.      The Crandall plan is a modern farmhouse style house plan that is a perfect fit for those who want the traditional farmhouse look. The board and batten siding, gorgeous covered porch, and the mix of dark and wood accents makes this a textbook farmhouse, yet still different from all the others. This house plan is complete with a one-car garage that leads directly into a mudroom. The covered porch goes into an entryway hallway that leads the eyes straight down to the kitchen. The kitchen provides a walk-in pantry, plenty of counter space, and a kitchen island. Being open concept allows for a great space for entertaining, as the kitchen is open to the dining and great room. Head back down the hall to find a full bath, flex space, and stairs to take you upstairs. Upstairs are the additional bedrooms, laundry room, and bathrooms. Bedrooms two and three share a hallway Hollywood bath. The master suite is also found here, with an entrance that provides a wet bar and 9' ceiling. Head through the bedroom to find the bathroom, complete with double vanities, a soaking tub, separate toilet and shower areas, and a spacious walk-in closet with a built-in shelf for shoes.