

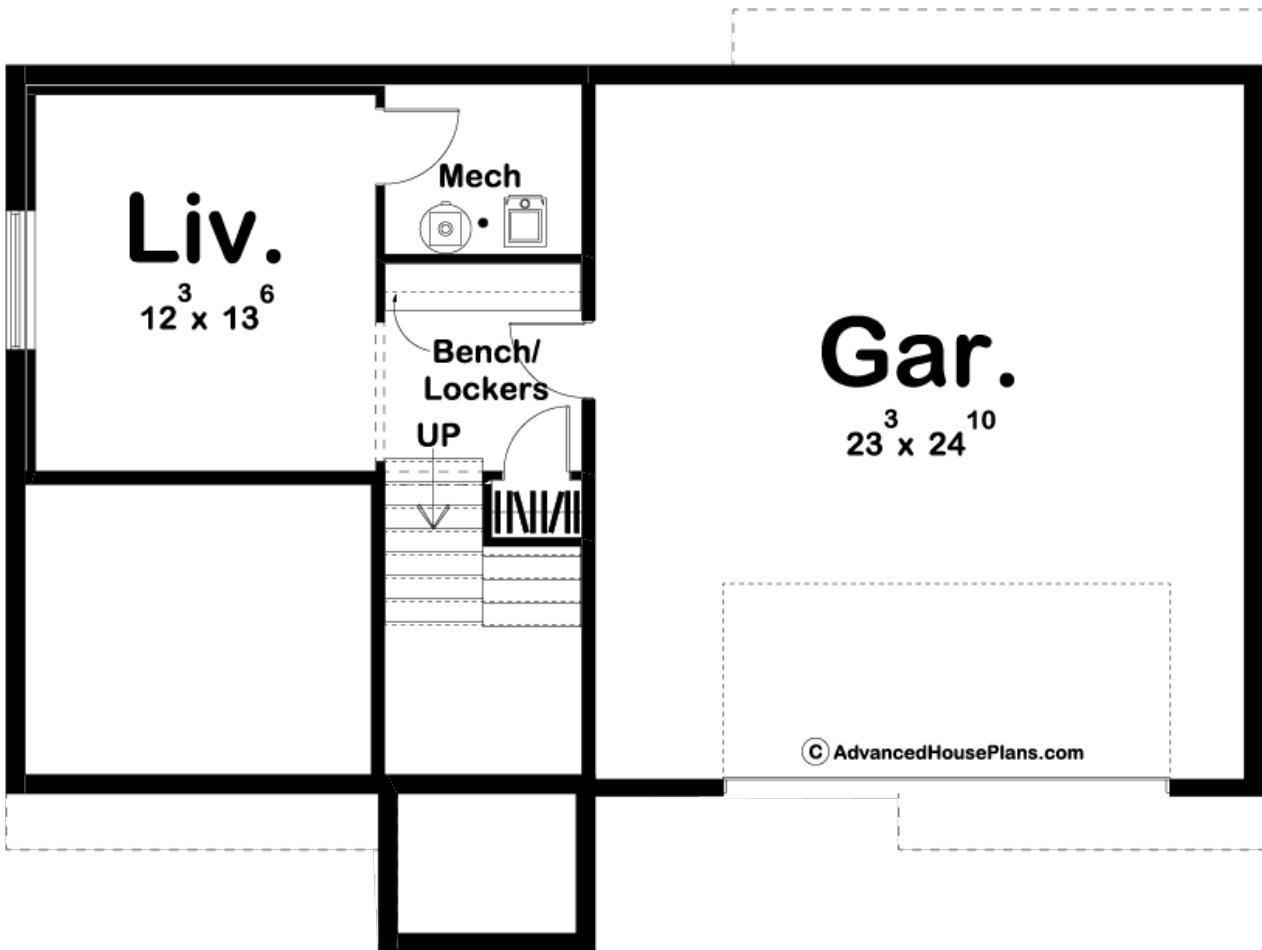

## 29691 - Creighton Data Sheet

1507 SQ FT	3 BEDS	2 BATHS	2 BAYS	45' 0" WIDE	34' 0" DEEP
---------------	-----------	------------	-----------	----------------	----------------

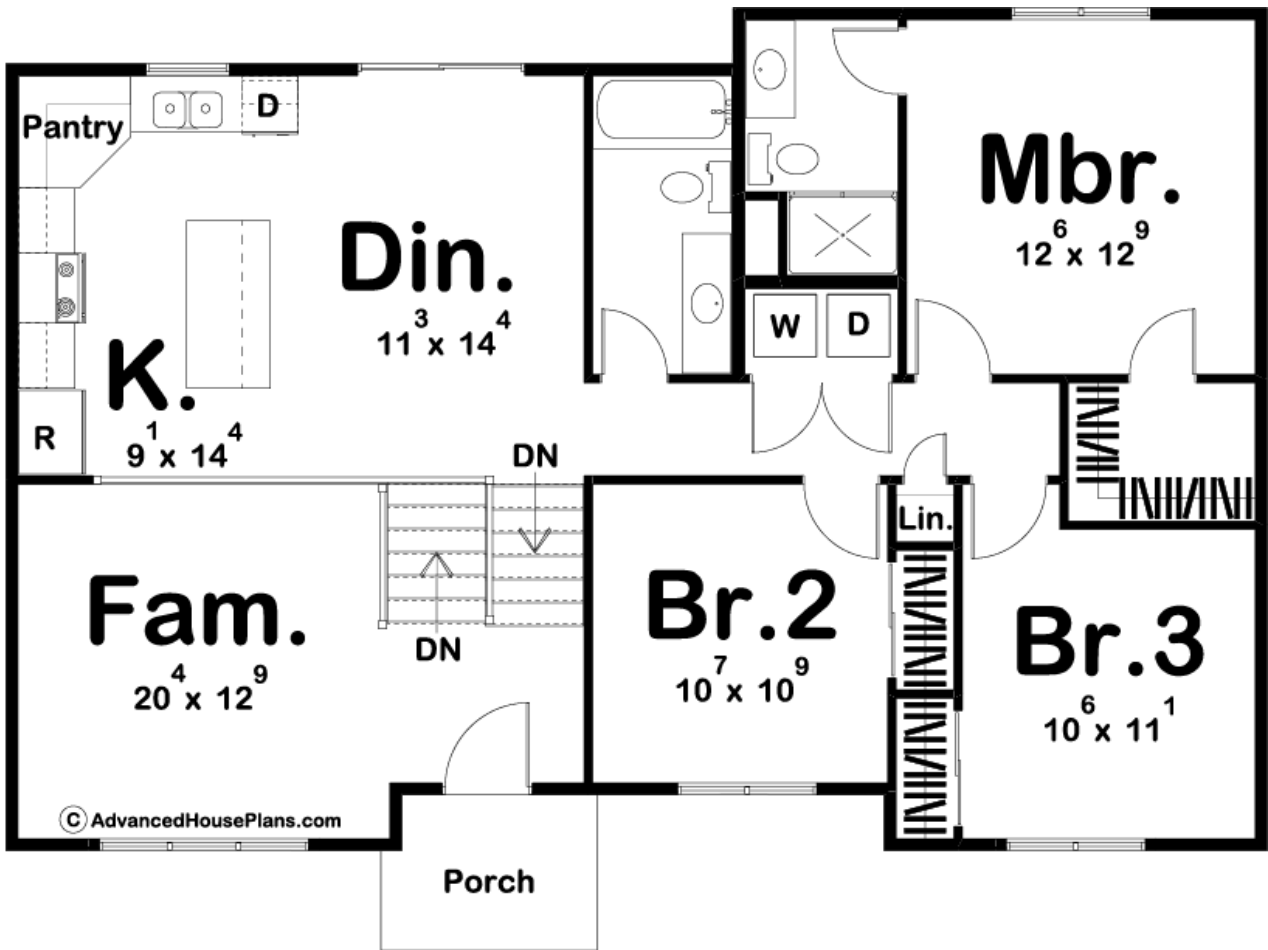



## Construction Specs

Layout	
Bedrooms	3
Bathrooms	2
Garage Bays	2
Square Footage	
Main Level	1263 Sq. Ft.
Basement Level	244 Sq. Ft.
Garage	574 Sq. Ft.
Total Finished Area	1507 Sq. Ft.
Exterior Dimensions	
Width	45' 0"
Depth	34' 0"
Ridge Height	21' 0"
<i>Calculated from main floor line</i>	

### Default Construction Stats

*Stats are unique to the individual plan.*

Foundation Type	Basement
Exterior Wall Construction	2x4
Roof Pitches	6/12 Primary, 12/12 Secondary
Foundation Wall Height	9'
Main Wall Height	9'

## Plan Description

The Creighton is a beautiful Modern Farmhouse style split-level home. This split level home has a large cathedral ceiling that makes the living area feel larger. The kitchen and dining room overlook the family room on the entry level. On the main level, you will find 3 bedrooms that are very well appointed. The master bedroom includes a walk-in closet and master bathroom. Bedrooms 2 and 3 share a centrally located hall bathroom. There is a convenient main level laundry room. On the lower level, the house is accessible from the 2 car garage through a practical mudroom with a bench and lockers. Downstairs you will also find a 2nd living area. The Creighton is a great starter home that appeals to home buyers and home builders alike due to its efficient footprint. Be sure to check out our split-level collection for more plans. As always any Advanced House Plans home plan can be customized to fit your needs with our alteration department. Whether you need to add another garage stall, change the front elevation, stretch the home larger or just make the home plan more affordable for your budget we can do that and more for you at Ahp.