

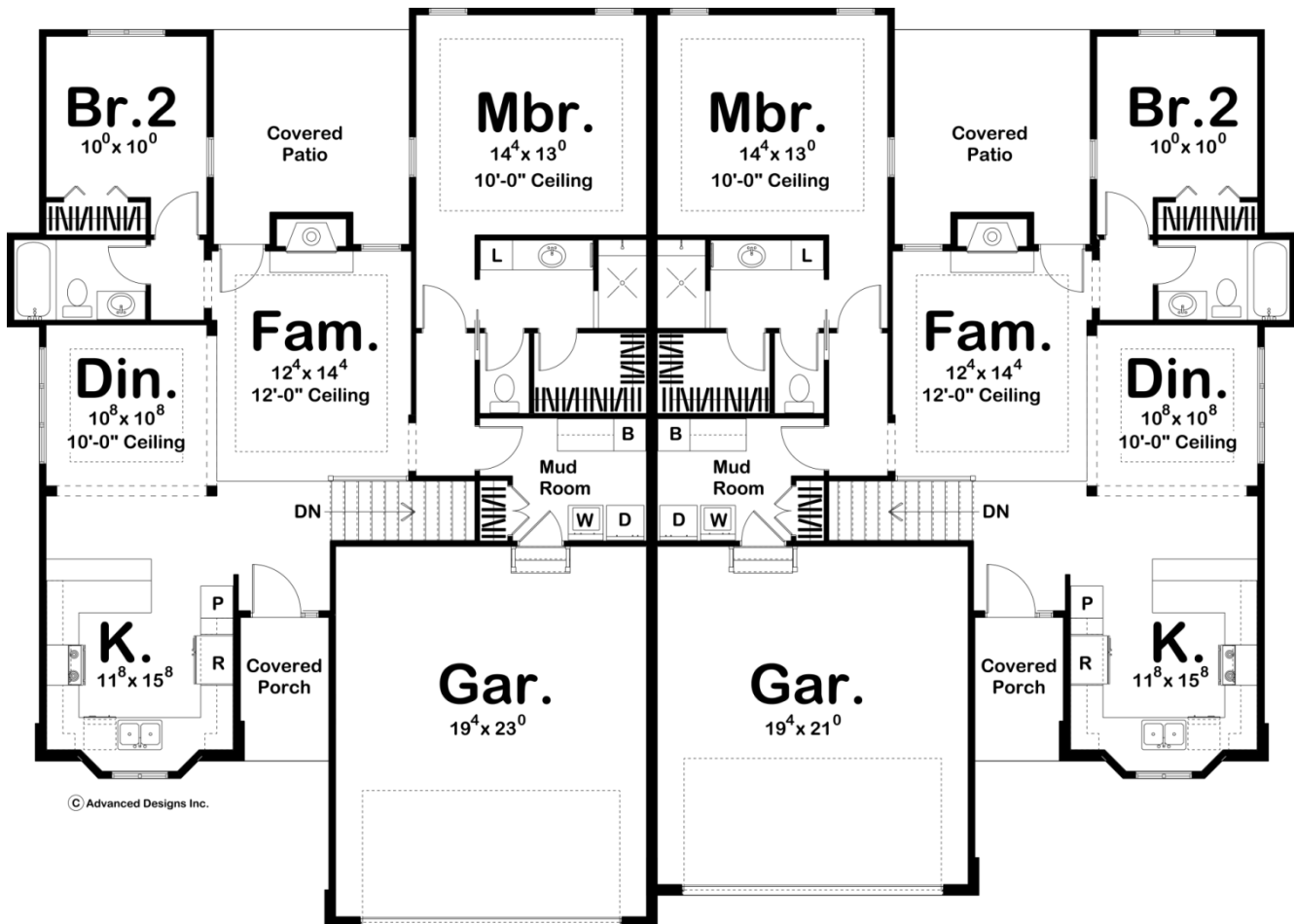

29382 - Dalton Data Sheet

1269 SQ FT	2 BEDS	2 BATHS	2 BAYS	80' 0" WIDE	57' 0" DEEP
---------------	-----------	------------	-----------	----------------	----------------



© Advanced Designs Inc.

Construction Specs

Layout

Bedrooms

Bathrooms	2
Garage Bays	2

Square Footage

Main Level	1269 Sq. Ft.
Garage	467 Sq. Ft.
Total Finished Area	1269 Sq. Ft.

Exterior Dimensions

Width	80' 0"
Depth	57' 0"
Ridge Height <i>Calculated from main floor line</i>	23' 0"

Default Construction Stats

Stats are unique to the individual plan.

Foundation Type	Basement
Exterior Wall Construction	2x4
Roof Pitches	6/12
Foundation Wall Height	9'
Main Wall Height	9'

Plan Description

A tasteful balance of brick and gables dress the front of this one-story, multi-family house plan. First views inside the Dalton extend to the family room's fireplace and the covered patio beyond. The covered patio is deep enough to easily accommodate outdoor dining, rain or shine. Just off the family room, the dining area is defined by columns and ceiling details. The adjacent kitchen features ample counter space that wraps the classic "work triangle." The master suite is separated from the living areas and features a 10-foot-high ceiling and smartly designed bath area with walk-in closet. Bedroom 2 privately resides on the opposite side of the rear covered patio and has its own bath. Clutter from the outside is intercepted in the mud room/laundry which accesses the 2-car garage. As always any Advanced House Plans home plan can be customized to fit your needs with our alteration department. Whether you need to add another garage stall, change the front elevation, stretch the home larger or just make the home plan more affordable for your budget we can do that and more for you at Ahp. Unless you purchase an unlimited use license or a multi-use license you may only build one home from a set of plans. Plans cannot be re-sold.