

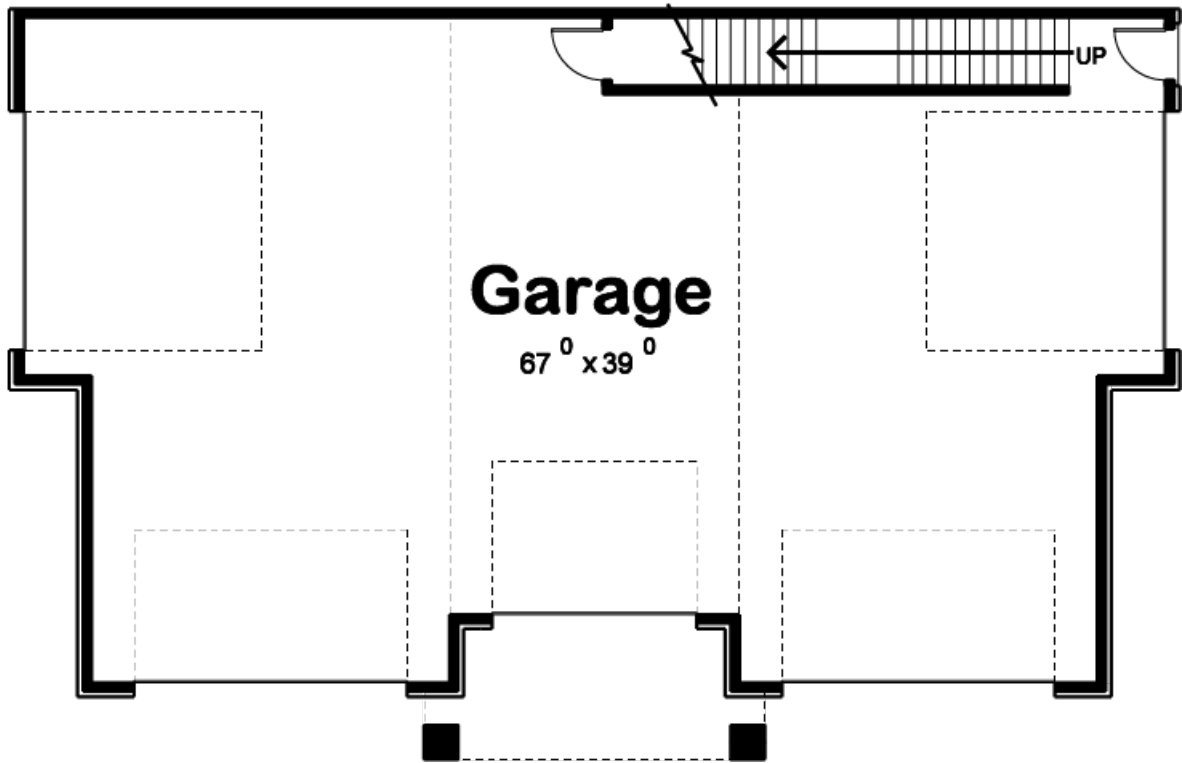

### 29187 - Drysdale Data Sheet

678 SQ FT	0 BEDS	0 BATHS	7 BAYS	68' 0" WIDE	44' 0" DEEP
--------------	-----------	------------	-----------	----------------	----------------

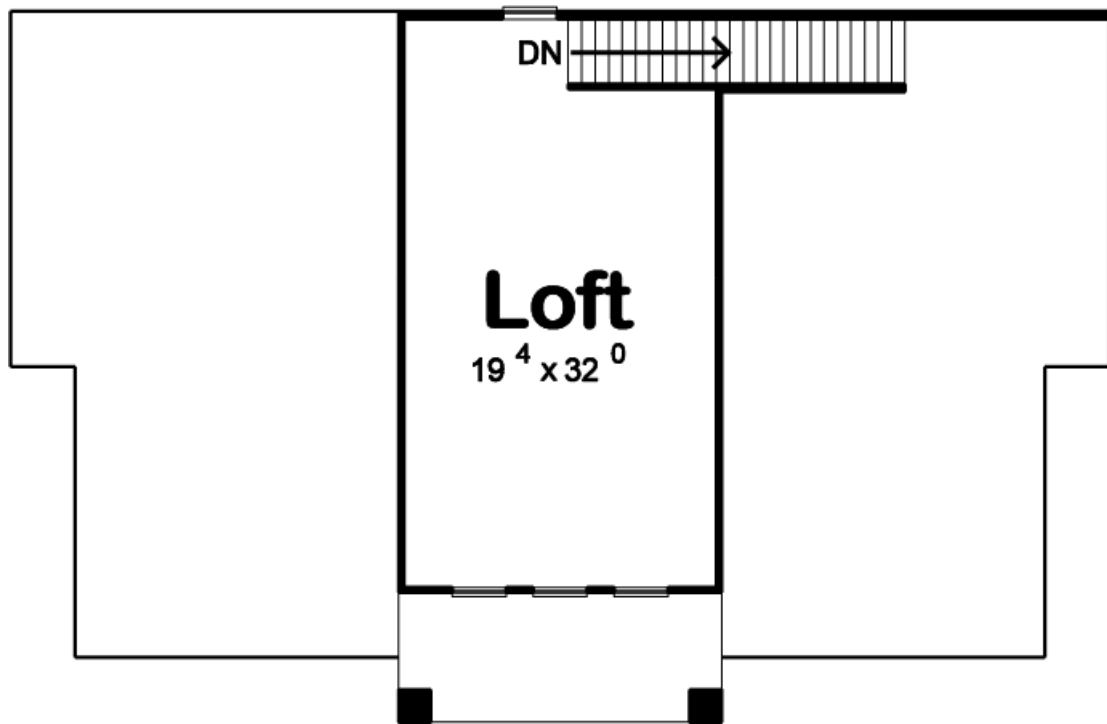



## Construction Specs

### Layout

Garage Bays 7

### Square Footage

Second Level 678 Sq. Ft.

Garage 2512 Sq. Ft.

Total Finished Area 678 Sq. Ft.

### Exterior Dimensions

Width 68' 0"

Depth 44' 0"

Ridge Height 37' 0"  
*Calculated from main floor line*

### Default Construction Stats

*Stats are unique to the individual plan.*

Foundation Type Slab

Exterior Wall Construction 2x6

Roof Pitches

8/12 Primary

Main Wall Height

8'

## Plan Description

The Drysdale is a contemporary garage with plenty of space and a sleek facade. The plan includes a second level perfect for a workshop or studio. This front and side load garage can fit up to 7 cars.