

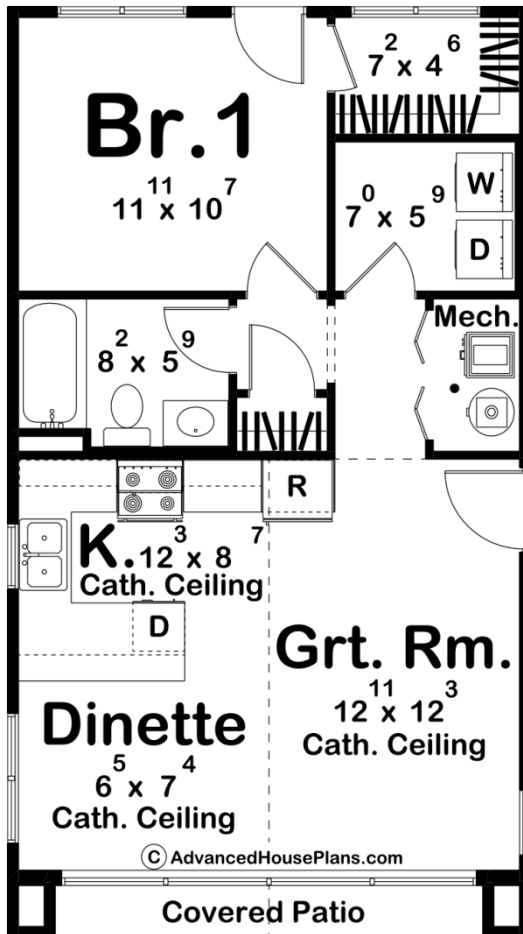

30546 - Durango Data Sheet

654 SQ FT	1 BEDS	1 BATHS	0 BAYS	20' 0" WIDE	35' 8" DEEP
--------------	-----------	------------	-----------	----------------	----------------



Construction Specs

Layout

Bedrooms

Square Footage

Main Level	654 Sq. Ft.
Total Finished Area	654 Sq. Ft.

Exterior Dimensions

Width	20' 0"
Depth	35' 8"
Ridge Height <i>Calculated from main floor line</i>	20' 0"

Default Construction Stats

Stats are unique to the individual plan.

Foundation Type	Slab
Exterior Wall Construction	2x4
Roof Pitches	Primary 12/12
Main Wall Height	9'

Plan Description

Imagine transforming your backyard or property with the Durango, a modern ADU house plan featuring one bedroom, one bathroom, and an open concept main area. This isn't just an addition to your property; it's a versatile, stylish, and highly functional space that offers endless possibilities. The beauty of this ADU lies in its design efficiency and aesthetic appeal. The open concept main area creates a seamless flow between the living, dining, and kitchen spaces, making it perfect for entertaining or simply enjoying a spacious, airy living environment. The cathedral ceiling adds a touch of elegance and grandeur, enhancing the sense of space and filling the home with natural light. Whether you're looking to accommodate guests, generate rental income, or create a private retreat, this ADU is the ideal solution. The single bedroom and bathroom layout is perfect for individuals or couples, offering a cozy living space that is easy to maintain. Investing in this modern ADU house plan means adding significant value to your property while enjoying the benefits of a beautifully designed, functional space. Don't miss out on the opportunity to enhance your living experience and elevate your property with this exceptional ADU design.