

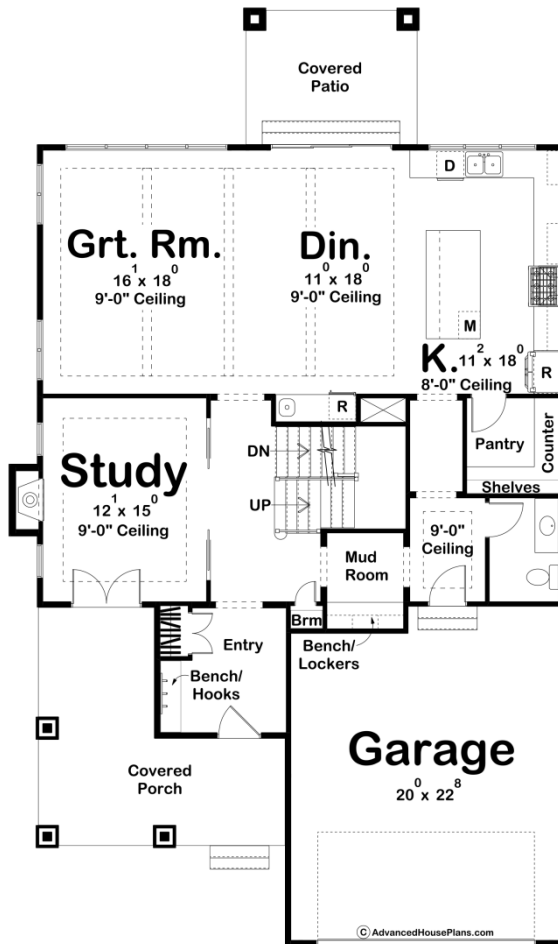

29383 - Eastland Data Sheet

3008 SQ FT	4 BEDS	4 BATHS	2 BAYS	41' 0" WIDE	69' 0" DEEP
---------------	-----------	------------	-----------	----------------	----------------

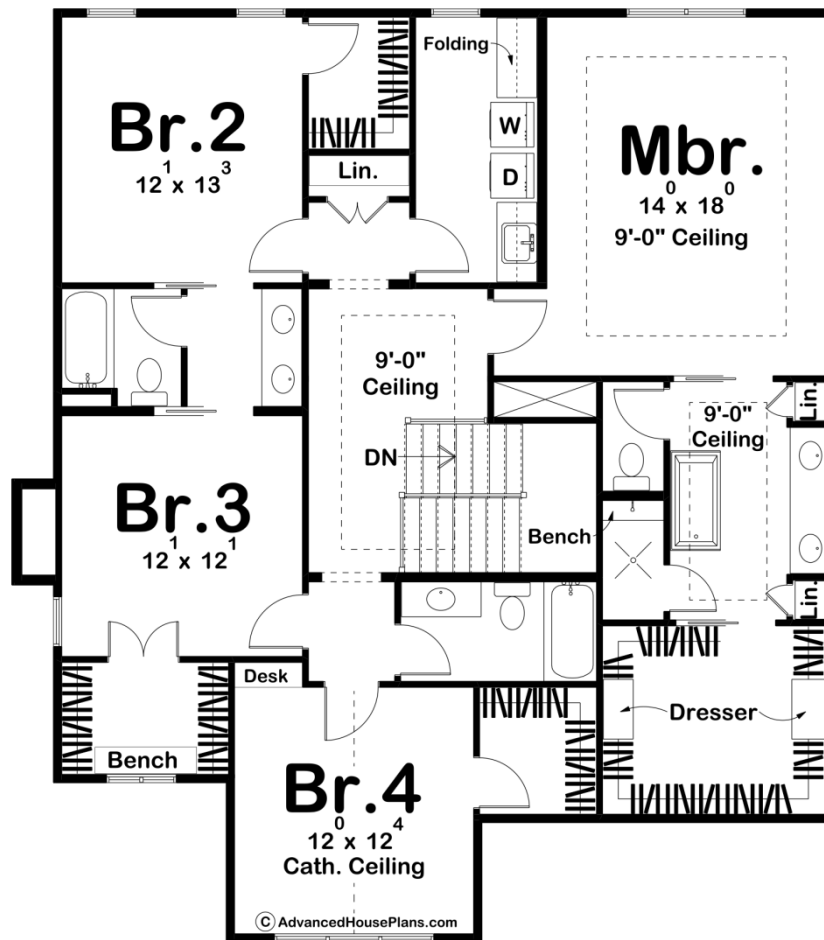



Construction Specs

Layout

Bedrooms	4
Bathrooms	4
Garage Bays	2

Square Footage

Main Level	1444 Sq. Ft.
Second Level	1564 Sq. Ft.
Covered Area	357 Sq. Ft.
Garage	496 Sq. Ft.
Total Finished Area	3008 Sq. Ft.

Exterior Dimensions

Width	41' 0"
Depth	69' 0"
Ridge Height	35' 0"
<i>Calculated from main floor line</i>	

Default Construction Stats

Stats are unique to the individual plan.

Foundation Type	Basement
Exterior Wall Construction	2x4
Roof Pitches	Primary 10/12, Secondary 12/12, 4/12, 6/12
Foundation Wall Height	9'
Main Wall Height	9'
Second Wall Height	8'

Plan Description

This cottage style house plan is a spacious 3,008 square foot home with 4 bedrooms and 4 bathrooms. The exterior of the home is charming, with a pitched roof, gables, and a covered front porch. The interior is open and welcoming, with a hallway that leads you directly into a private study, or into the spacious great room that is perfect for entertaining or family gatherings. The kitchen is a cook's dream, with plenty of counter space and storage, as well as a large center island and walk-in pantry. Head up the stairs to find all the bedrooms, the master suite being a true retreat, with a private bathroom and large walk-in closet. The other bedrooms are generously sized and have plenty of closet space. This house plan also includes a laundry room and a covered rear patio. With its charming cottage style and spacious layout, this house plan is perfect for a growing family.