

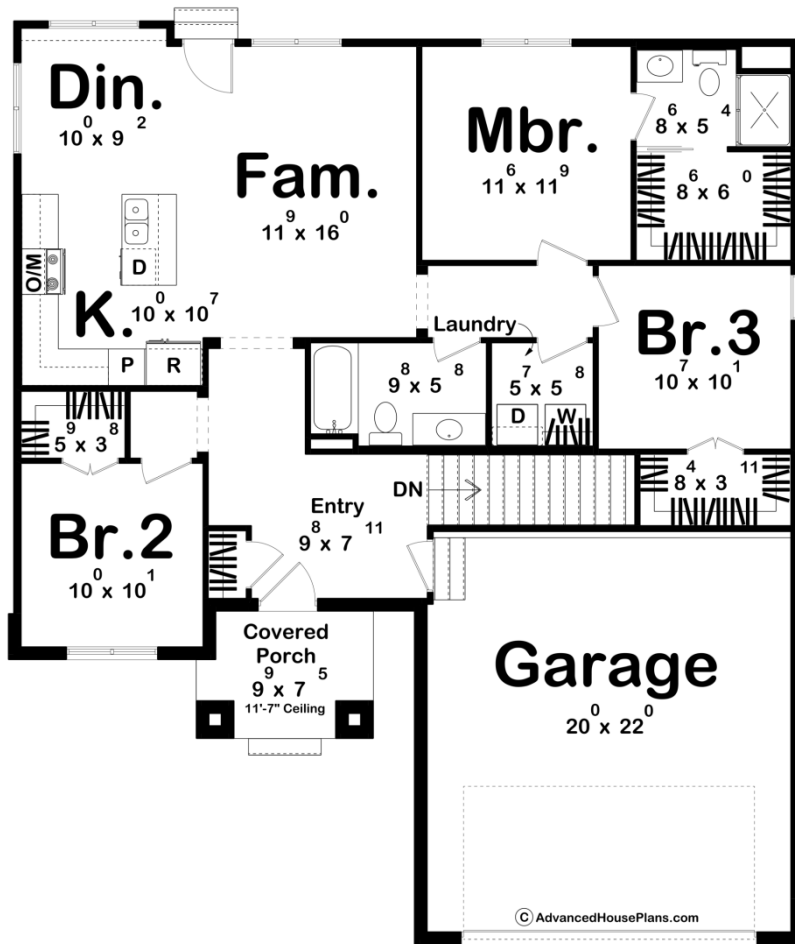

29708 - Elk Park Data Sheet

1290 SQ FT	3 BEDS	2 BATHS	2 BAYS	43' 0" WIDE	50' 4" DEEP
---------------	-----------	------------	-----------	----------------	----------------



Construction Specs

Layout

Bedrooms

Bathrooms	2
Garage Bays	2
Square Footage	
Main Level	1290 Sq. Ft.
Garage	459 Sq. Ft.
Total Finished Area	1290 Sq. Ft.
Exterior Dimensions	
Width	43' 0"
Depth	50' 4"
Default Construction Stats	
<i>Stats are unique to the individual plan.</i>	
Foundation Type	Basement
Exterior Wall Construction	2x4
Roof Pitches	4/12 Primary
Foundation Wall Height	9'
Main Wall Height	9'

Plan Description

Welcome to Elk Park—a perfect blend of modern style and cozy living! This 1,290 sq. ft. one-story home greets you with a covered porch featuring brick columns and warm wood accents. Inside, an oversized entry sets the tone for a home that feels anything but small. The kitchen shines with generous counter space, a functional island with a breakfast bar, and a walk-up pantry. The private master suite offers a relaxing retreat with its own walk-in closet and bath. Bedrooms 2 and 3 each include walk-in closets, giving everyone their own organized space. Elk Park is proof that great design comes in every size!