

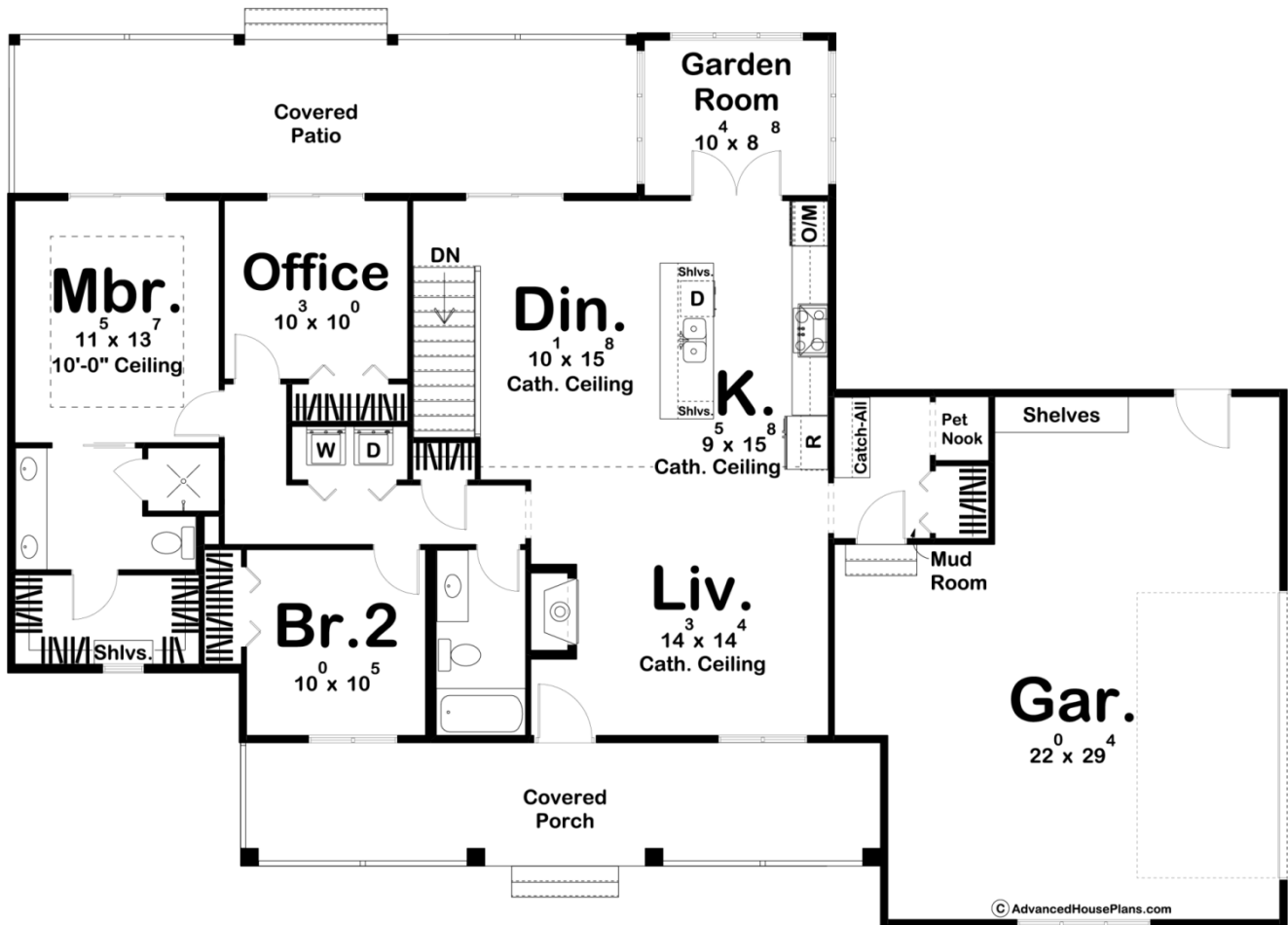

29956 - Elowen Data Sheet

1542 SQ FT	2 BEDS	2 BATHS	2 BAYS	66' 0" WIDE	46' 0" DEEP
---------------	-----------	------------	-----------	----------------	----------------



Construction Specs

Layout

Bedrooms

Bathrooms	2
-----------	---

Garage Bays	2
-------------	---

Square Footage

Main Level	1542 Sq. Ft.
------------	--------------

Garage	587 Sq. Ft.
--------	-------------

Total Finished Area	1542 Sq. Ft.
---------------------	--------------

Exterior Dimensions

Width	66' 0"
-------	--------

Depth	46' 0"
-------	--------

Ridge Height	20' 0"
--------------	--------

Calculated from main floor line

Default Construction Stats

Stats are unique to the individual plan.

Foundation Type	Basement
-----------------	----------

Exterior Wall Construction	2x4
----------------------------	-----

Roof Pitches	8/12 Primary, 4/12 Secondary
--------------	------------------------------

Foundation Wall Height	9'
------------------------	----

Main Wall Height	9'
------------------	----

Plan Description

The Elowen plan is an elegant Craftsman style ranch house plan. The exterior is highlighted by a side-load garage and a large covered porch. Just inside the home, the living room, kitchen, and dining room flow seamlessly in an open layout and lie under a soaring cathedral ceiling. The living room is warmed by a cozy fireplace. The kitchen includes an island with built-in shelving and a snack bar. Just off the kitchen, you'll find a relaxing garden room. The master suite includes his/her vanities, a walk-in shower, and a walk-in closet with built-in shelving. Just outside the master suite is a practical home office that could be used as a 3rd bedroom. The 2 car side load garage accesses the home through a convenient mudroom that includes a coat closet, catch-all, and a pet nook.