

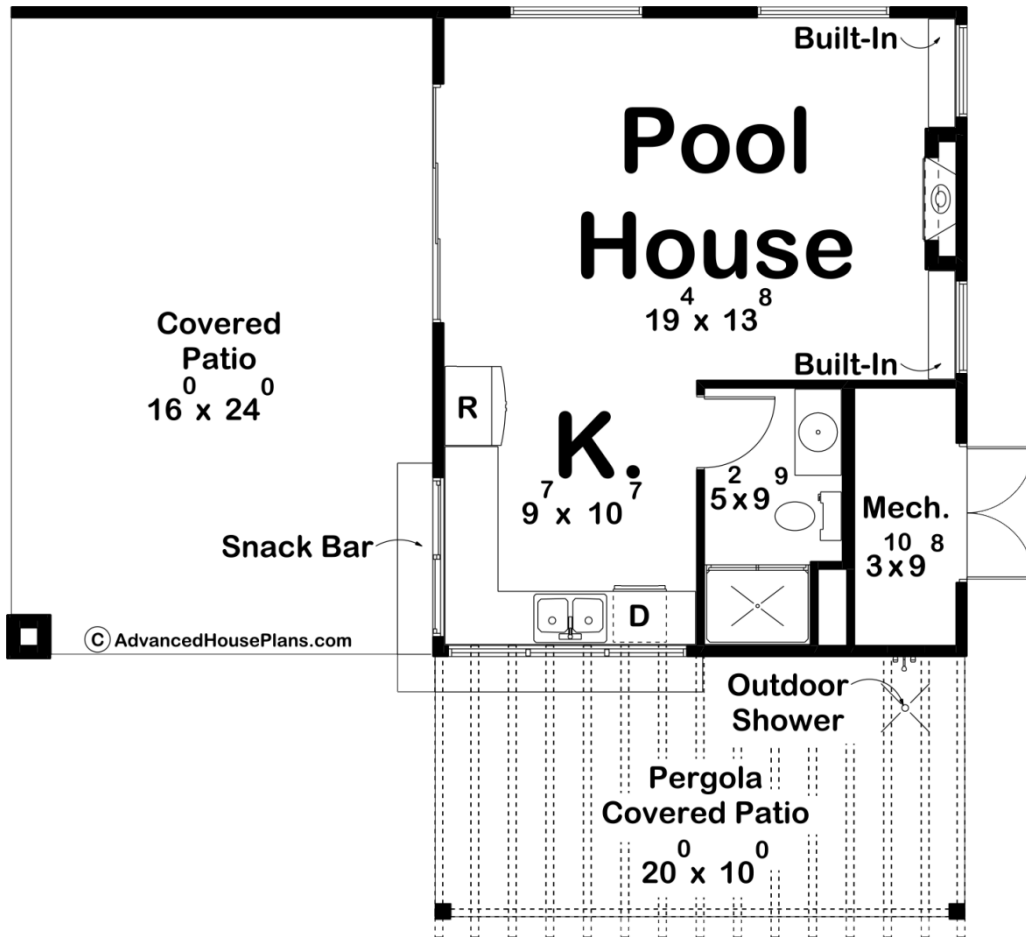

30412 - Ember Way Data Sheet

449 SQ FT	0 BEDS	1 BATHS	0 BAYS	36' 0" WIDE	34' 4" DEEP
--------------	-----------	------------	-----------	----------------	----------------



Construction Specs

Layout

Bathrooms

Square Footage

Main Level	449 Sq. Ft.
Covered Area	589 Sq. Ft.
Total Finished Area	449 Sq. Ft.

Exterior Dimensions

Width	36' 0"
Depth	34' 4"
Ridge Height <i>Calculated from main floor line</i>	11' 1"

Default Construction Stats

Stats are unique to the individual plan.

Foundation Type	Slab
Exterior Wall Construction	2x4
Roof Pitches	Flat
Main Wall Height	10'

Plan Description

Nestled in the backyard of your dream residence, the modern-style pool house is a sanctuary of relaxation and entertainment. This sleek architectural gem seamlessly integrates with the surrounding landscape, offering a perfect blend of form and function. The pool house exterior is a symphony of clean lines and flat roofs. A snack bar is featured below an inviting pergola, making it great for entertaining guests as it is easily accessible from the inside kitchen. The large, open covered patio is an invitation to the inside of the ADU unit. Stepping inside this modern pool house, you are greeted by a large open space that is great for hosting. Whether it be furnished with a sofa, dining table, or relaxing chairs, this space is superb for unwinding from a pool day. In addition to the open space, a kitchen, bathroom and space for pool storage are included in this unit to accommodate to your ideal pool house essentials. This modern pool house is a retreat designed for leisure, socializing, and enjoying the beauty of outdoor living in contemporary style. Whether sipping a refreshing drink at the snack bar, lounging on the covered patio, or dining under the pergola, every corner of this space is an invitation to unwind and make lasting memories.