

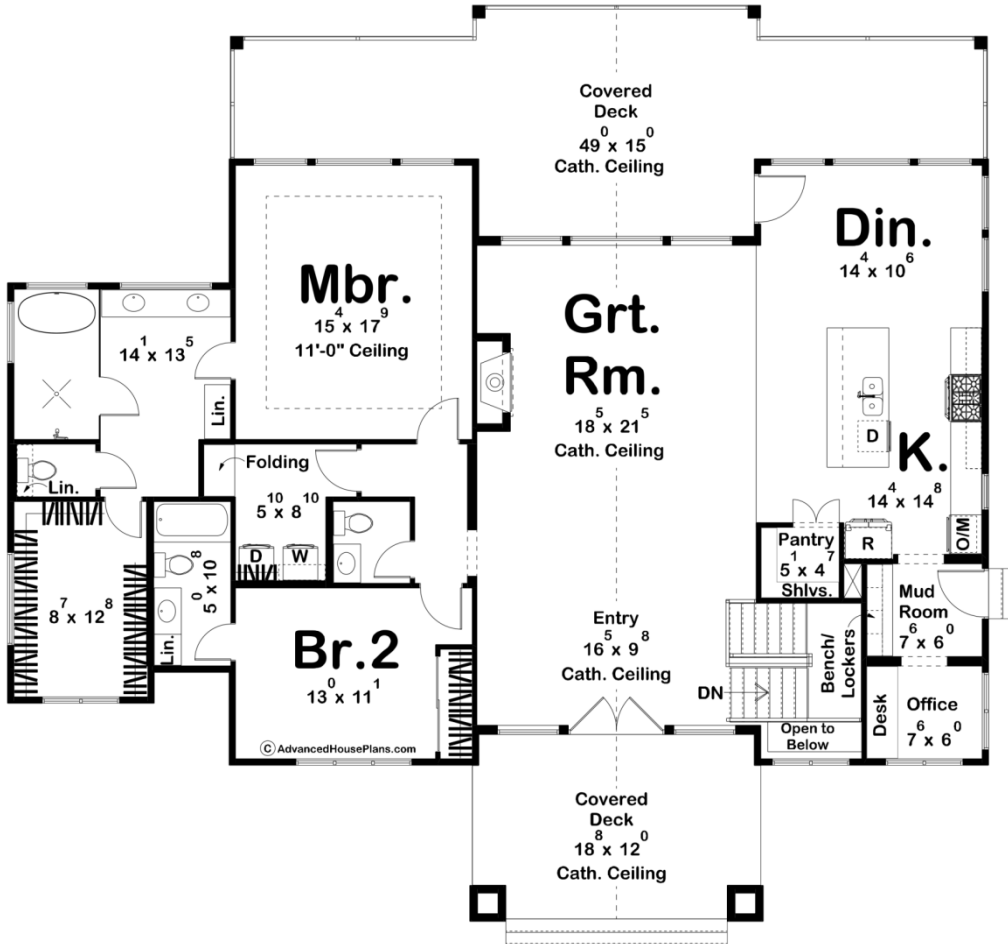

30344 - Emerald Shores Data Sheet

2136 SQ FT	2 BEDS	3 BATHS	0 BAYS	63' 4" WIDE	59' 0" DEEP
---------------	-----------	------------	-----------	----------------	----------------

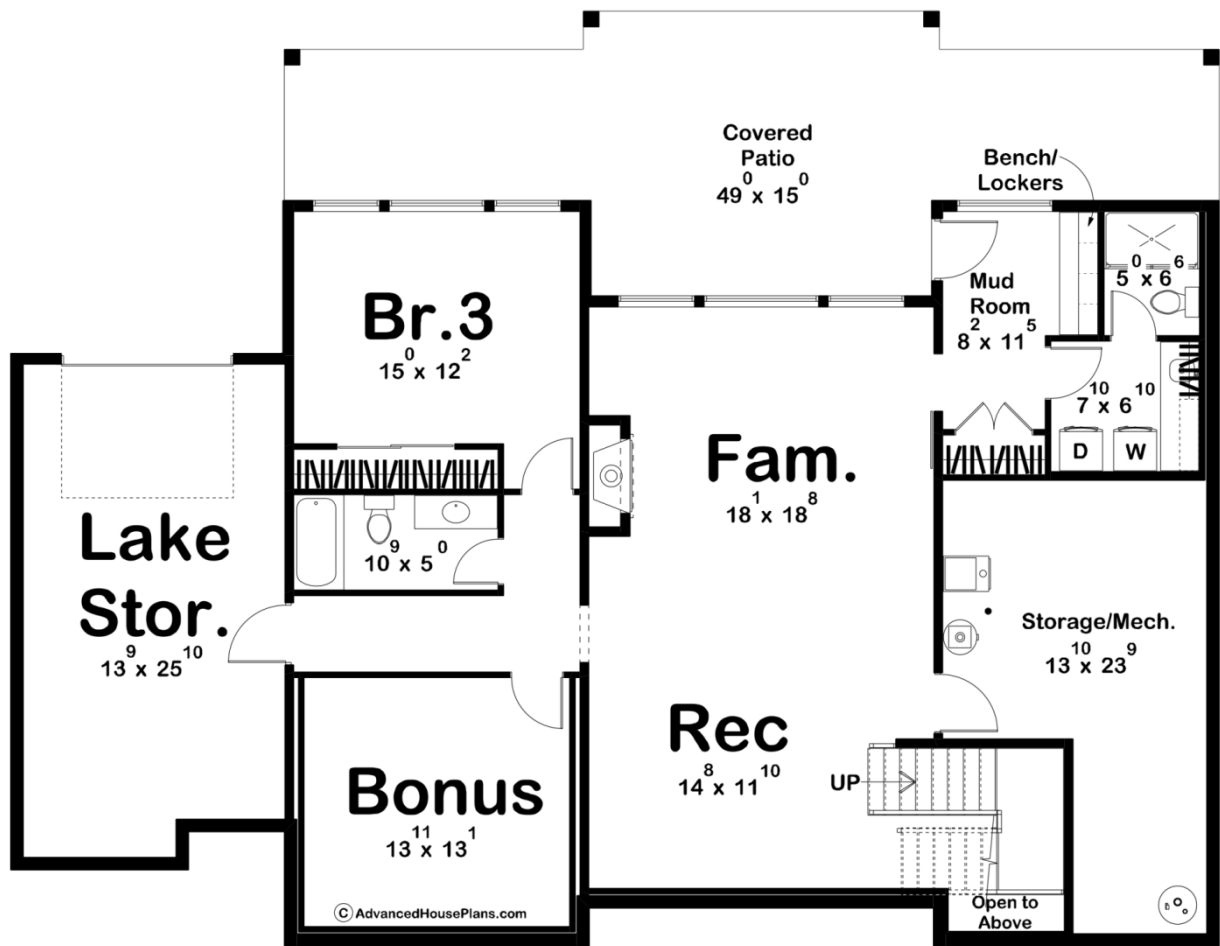



Construction Specs

Layout

Bedrooms	2
Bathrooms	3

Square Footage

Main Level	2136 Sq. Ft.
Covered Area	735 Sq. Ft.
Total Finished Area	2136 Sq. Ft.

Exterior Dimensions

Width	63' 4"
Depth	59' 0"
Ridge Height <i>Calculated from main floor line</i>	21' 10"

Default Construction Stats

Stats are unique to the individual plan.

Foundation Type	Walkout
-----------------	---------

Exterior Wall Construction	2x4
Roof Pitches	Primary 10/12, Secondary 8/12, 6/12/ 3/12
Foundation Wall Height	9'
Main Wall Height	10'

Plan Description

Imagine stepping into your dream home, where every detail has been meticulously designed to elevate your living experience. As you approach the entrance, you're greeted by a grandeur facade, adorned with large windows that invite natural light to flood the spacious entryway. Upon entering, you're immediately drawn to the breathtaking great room, where soaring ceilings and expansive windows create a sense of openness and tranquility. The great room seamlessly flows into the kitchen and dining area, forming the heart of the home—a perfect space for entertaining guests or enjoying cozy family dinners. Adjacent to the dining area lies a large covered deck, providing the ideal setting for al fresco dining or simply relaxing while enjoying the serene views of your surroundings. Retreat to the luxurious master bedroom, where comfort meets elegance. Boasting ample space and adorned with large windows, it's a serene sanctuary that offers the perfect escape from the hustle and bustle of everyday life. The attached master bathroom is a spa-like oasis, complete with modern amenities and a spacious walk-in closet for all your storage needs. The second bedroom, also generously sized, comes with its own attached bathroom, offering privacy and convenience for guests or family members. Descend into the finished basement, where 1389 sq ft. awaits. Whether you're unwinding in the cozy family room, hosting game nights in the rec room, or utilizing the bonus room as a home office or gym, there's no shortage of space for all your needs. Additionally, the third bedroom provides comfortable accommodation for guests, while the additional mudroom and laundry area offer practicality and convenience. This house plan is more than just a home—it's a sanctuary where every detail has been carefully crafted to enhance your lifestyle. With its thoughtful design, spacious layout, and abundance of natural light, it's the perfect place to create lasting memories with loved ones for years to come.