

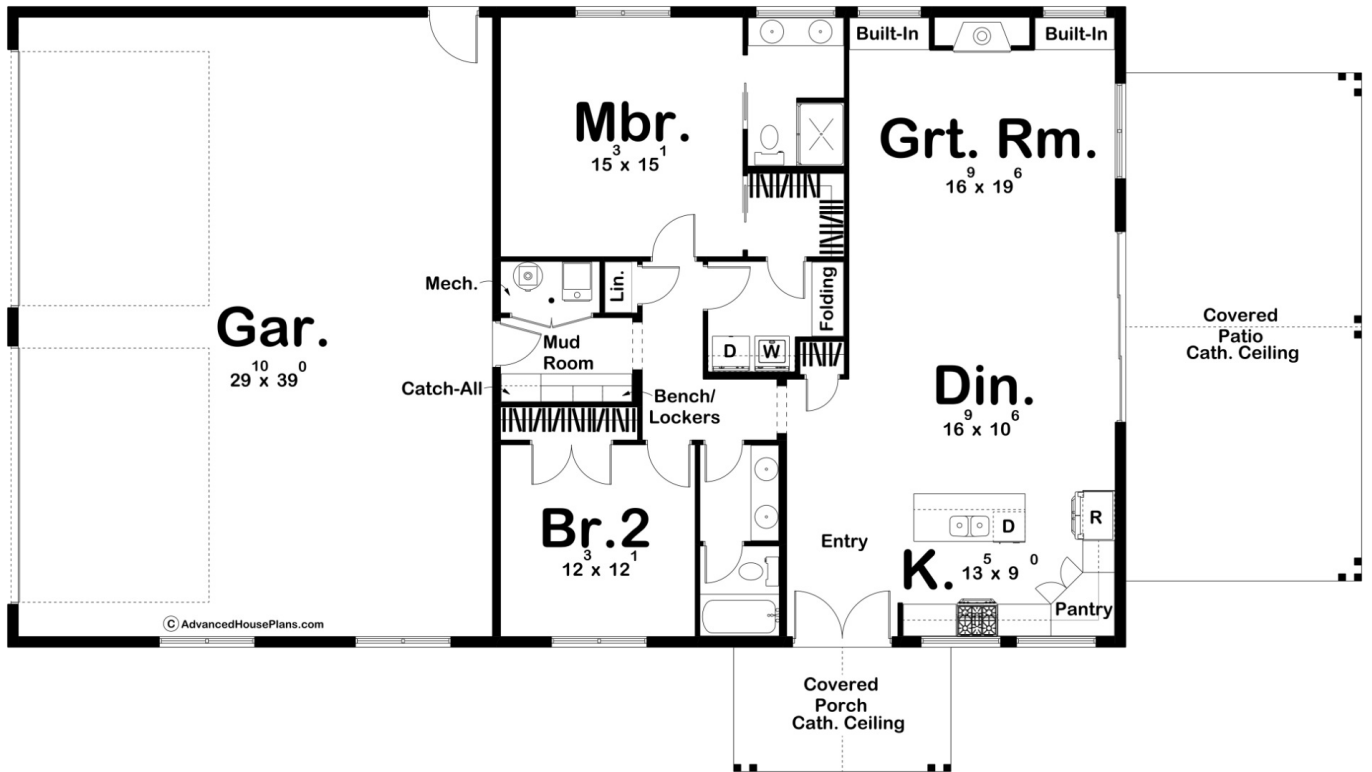

30205 - Evansville Data Sheet

1587 SQ FT	2 BEDS	2 BATHS	2 BAYS	85' 0" WIDE	48' 0" DEEP
---------------	-----------	------------	-----------	----------------	----------------



Construction Specs

Layout

Bedrooms

Bathrooms	2
Garage Bays	2
Square Footage	
Main Level	1587 Sq. Ft.
Covered Area	589 Sq. Ft.
Garage	1213 Sq. Ft.
Total Finished Area	1587 Sq. Ft.
Exterior Dimensions	
Width	85' 0"
Depth	48' 0"
Ridge Height <i>Calculated from main floor line</i>	24' 7"
Default Construction Stats <i>Stats are unique to the individual plan.</i>	
Foundation Type	Slab
Exterior Wall Construction	2x6
Roof Pitches	6/12 Primary
Main Wall Height	14'

Plan Description

This new barndominium plan is not only efficient, but also affordable. With the plan being 1587 square feet, it is the perfect size for a small family, couple, or even one who wants the additional space without there being too much to deal with. As soon as you walk up to the Evansville plan, you are greeted with a covered patio and cathedral ceilings. Step inside to see a large space for the kitchen, great room, and dining room, an open floor plan that allows the space to feel much bigger than it is. As you continue throughout the plan, you can find a mud room, as well as two bedrooms, the master including a walk-in closet with access to the laundry room. Both bathrooms also have double vanities, which makes this space great for having guests over and remaining close without becoming claustrophobic. The backyard also includes a covered porch for enjoying the views and relaxing after a long day. This plan is great for those who want the barndominium style while staying on budget.