

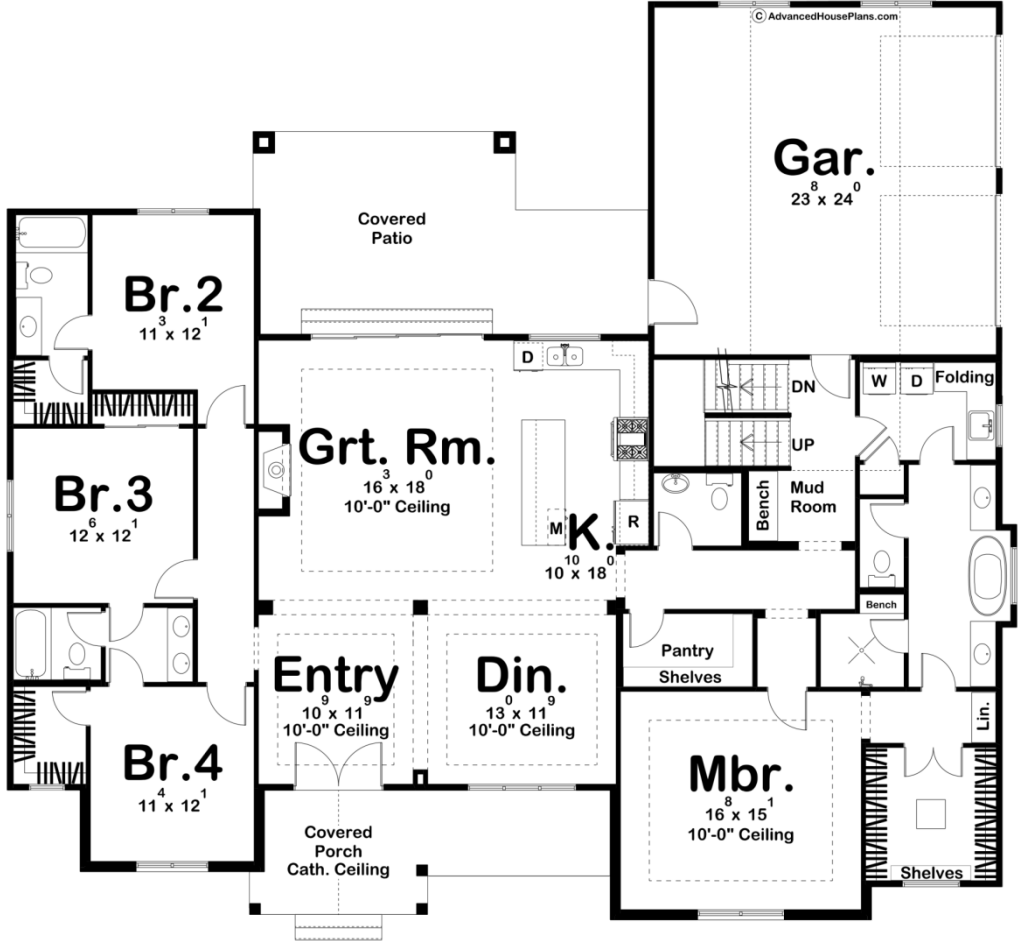

30222 - Fairview Data Sheet

2553 SQ FT	4 BEDS	4 BATHS	2 BAYS	69' 8" WIDE	63' 0" DEEP
---------------	-----------	------------	-----------	----------------	----------------

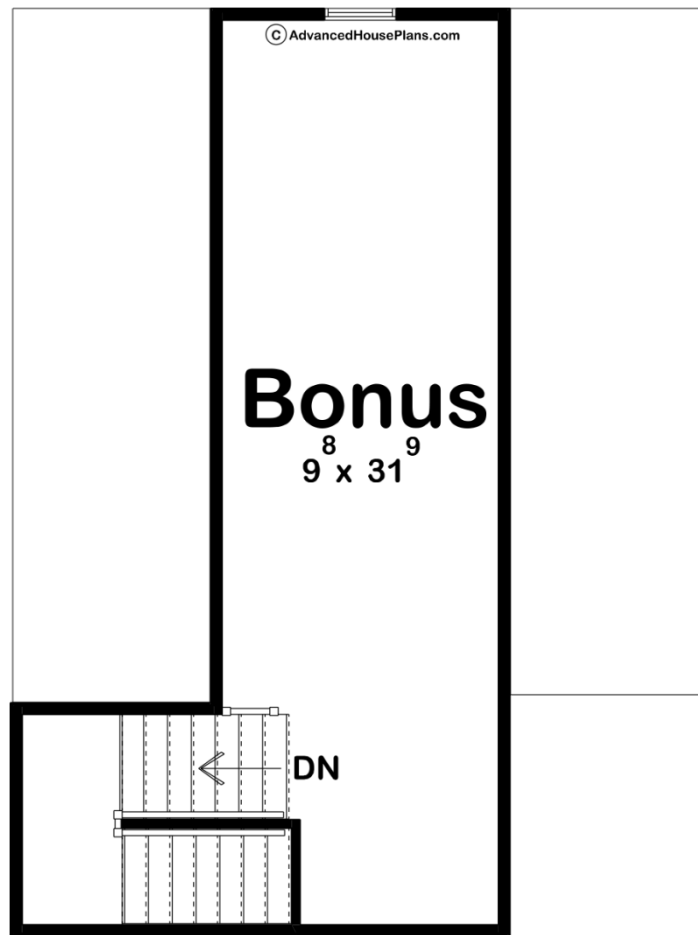



Construction Specs

Layout

Bedrooms	4
Bathrooms	4
Garage Bays	2

Square Footage

Main Level	2553 Sq. Ft.
Covered Area	511 Sq. Ft.
Garage	592 Sq. Ft.
Total Finished Area	2553 Sq. Ft.

Exterior Dimensions

Width	69' 8"
Depth	63' 0"
Ridge Height	23' 1"
<i>Calculated from main floor line</i>	

Default Construction Stats
Stats are unique to the individual plan.

Foundation Type	Basement
Exterior Wall Construction	2x4
Roof Pitches	Primary 8/12, Secondary 12/12
Foundation Wall Height	9'
Main Wall Height	9'

Plan Description

The Fairview plan is a beautiful modern farmhouse that has a gorgeous curb appeal combining board, batten and brick in a wonderful way. Walking into the home via the covered cathedral ceiling porch, you are greeted by a spacious entryway and main living area with 10 foot ceilings. Pillars in between each room help divide the space while maintaining the open floor plan. The kitchen has a large island with a breakfast bar, as well as a walk-in pantry just off to the side. Also in the same space is the great room with a built-in fireplace, and access to a covered patio. Each side of the house has bedrooms, the left being the additional 3 bedrooms with two baths, and the right side being the master suite. The master includes a very large walk-in closet and bathroom, complete with separate shower and toilet areas, a soaking tub, and double vanities. The suite had access to the laundry room, which also leads to the two-car garage and mudroom. A case of stairs are also found in this area, which head upstairs to an unfinished bonus room that provides 391 extra square feet.