

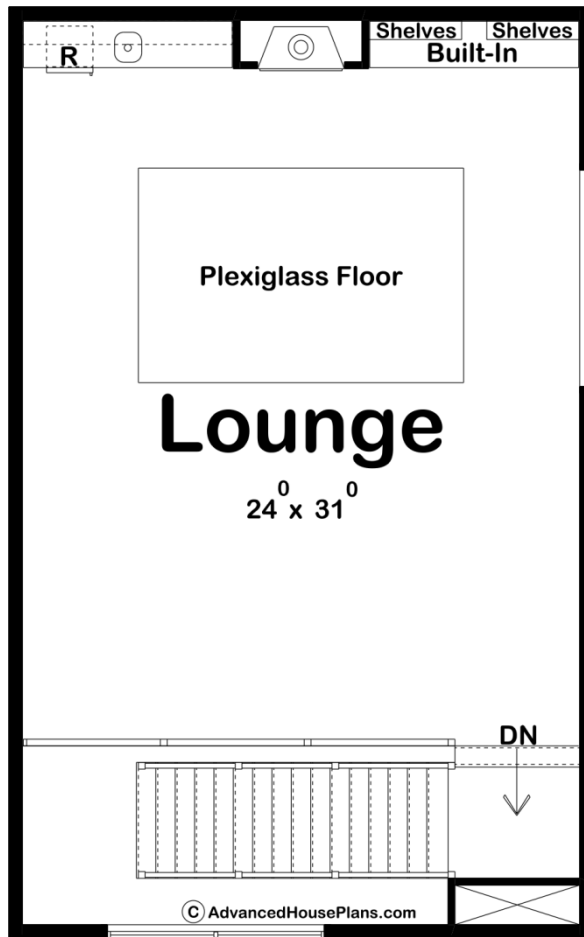

30228 - Falls Canyon Data Sheet

835 SQ FT	0 BEDS	1 BATHS	7 BAYS	90' 0" WIDE	40' 0" DEEP
--------------	-----------	------------	-----------	----------------	----------------





Construction Specs

Layout

Bathrooms	1
Garage Bays	7

Square Footage

Second Level	795 Sq. Ft.
Basement Level	40 Sq. Ft.
Garage	2946 Sq. Ft.
Total Finished Area	835 Sq. Ft.

Exterior Dimensions

Width	90' 0"
Depth	40' 0"
Ridge Height <i>Calculated from main floor line</i>	26' 6"

Default Construction Stats

Stats are unique to the individual plan.

Foundation Type	Slab
Exterior Wall Construction	2x6
Roof Pitches	2/12 Primary
Main Wall Height	10'
Second Wall Height	10'

Plan Description

The Falls Canyon is a stunning 7-car garage with a shop and lounge area. It is every car-lovers dream. The modern details scream luxury from the outside to the inside. Inside is space to show off many of your favorite cars. There is a shop area to store all of your tools as well. The main floor includes a bath, a mechanical room, and a storage room. Heading upstairs is a large lounge area equipped with a fireplace and a plexiglass floor so you can look down and see your vehicle in the 7th bay.