

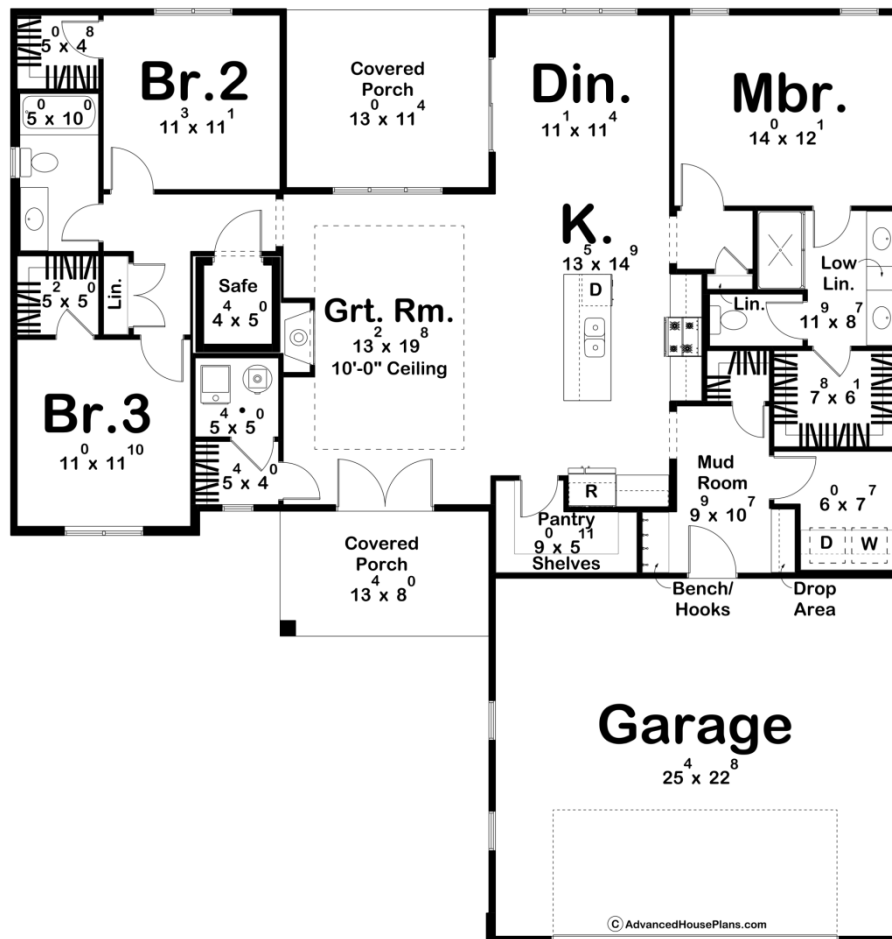

30536 - Fieldstone Data Sheet

1704 SQ FT	3 BEDS	2 BATHS	2 BAYS	56' 4" WIDE	59' 0" DEEP
---------------	-----------	------------	-----------	----------------	----------------



Construction Specs

Layout

Bedrooms

Bathrooms	2
Garage Bays	2
Square Footage	
Main Level	1704 Sq. Ft.
Covered Area	310 Sq. Ft.
Garage	598 Sq. Ft.
Total Finished Area	1704 Sq. Ft.
Exterior Dimensions	
Width	56' 4"
Depth	59' 0"
Ridge Height <i>Calculated from main floor line</i>	18' 2"
Default Construction Stats <i>Stats are unique to the individual plan.</i>	
Foundation Type	Slab
Exterior Wall Construction	2x4
Roof Pitches	Primary 6/12, Secondary 3.75/12
Main Wall Height	9'

Plan Description

Introducing the Fieldstone, this charming 3-bedroom, 2-bathroom traditional-style house plan offers a perfect blend of comfort and functionality. The home features a welcoming front covered porch, ideal for relaxing and enjoying the outdoors. Step inside to the open-concept living space that seamlessly combines the living room, dining area, and kitchen, making it perfect for entertaining or family gatherings. The spacious master suite offers a peaceful retreat with a luxurious en-suite bathroom, complete with a double vanity, a walk-in shower, and ample storage space. The other two bedrooms are well-sized and include walk-in closets, providing plenty of storage and convenience. At the rear of the home, you'll find a covered porch that's perfect for outdoor dining or lounging, extending the living space outdoors. With its thoughtful layout, modern amenities, and timeless traditional style, this home plan is designed for comfortable everyday living.