

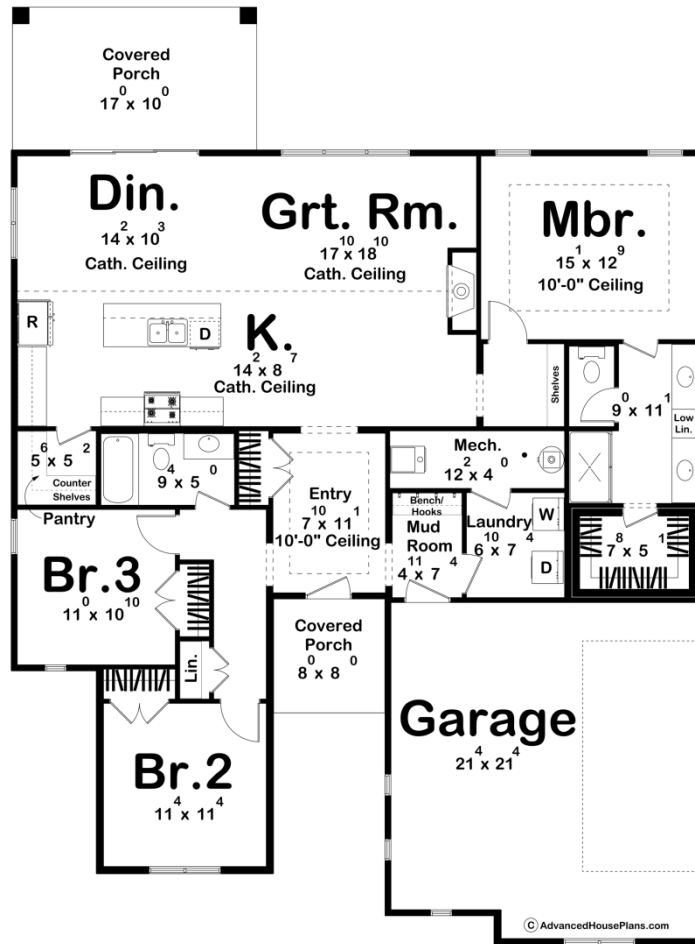

30539 - Finley Park Data Sheet

1686 SQ FT	3 BEDS	2 BATHS	2 BAYS	48' 0" WIDE	65' 0" DEEP
---------------	-----------	------------	-----------	----------------	----------------



Construction Specs

Layout

Bedrooms

Bathrooms	2
Garage Bays	2

Square Footage

Main Level	1686 Sq. Ft.
Covered Area	233 Sq. Ft.
Garage	513 Sq. Ft.
Total Finished Area	1686 Sq. Ft.

Exterior Dimensions

Width	48' 0"
Depth	65' 0"
Ridge Height <i>Calculated from main floor line</i>	25' 6"

Default Construction Stats

Stats are unique to the individual plan.

Foundation Type	Slab
Exterior Wall Construction	2x4
Roof Pitches	Primary 12/12, Secondary 14/12, 4/12, 6/12
Main Wall Height	9'

Plan Description

Introducing the Finley Park, a stunning modern cottage-style home with a beautiful brick and stucco facade. This three-bedroom, two-bathroom residence offers an open floor plan featuring a great room, dining room, and kitchen, all under a soaring cathedral ceiling. The master bedroom includes a unique walk-in closet that doubles as a storm shelter, ensuring safety and convenience. Additional features include a two-car garage, a covered porch for outdoor enjoyment, and a practical mudroom. A designated laundry room adds to the home's functionality. Experience the perfect blend of modern design and cottage charm with Finley Park.