

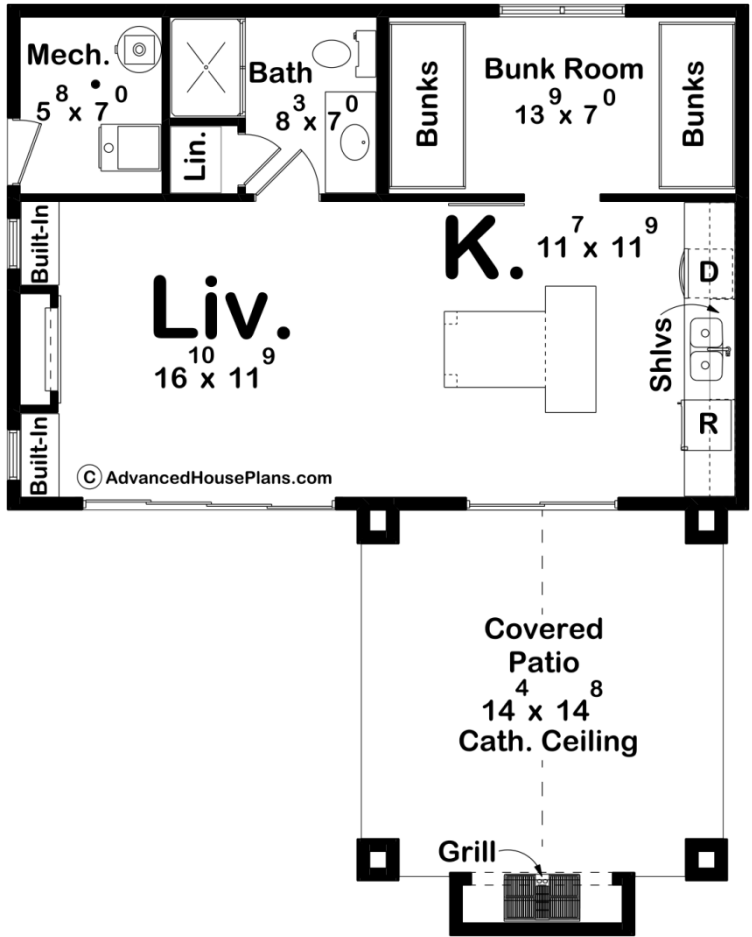

30260 - Firethorn Data Sheet

527 SQ FT	0 BEDS	1 BATHS	0 BAYS	29' 0" WIDE	36' 6" DEEP
--------------	-----------	------------	-----------	----------------	----------------



Construction Specs

Layout

Bathrooms

Square Footage

Main Level	527 Sq. Ft.
Covered Area	229 Sq. Ft.
Total Finished Area	527 Sq. Ft.

Exterior Dimensions

Width	29' 0"
Depth	36' 6"
Ridge Height <i>Calculated from main floor line</i>	14' 6"

Default Construction Stats

Stats are unique to the individual plan.

Foundation Type	Slab
Exterior Wall Construction	2x4
Roof Pitches	6/12 Primary
Main Wall Height	9'

Plan Description

The Firehorn Pool House is a cute, yet stylish oasis. On the outside is a covered patio area with a built-in grill for all of your entertaining needs. On the inside is a kitchen with a large island for plenty of seating. Across the way is a living space with a built-in fireplace and cabinets. This space has a larger slider door that can be opened to bring the outdoors, in. This pool house is equipped with a bathroom and a bunk room. Windows on most sides helps bring in plenty of natural light during all times of the day. This one is sure to suit all of your needs including a storage/mechanical room accessed from the outside.