

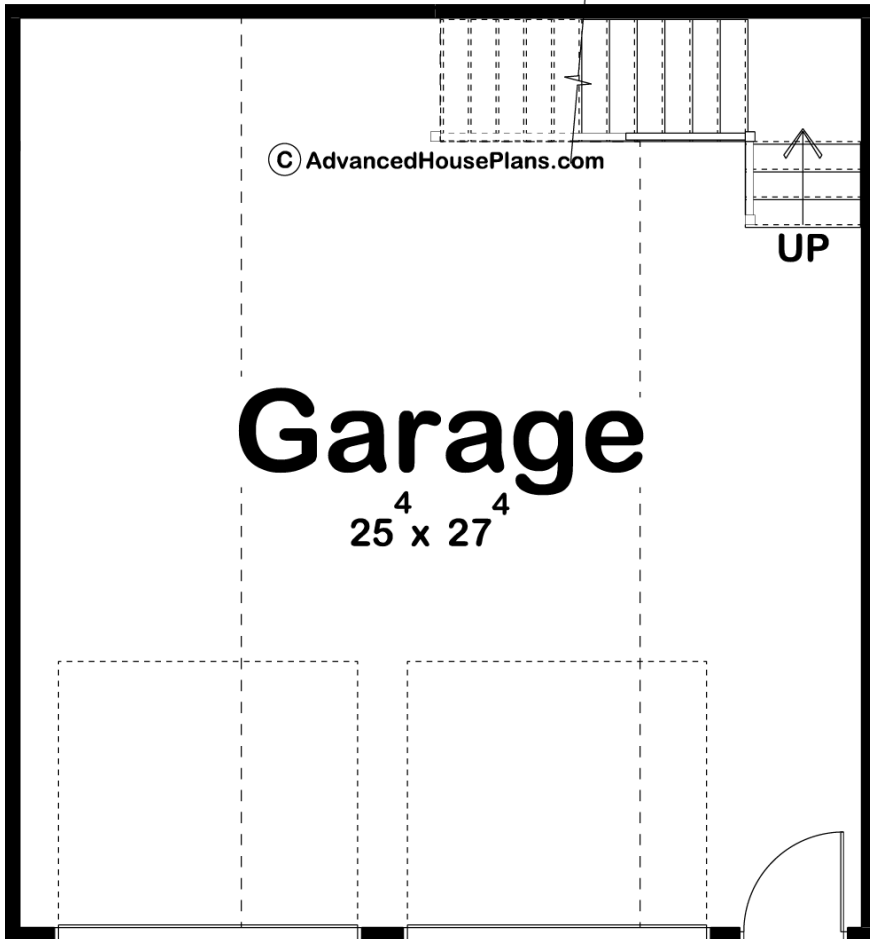

### 29982 - Goodwater Data Sheet

0 SQ FT	0 BEDS	0 BATHS	2 BAYS	26' 0" WIDE	28' 0" DEEP
------------	-----------	------------	-----------	----------------	----------------

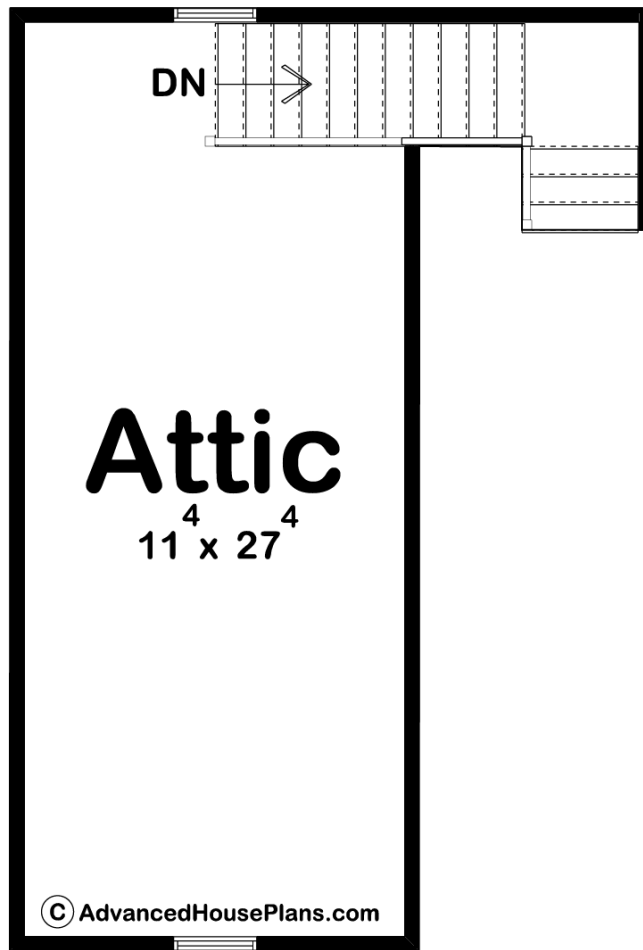



## Construction Specs

### Layout

Garage Bays 2

### Square Footage

Garage 728 Sq. Ft.

### Exterior Dimensions

Width 26' 0"

Depth 28' 0"

Ridge Height 22' 0"  
*Calculated from main floor line*

### Default Construction Stats

*Stats are unique to the individual plan.*

Foundation Type Slab

Exterior Wall Construction 2x4

Roof Pitches 10/12 Primary

Main Wall Height 9'

## Plan Description

This is a traditional style garage plan built on a slab foundation. The floor plan has ample room for 2 cars or would work as a stand-alone workshop. A person door is located on the front for easy access. The Goodwater also includes an attic space above with windows in each gable to allow for natural light and fresh air. Job built stairs make this attic easy to access instead of using a pull down hatch. The attic is 313 sq. ft. of unfinished space. This is the ultimate garage/workshop/storage building.