

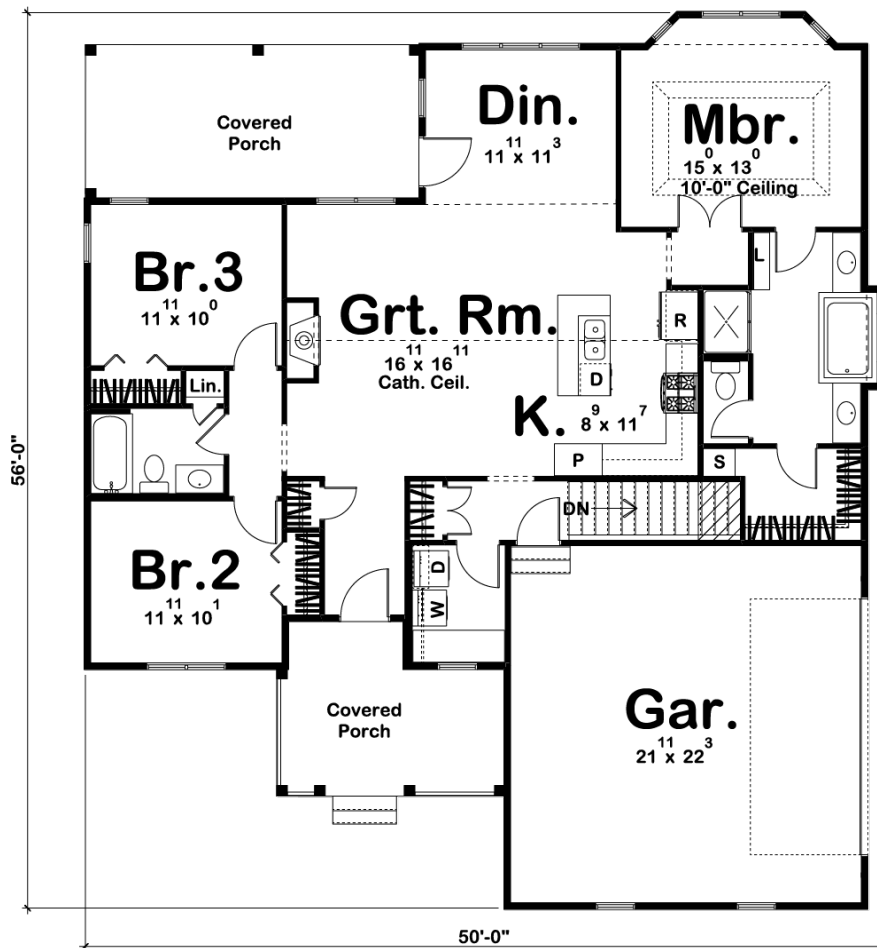

29143 - Hansley Data Sheet

1537 SQ FT	3 BEDS	2 BATHS	2 BAYS	50' 0" WIDE	56' 0" DEEP
---------------	-----------	------------	-----------	----------------	----------------



Construction Specs

Layout

Bedrooms

Bathrooms	2
Garage Bays	2

Square Footage

Main Level	1537 Sq. Ft.
Garage	511 Sq. Ft.
Total Finished Area	1537 Sq. Ft.

Exterior Dimensions

Width	50' 0"
Depth	56' 0"
Ridge Height <i>Calculated from main floor line</i>	22' 0"

Default Construction Stats

Stats are unique to the individual plan.

Foundation Type	Basement
Exterior Wall Construction	2x4
Roof Pitches	6/12 F-B, 10/12 S-S
Foundation Wall Height	9'
Main Wall Height	9'

Plan Description

An appealing front porch enhances the exterior of this Traditional 1 story house plan. Inside, guests are welcomed by a cathedral ceiling and a fireplace in the open great room/ kitchen concept. The L-shaped kitchen and island adjoin the dining area, which opens onto a rear covered porch, where guests can mingle before dinner is served. A generously sized master suite is tucked away for privacy behind the kitchen. The well-appointed master bath includes a large whirlpool tub, shower, compartmented toilet and walk-in closet. Two additional bedrooms occupy this main level house plan, Bedroom 3 offers a birds-eye view of the covered porch outside. This 1 story house plan also features a 2 car side load garage. Check out our other small house plans! As always any Advanced House Plans home plan can be customized to fit your needs with our alteration department. Whether you need to add another garage stall, change the front elevation, stretch the home larger or just make the home plan more affordable for your budget we can do that and more for you at Ahp.