

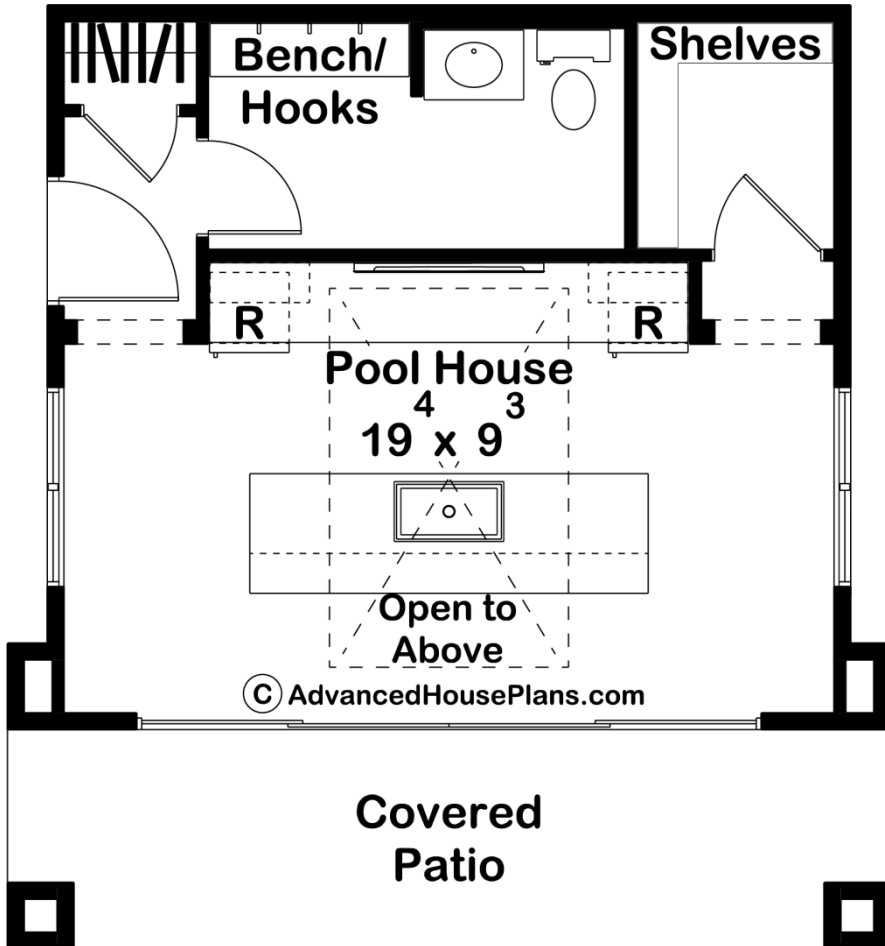

29929 - Harmon Data Sheet

364 SQ FT	0 BEDS	1 BATHS	0 BAYS	22' 0" WIDE	23' 6" DEEP
--------------	-----------	------------	-----------	----------------	----------------



Construction Specs

Layout

Bathrooms

Square Footage

Main Level	364 Sq. Ft.
Covered Area	123 Sq. Ft.
Total Finished Area	364 Sq. Ft.

Exterior Dimensions

Width	22' 0"
Depth	23' 6"

Default Construction Stats

Stats are unique to the individual plan.

Foundation Type	Slab
Exterior Wall Construction	2x4
Roof Pitches	6/12 Primary
Main Wall Height	9'

Plan Description

This pool house design is great for any pool owner. The Harmon welcomes all with a large patio door and a covered area. The covered patio is great for entertaining when the sun reaches its peak. Inside lies a kitchen equipped with a sink for all your prepping needs and multiple refrigerators to keep your drinks cool. The tower above gives a spacious feel with tall ceiling heights. Across the snack bar island is a 4 wide patio door great for bringing the outdoors inside! This simple pool house design provides everything you need including a storage space for all pool equipment, including floaties!