

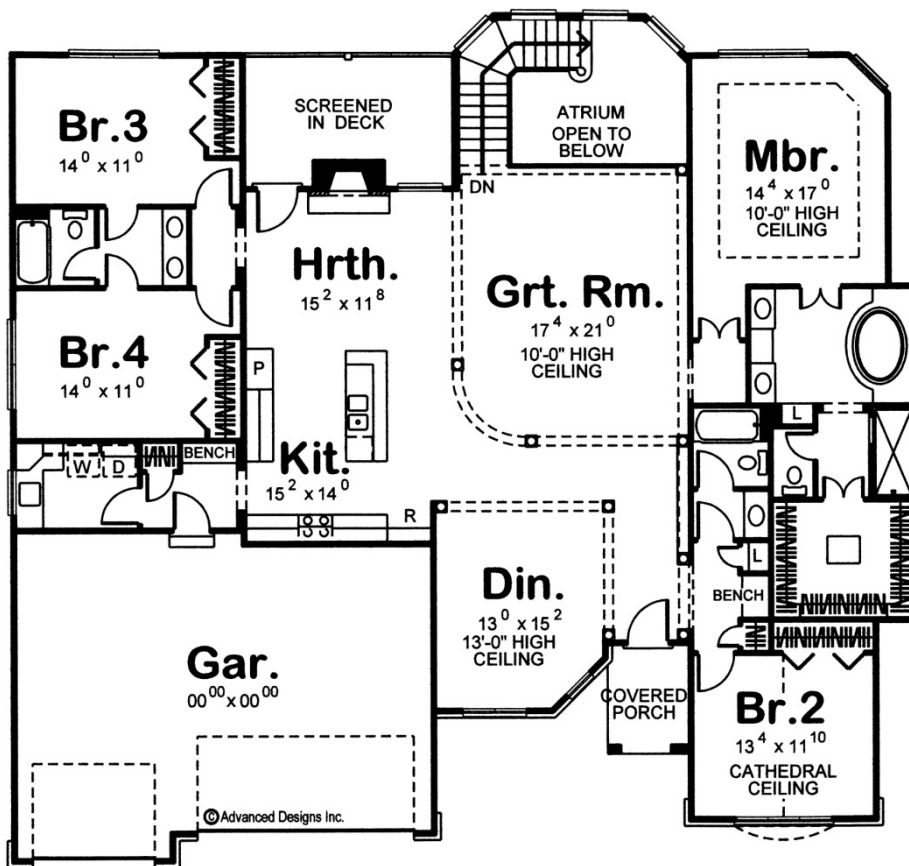

29163 - Hoffman Data Sheet

2788 SQ FT	4 BEDS	3 BATHS	3 BAYS	67' 0" WIDE	63' 0" DEEP
---------------	-----------	------------	-----------	----------------	----------------



Construction Specs

Layout

Bedrooms

Bathrooms 3

Garage Bays 3

Square Footage

Main Level 2788 Sq. Ft.

Garage 705 Sq. Ft.

Total Finished Area 2788 Sq. Ft.

Exterior Dimensions

Width 67' 0"

Depth 63' 0"

Ridge Height 26' 0"

Calculated from main floor line

Default Construction Stats

Stats are unique to the individual plan.

Foundation Type Basement

Exterior Wall Construction 2x4

Roof Pitches 8/12 Primary, 12/12 Secondary

Foundation Wall Height 9'

Main Wall Height 9'

Plan Description

Beautifully crafted design details lend an air of European elegance to this 4-bedroom, 1-story house plan. Upon entering the home, guests are greeted by an open living space that exudes sophistication and style. The boundaries of the formal dining room (with 13-foot-high ceiling) and the great room (with 10-foot-high ceiling), are defined by ceiling heights and tasteful columns. A hearth room extends this open space and accesses a rear screened-in deck. Just off the great room, a stairway leads to an open atrium area on the lower level. The kitchen interacts seamlessly with the main living areas and includes an island workspace. Just off the kitchen, a mud room with coat closet and bench accesses both the 3-car garage and the laundry room with counter space and soaking sink. Double doors, secluded within an alcove, reveal a master suite that abounds with luxurious amenities. The bath area features his and her vanities, oval soaking tub, walk-in shower, compartmented toilet and walk-in closet with built-in dresser.

Bedroom 2 resides nearby, but with appropriate separation from the master suite. This bedroom enjoys a high cathedral ceiling and is just steps away from a hall bath. Bedrooms 3 and 4 are located on the opposite side of the home and share a Jack-n-Jill bath.