

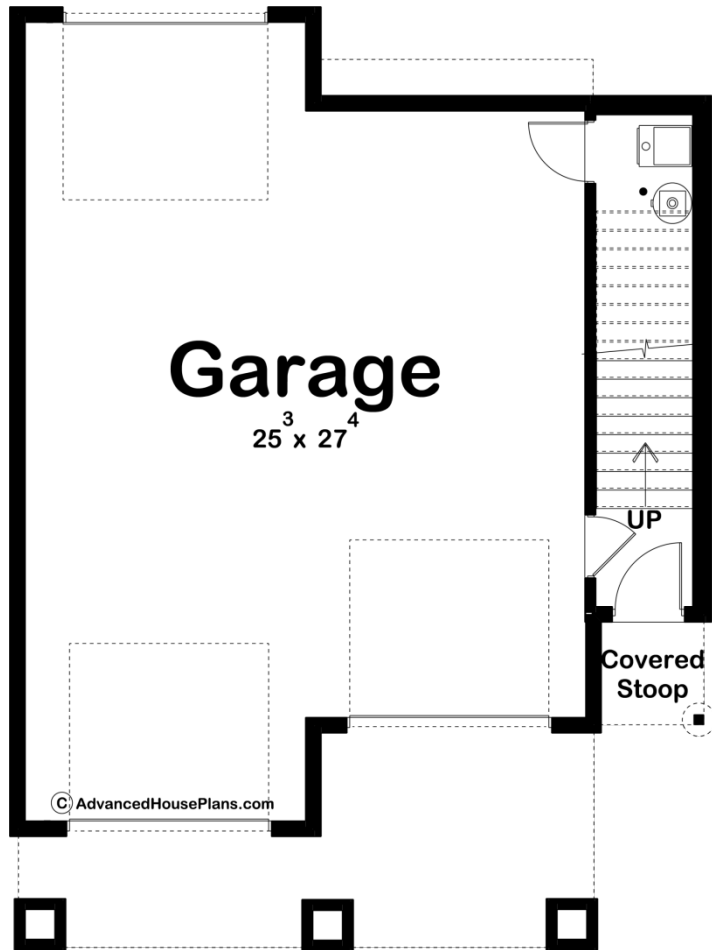

29822 - Holling Heights Data Sheet

984 SQ FT	2 BEDS	2 BATHS	2 BAYS	31' 0" WIDE	42' 0" DEEP
--------------	-----------	------------	-----------	----------------	----------------

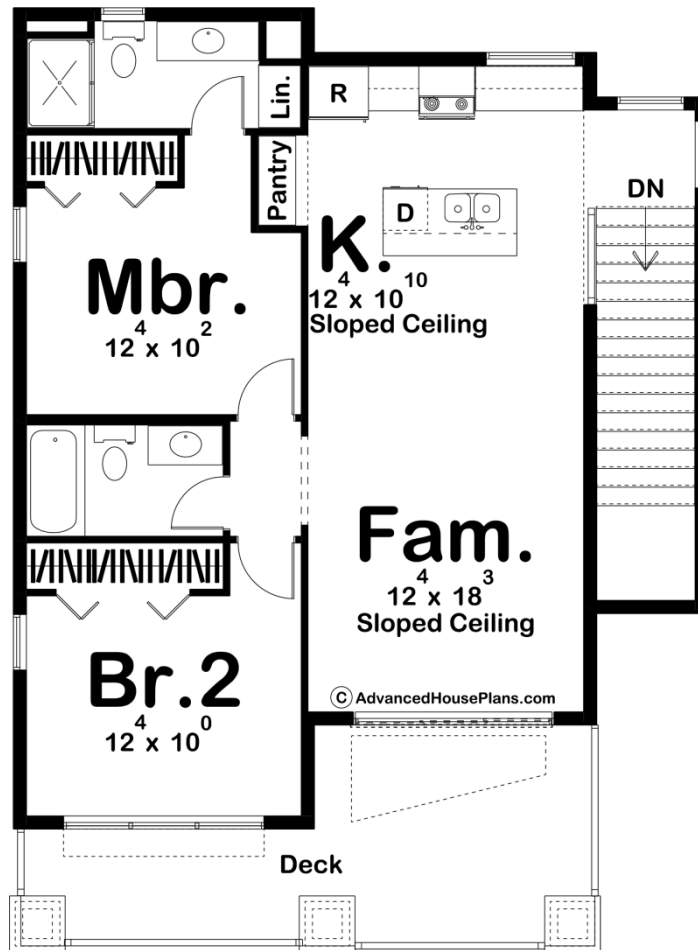



Construction Specs

Layout

Bedrooms	2
Bathrooms	2
Garage Bays	2

Square Footage

Second Level	984 Sq. Ft.
Garage	835 Sq. Ft.
Total Finished Area	984 Sq. Ft.

Exterior Dimensions

Width	31' 0"
Depth	42' 0"

Default Construction Stats

Stats are unique to the individual plan.

Foundation Type	Slab
Exterior Wall Construction	2x4

Roof Pitches	4/12 Primary, 6/12 Secondary
Main Wall Height	9'
Second Wall Height	9'

Plan Description

The Holling Heights carriage house is a modern mountain masterpiece! The exterior showcases an excellent mixture of textures including stone, brick, wood, and metal. The lower level features an oversized 2 car garage with 1 drive-through bay. On the upper level, you'll find a wonderful 2 bedroom apartment. The family room lies under a sloped ceiling making the space feel large. The kitchen includes an island with a snack bar and a pantry. The master bedroom has access to its own bathroom and bedroom 2 shares a bathroom with the main living space.