

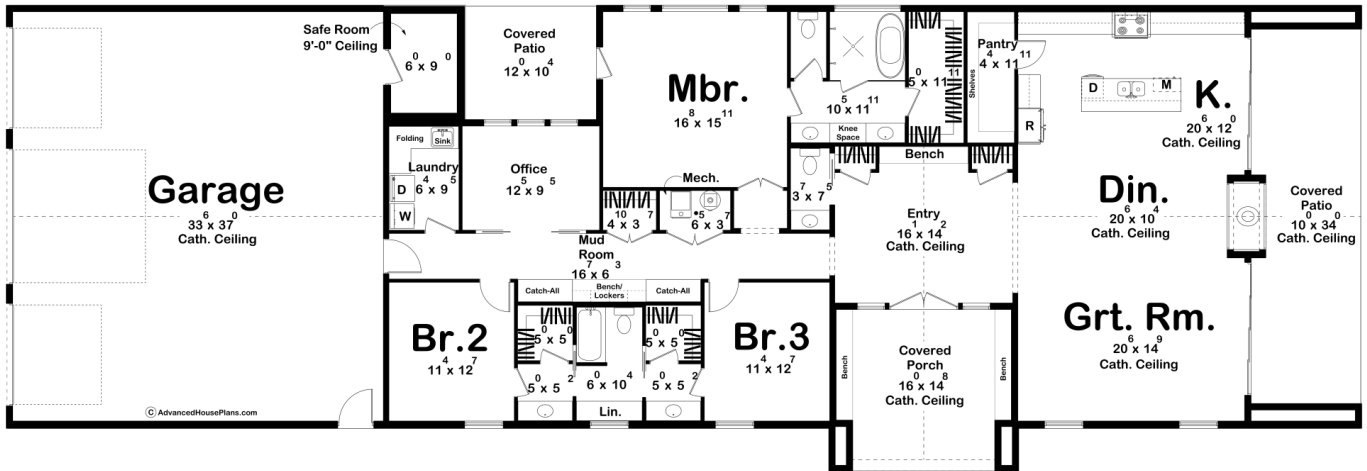

30652 - Horseshoe Bend Data Sheet

2583 SQ FT	3 BEDS	3 BATHS	3 BAYS	122' 4" WIDE	42' 0" DEEP
---------------	-----------	------------	-----------	-----------------	----------------



Construction Specs

Layout

Bedrooms

Bathrooms	3
Garage Bays	3
Square Footage	
Main Level	2583 Sq. Ft.
Covered Area	689 Sq. Ft.
Garage	1292 Sq. Ft.
Total Finished Area	2583 Sq. Ft.
Exterior Dimensions	
Width	122' 4"
Depth	42' 0"
Ridge Height <i>Calculated from main floor line</i>	23' 2"
Default Construction Stats <i>Stats are unique to the individual plan.</i>	
Foundation Type	Slab
Exterior Wall Construction	2x6
Roof Pitches	Primary 6/12, Secondary 8/12
Main Wall Height	12'

Plan Description

Welcome to Horseshoe Bend, a 3-bedroom, 3-bath modern barndominium that offers both style and comfort. The inviting entry features a covered porch with benches on either side and a striking cathedral ceiling. Inside, the main living space has a grand cathedral ceiling and a dual-sided fireplace that extends to a spacious covered patio, perfect for gatherings. The master suite is a true sanctuary, offering a private covered patio for quiet moments. Inside the master bath, you'll find a luxurious shower with a freestanding tub nestled within, creating a spa-like experience. The double vanity provides ample space, and the expansive walk-in closet offers plenty of room for all your wardrobe needs. With large windows in the office for natural light, a dedicated laundry room complete with folding space, and a safe room in the 3-car garage, Horseshoe Bend blends modern design with thoughtful, functional features for everyday living.