

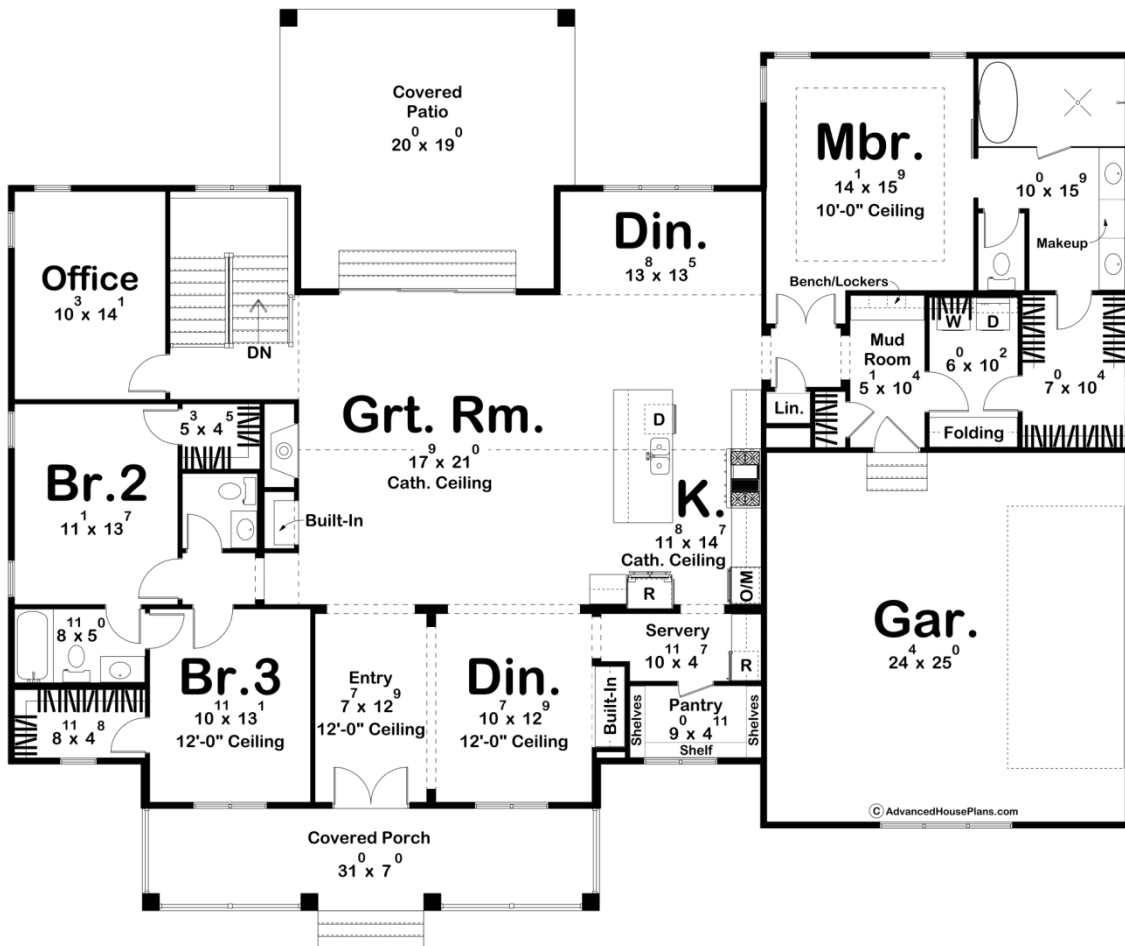

30612 - Howland Heights Data Sheet

2643 SQ FT	3 BEDS	3 BATHS	2 BAYS	76' 0" WIDE	61' 0" DEEP
---------------	-----------	------------	-----------	----------------	----------------



Construction Specs

Layout

Bedrooms

Bathrooms	3
Garage Bays	2

Square Footage

Main Level	2643 Sq. Ft.
Covered Area	578 Sq. Ft.
Garage	626 Sq. Ft.
Total Finished Area	2643 Sq. Ft.

Exterior Dimensions

Width	76' 0"
Depth	61' 0"
Ridge Height <i>Calculated from main floor line</i>	26' 3"

Default Construction Stats

Stats are unique to the individual plan.

Foundation Type	Basement
Exterior Wall Construction	2x4
Roof Pitches	Primary 8/12, Secondary 12/12, 6/12, 3/12
Foundation Wall Height	9'
Main Wall Height	9'

Plan Description

This 1-story modern farmhouse exudes timeless charm with its board-and-batten siding, complemented by warm wood accents. A wide, symmetrical front covered porch spans the home's façade, creating a welcoming space to relax and enjoy the outdoors. The design includes a convenient 2-car side-load garage, seamlessly integrated into the overall aesthetic. Inside, the home features a spacious great room and kitchen, unified beneath a striking cathedral ceiling that enhances the sense of openness. Just off the kitchen, a cozy dinette is perfect for casual meals, while a separate formal dining room provides an elegant setting for gatherings and special occasions. The layout is designed for comfort and privacy, with the master suite occupying one corner of the home. This retreat includes a luxurious en-suite bathroom and a walk-in closet. On the opposite side of the house, two additional bedrooms and two bathrooms provide ample space for family or guests, along with a versatile office that can serve as a study or workspace. At the rear, a covered patio extends the living area outdoors, offering a peaceful spot for relaxation or entertaining. This modern farmhouse blends classic elements with practical design, creating a beautiful and functional home perfect for modern living.