

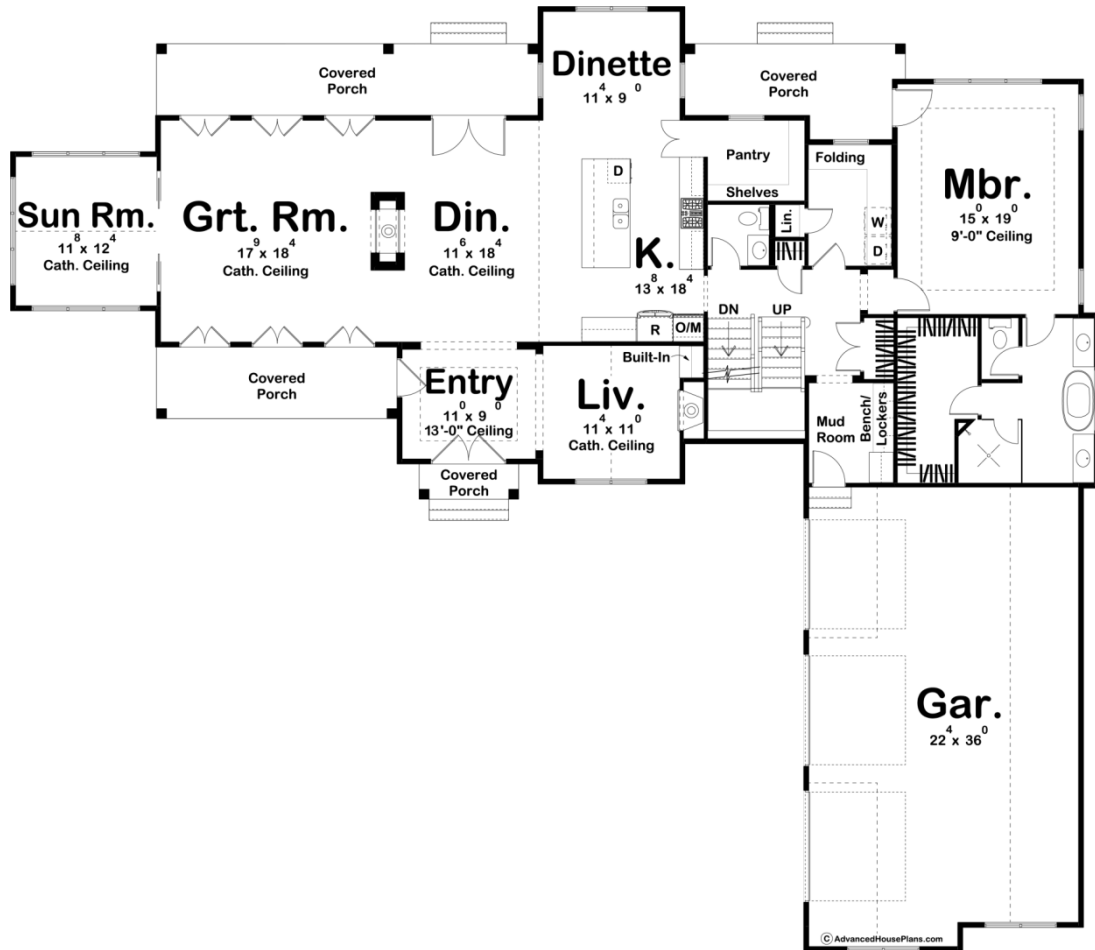

30087 - Hudson Data Sheet

3299 SQ FT	4 BEDS	4 BATHS	3 BAYS	90' 0" WIDE	78' 0" DEEP
---------------	-----------	------------	-----------	----------------	----------------

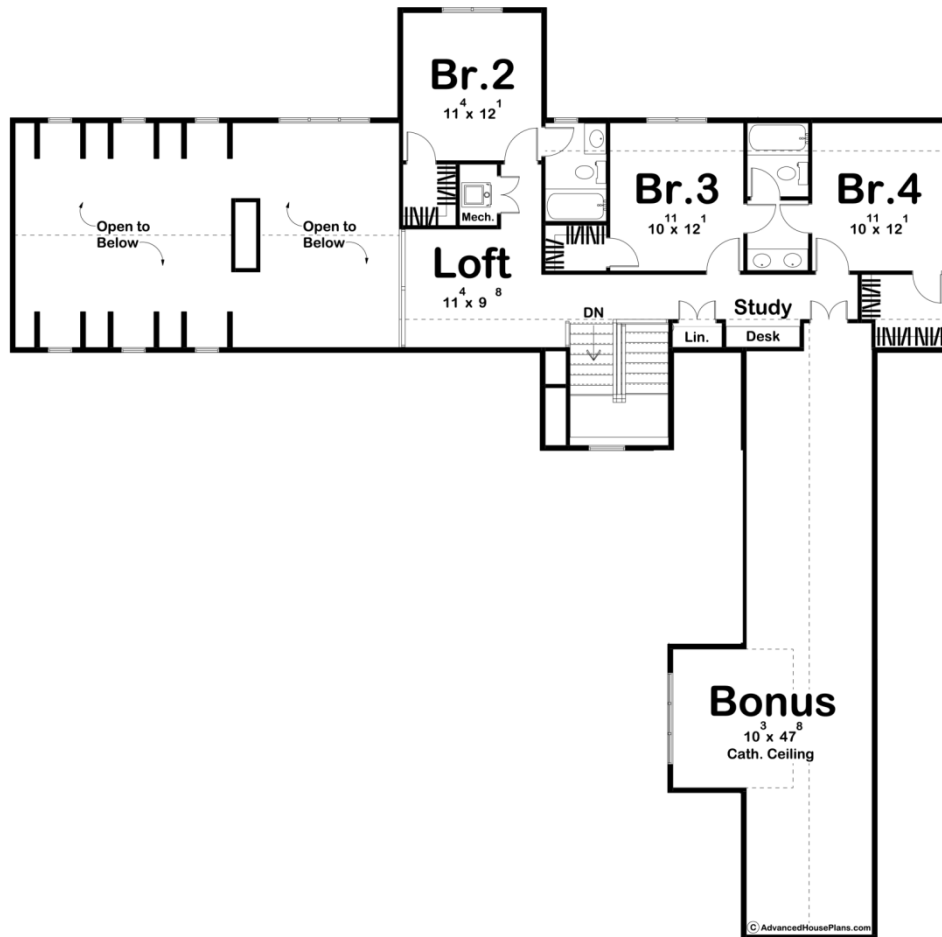



Construction Specs

Layout

Bedrooms	4
Bathrooms	4
Garage Bays	3

Square Footage

Main Level	2370 Sq. Ft.
Second Level	929 Sq. Ft.
Covered Area	456 Sq. Ft.
Garage	862 Sq. Ft.
Total Finished Area	3299 Sq. Ft.

Exterior Dimensions

Width	90' 0"
Depth	78' 0"

Default Construction Stats

Stats are unique to the individual plan.

Foundation Type	Basement
Exterior Wall Construction	2x4
Roof Pitches	10/12 Primary, 4/12 Secondary
Foundation Wall Height	9'
Main Wall Height	9'
Second Wall Height	8'

Plan Description

The Hudson plan is a magnificent 1.5 Story Modern Farmhouse style house plan. The exterior features a 3 car courtyard garage, board and batten siding and dormers. Just inside the front door, you'll find yourself in an amazing entry with a 10' ceiling. Just to the right of the entry is a formal living room with a fireplace that is a perfect place to relax. The great room lies under a soaring 2 story cathedral ceiling and shared a double-sided fireplace with the dining room. Just off the great room is a sun room. The kitchen includes a large island with a snack bar and a walk-in pantry. Tucked away on the right side of the main level is the stunning master suite. The massive master suite features a soaking tub, his/her vanities, a walk-in shower, an enclosed toilet area, and a massive walk-in closet. The second level features 3 additional bedrooms and a large bonus room above the garage. Bedrooms 3 and 4 share a bathroom, while bedroom has access to it's own bathroom. An optional bonus area adds 615 sq ft.