

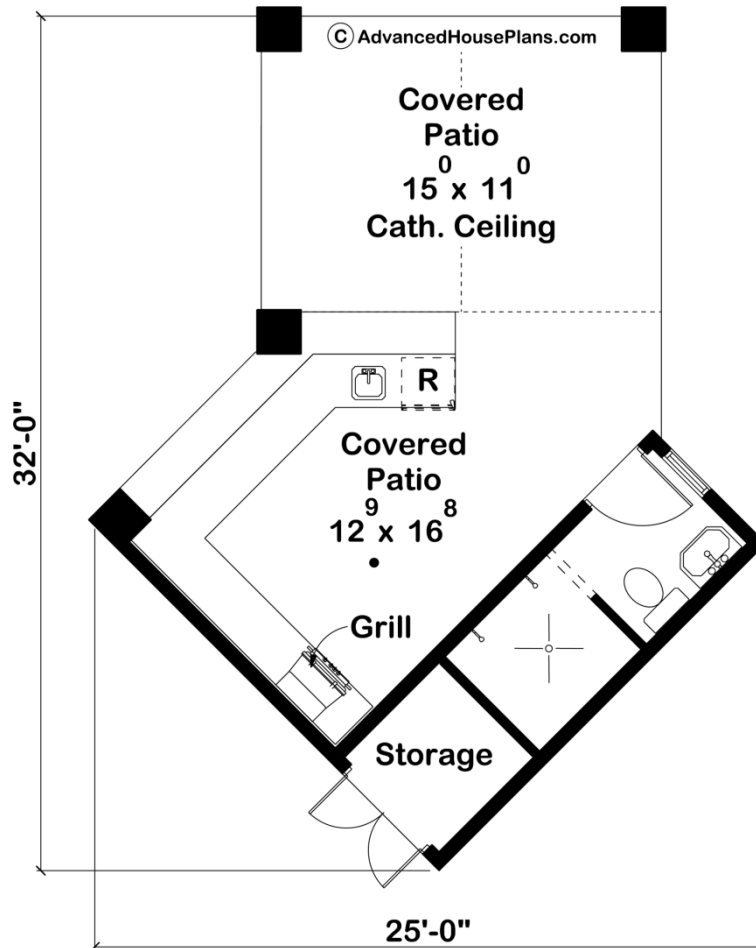

**29289 - Ivarson Data Sheet**

305 SQ FT	0 BEDS	0 BATHS	0 BAYS	24' 11" WIDE	32' 0" DEEP
--------------	-----------	------------	-----------	-----------------	----------------



**Construction Specs**

Layout
Square Footage

Main Level	305 Sq. Ft.
Covered Area	170 Sq. Ft.
Total Finished Area	305 Sq. Ft.

### Exterior Dimensions

Width	24' 11"
Depth	32' 0"
Ridge Height <i>Calculated from main floor line</i>	17' 0"

### Default Construction Stats

*Stats are unique to the individual plan.*

Foundation Type	Slab
Exterior Wall Construction	2x4
Main Wall Height	9'

## Plan Description

The Ivarson plan is craftsman style pool house with plenty of outdoor space. The covered patio is great for entertaining at any time of the day, with detailed wood trusses and partial stone covered columns. Under the cathedral ceiling lies an L-shaped counter with enough space for any size backyard BBQ. It is equipped with a sink for all your prepping needs and spaces for a refrigerator and the grill of your dreams. On the inside lies a 3/4 bath with a roomy walk-in shower. This pool house plan provides everything you need including a storage space for all pool equipment, including floaties! Be sure to check out our other pool houses. As always any of our plans at Advanced House Plans can be customized to fit your needs with our alteration department. Whether you need to change the front elevation style, stretch it larger or just make the plan more affordable for your budget we can do that and more for you at Ahp.