

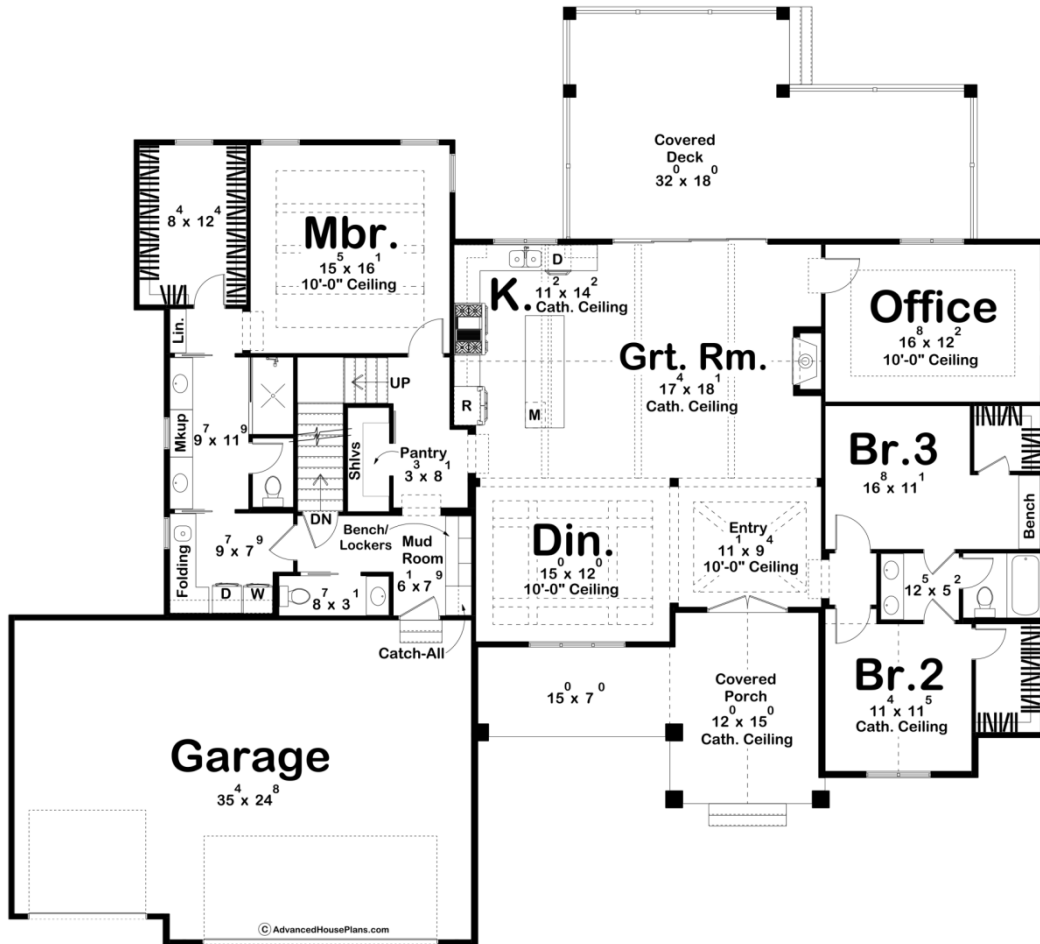

30335 - Lakeshore Data Sheet

2412 SQ FT	3 BEDS	3 BATHS	3 BAYS	80' 0" WIDE	72' 4" DEEP
---------------	-----------	------------	-----------	----------------	----------------

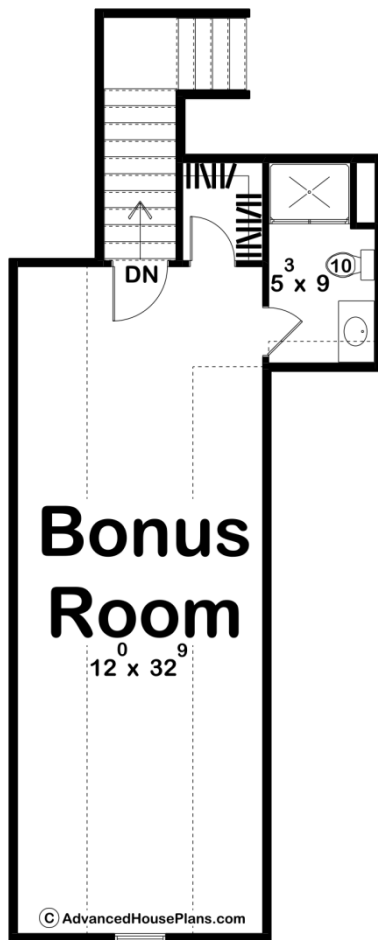



Construction Specs

Layout

Bedrooms	3
Bathrooms	3
Garage Bays	3

Square Footage

Main Level	2412 Sq. Ft.
Covered Area	778 Sq. Ft.
Garage	879 Sq. Ft.
Total Finished Area	2412 Sq. Ft.

Exterior Dimensions

Width	80' 0"
Depth	72' 4"
Ridge Height	22' 7"
<i>Calculated from main floor line</i>	

Default Construction Stats

Stats are unique to the individual plan.

Foundation Type	Basement
Exterior Wall Construction	2x4
Roof Pitches	Primary 8/12, Secondary 12/12, 6/12
Foundation Wall Height	9'
Main Wall Height	9'
Second Wall Height	8'

Plan Description

The optional bonus space on the second level is 500 additional square feet. Introducing a stunning modern farmhouse plan that exudes timeless elegance and functionality. This thoughtfully designed 3-bedroom, 3-bathroom home boasts a desirable open concept layout, a 3-car garage, and beautiful exposed beams that add a touch of rustic charm. As you step inside, the entrance leads you seamlessly into the adjacent dining room, creating a warm and inviting atmosphere for hosting family gatherings or entertaining friends. The open kitchen, with its sleek and contemporary design, offers ample counter space, high-end appliances, and a convenient center island, making it a dream for any culinary enthusiast. The kitchen flows seamlessly into the great room, forming a spacious and comfortable area for relaxation and bonding with loved ones. The architectural beauty of exposed beams throughout the home adds character and visual interest, providing a subtle nod to the farmhouse style while maintaining a modern aesthetic. On the right side of the home, you'll find two well-appointed bedrooms which share a practical jack and jill bathroom. This configuration offers convenience and privacy for family members or guests. Additionally, there is an office space, providing a dedicated area for work or study, ensuring productivity and focus in a serene environment. Nestled on the left side of the home, the master suite beckons with its luxurious and private ambiance. This spacious retreat features a carefully designed layout, encompassing a master bedroom, a well-appointed en-suite bathroom, and a generously sized walk-in closet. The master bathroom showcases modern fixtures, a makeup counter, a spacious shower, and a double vanity, creating a spa-like experience within the comfort of your own home. The exterior of this modern farmhouse plan is equally captivating, featuring a blend of classic and contemporary elements. The charming front porch invites you to relax and enjoy the fresh air, while the 3-car garage provides ample space for parking and storage. The large covered deck on the rear also provides a great place for relaxation while staying sheltered from the elements.