

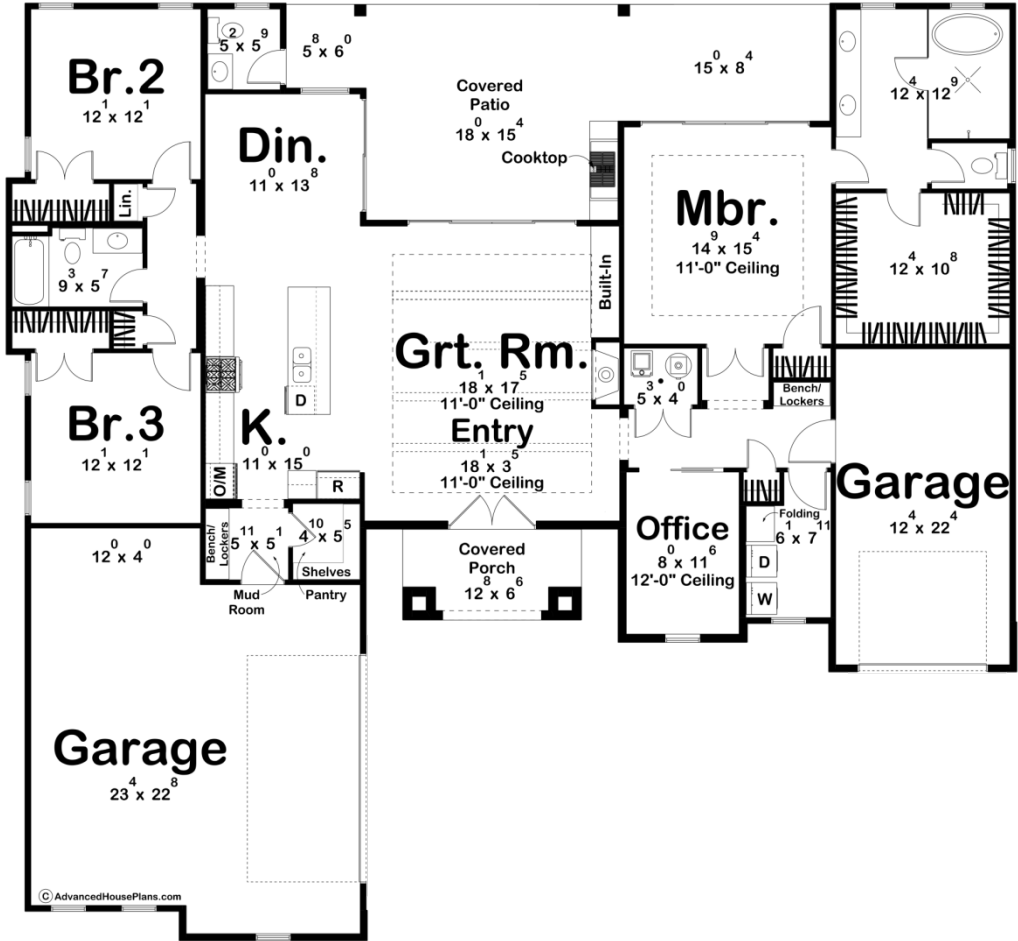

30518 - Latitude Data Sheet

2171 SQ FT	3 BEDS	3 BATHS	3 BAYS	71' 4" WIDE	66' 0" DEEP
---------------	-----------	------------	-----------	----------------	----------------



Construction Specs

Layout

Bedrooms

Bathrooms	3
Garage Bays	3
Square Footage	
Main Level	2171 Sq. Ft.
Covered Area	513 Sq. Ft.
Garage	916 Sq. Ft.
Total Finished Area	2171 Sq. Ft.
Exterior Dimensions	
Width	71' 4"
Depth	66' 0"
Ridge Height <i>Calculated from main floor line</i>	29' 10"
Default Construction Stats <i>Stats are unique to the individual plan.</i>	
Foundation Type	Slab
Exterior Wall Construction	2x4
Roof Pitches	Primary 12/12, Secondary 14/12, 6/12
Main Wall Height	10'

Plan Description

Welcome to the Latitude, this residence features an inviting open-concept layout, where natural light floods the living spaces through large windows. The spacious kitchen boasts sleek quartz countertops, custom cabinetry, and stainless steel appliances, perfect for both casual meals and entertaining.Each bedroom offers ample closet space and stylish finishes, with the master featuring an en-suite bathroom, complete with dual vanities and a walk-in shower. The additional bathroom is finished with modern fixtures, tile accents, and chic lighting for a spa-like feel.Outside, enjoy a private, beautifully landscaped yard with a cozy patio for outdoor dining or relaxing in a tranquil garden setting. The home’s exterior combines clean lines with cottage-inspired details, such as a gabled roof and charming front porch, creating an inviting curb appeal.