

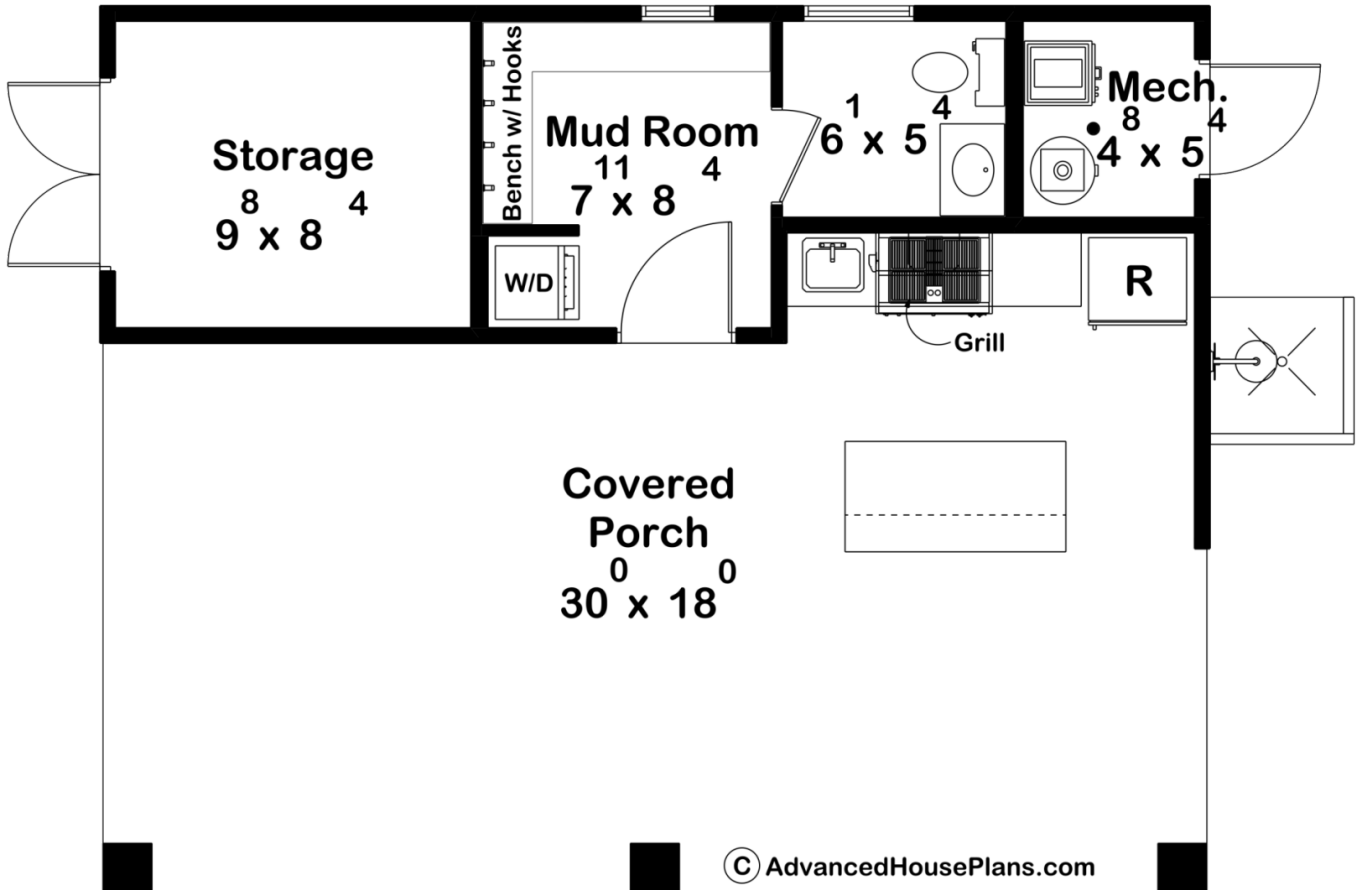

**30504 - Livermore Data Sheet**

116 SQ FT	0 BEDS	1 BATHS	0 BAYS	30' 0" WIDE	24' 0" DEEP
--------------	-----------	------------	-----------	----------------	----------------



**Construction Specs**

Layout

Bathrooms

## Square Footage

Main Level	116 Sq. Ft.
Covered Area	484 Sq. Ft.
Total Finished Area	116 Sq. Ft.

## Exterior Dimensions

Width	30' 0"
Depth	24' 0"
Ridge Height <i>Calculated from main floor line</i>	15' 7"

## Default Construction Stats

*Stats are unique to the individual plan.*

Foundation Type	Slab
Exterior Wall Construction	2x4
Roof Pitches	Primary 6/12
Main Wall Height	9'

## Plan Description

Imagine owning a stylish modern farmhouse pool house that embodies the perfect blend of sophistication and relaxation. Step onto the large covered porch, where you can unwind and entertain while enjoying views of the pool and surrounding landscape. The outdoor kitchen invites you to host gatherings and prepare meals al fresco, creating unforgettable moments with family and friends. After a swim, rinse off in the outdoor shower, a refreshing experience that connects you with nature. Inside, a thoughtfully designed storage room provides ample space for pool toys, equipment, and supplies, keeping everything organized and easily accessible. The mudroom, complete with a stacked washer and dryer, offers convenience and functionality, allowing you to clean up after outdoor activities without hassle. This modern farmhouse pool house is more than just a retreat—it's a sanctuary where luxury meets practicality, enhancing your lifestyle with every detail. This plan also has 120 sq ft of unfished storage & mechanical space.