

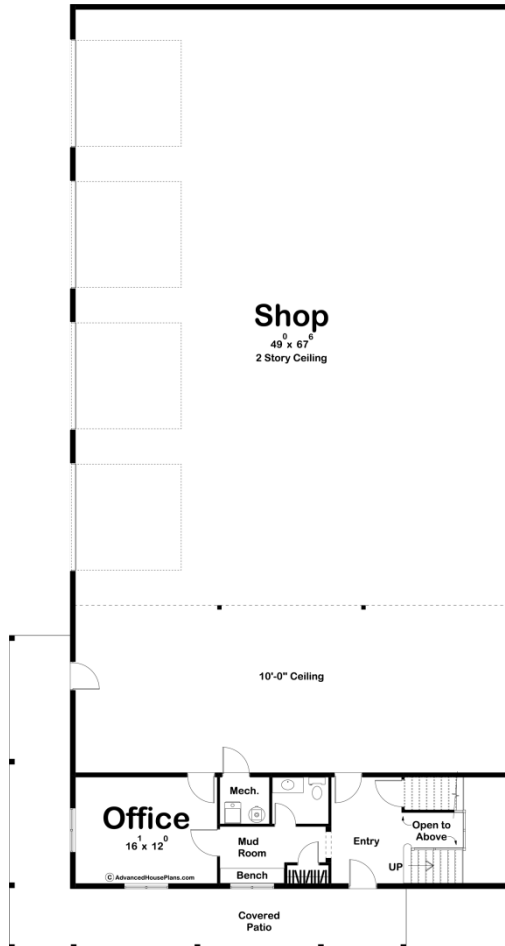

**30089 - Louisburg Data Sheet**

2057 SQ FT	1 BEDS	3 BATHS	8 BAYS	50' 0" WIDE	107' 0" DEEP
---------------	-----------	------------	-----------	----------------	-----------------

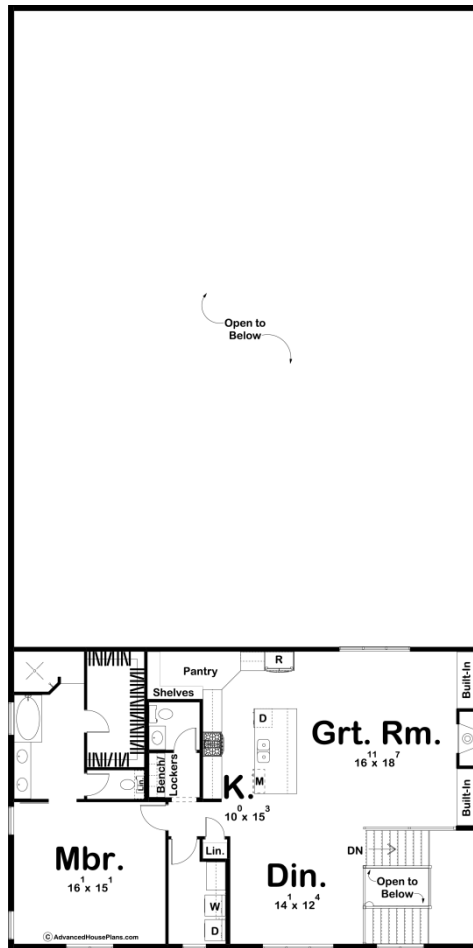



## Construction Specs

### Layout

Bedrooms	1
Bathrooms	3
Garage Bays	8

### Square Footage

Main Level	620 Sq. Ft.
Second Level	1437 Sq. Ft.
Garage	4347 Sq. Ft.
Total Finished Area	2057 Sq. Ft.

### Exterior Dimensions

Width	50' 0"
Depth	107' 0"

### Default Construction Stats

*Stats are unique to the individual plan.*

Foundation Type	Slab
-----------------	------

Exterior Wall Construction	2x6
Roof Pitches	6/12 Primary, 4/12 Secondary
Main Wall Height	10'
Second Wall Height	9'

## Plan Description

If you've ever wondered what a "Shouse" is....it's this plan. A Shouse is a shop and a house under one roof. The Louisburg plan is a massive shop with a fully functional living quarters on the second floor. The shop area comes in at over 4000 sq. ft. and is a great place for any hobbyist or anyone who works in their garage daily. An office is just off the shop area and provides a great space to run your business from. On the second floor, you'll find an absolutely amazing 1 bedroom apartment. The great room is warmed by a fireplace that is flanked by built-in bookshelves. The full kitchen includes a large island and a deep walk-in pantry. The master bedroom includes a walk-in shower, dual vanity, a soaking tub, and a large walk-in closet.