

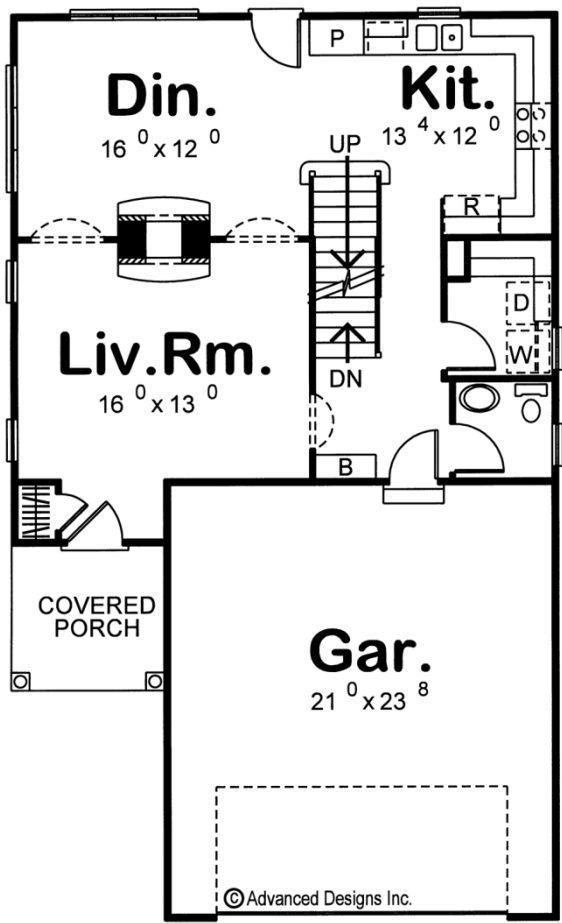

29145 - Macon Data Sheet

| | | | | | |
|---------------|-----------|------------|-----------|----------------|----------------|
| 1589 SQ FT | 3 BEDS | 3 BATHS | 2 BAYS | 30' 0" WIDE | 50' 0" DEEP |
|---------------|-----------|------------|-----------|----------------|----------------|

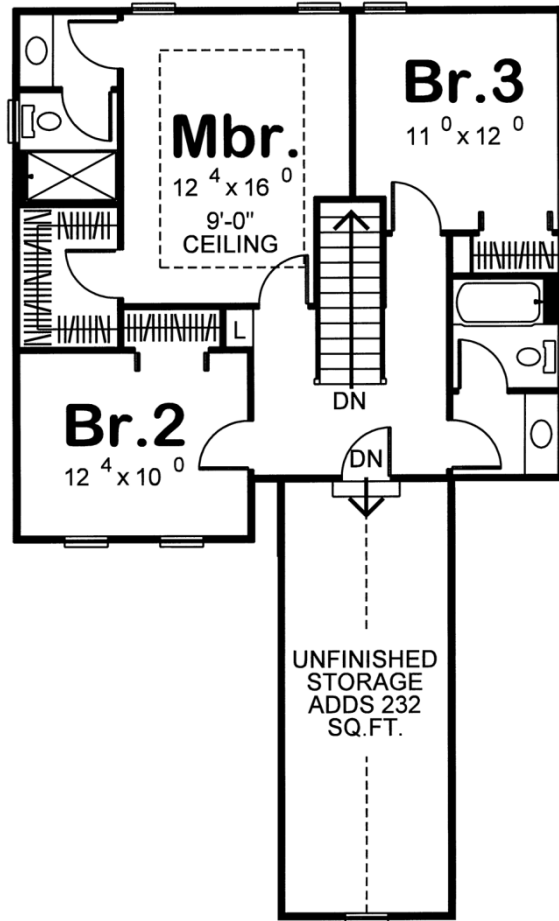



Construction Specs

Layout

| | |
|-------------|---|
| Bedrooms | 3 |
| Bathrooms | 3 |
| Garage Bays | 2 |

Square Footage

| | |
|---------------------|--------------|
| Main Level | 809 Sq. Ft. |
| Second Level | 780 Sq. Ft. |
| Garage | 519 Sq. Ft. |
| Total Finished Area | 1589 Sq. Ft. |

Exterior Dimensions

| | |
|--|--------|
| Width | 30' 0" |
| Depth | 50' 0" |
| Ridge Height | 25' 0" |
| <i>Calculated from main floor line</i> | |

Default Construction Stats

Stats are unique to the individual plan.

| | |
|----------------------------|-------------------------------|
| Foundation Type | Basement |
| Exterior Wall Construction | 2x4 |
| Roof Pitches | 6/12 Primary, 10/12 Secondary |
| Foundation Wall Height | 9' |
| Main Wall Height | 9' |
| Second Wall Height | 8' |

Plan Description

At just 30 feet in width, this charming 1,589 sq. ft., Modern Farmhouse plan lives like a much larger home. Inside from the front covered porch, guests are immediately invited into the living room, where a two-sided fireplace warms the atmosphere -- along with that of the dining area to the rear. The kitchen lies open to the dining area and it includes plenty of counter space and a built-in pantry. A laundry room and powder bath are just steps away, towards the entrance to the 2-car, front-load garage. Upstairs, the master suite enjoys an airy 9-foot-high boxed ceiling, an efficient bath area, and a walk-in closet. Bedrooms 2 and 3 areas each brightened by two windows and share a hall bath. Nearby, an unfinished storage area adds the potential of 232 sq. ft. of usable space. Check out our other small house plans! As always any Advanced House Plans home plan can be customized to fit your needs with our alteration department. Whether you need to add another garage stall, change the front elevation, stretch the home larger or just make the home plan more affordable for your budget we can do that and more for you at Ahp.