

ADVANCED
HOUSE PLANS

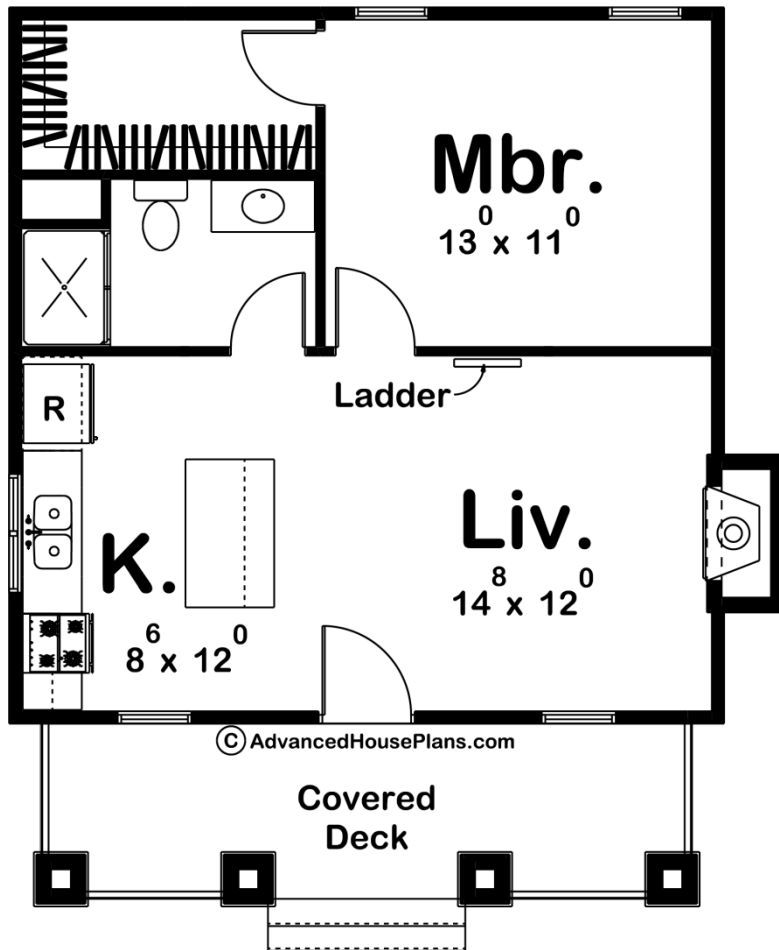

29508 - Madeline Data Sheet

722 SQ FT	1 BEDS	1 BATHS	0 BAYS	24' 0" WIDE	30' 0" DEEP
--------------	-----------	------------	-----------	----------------	----------------



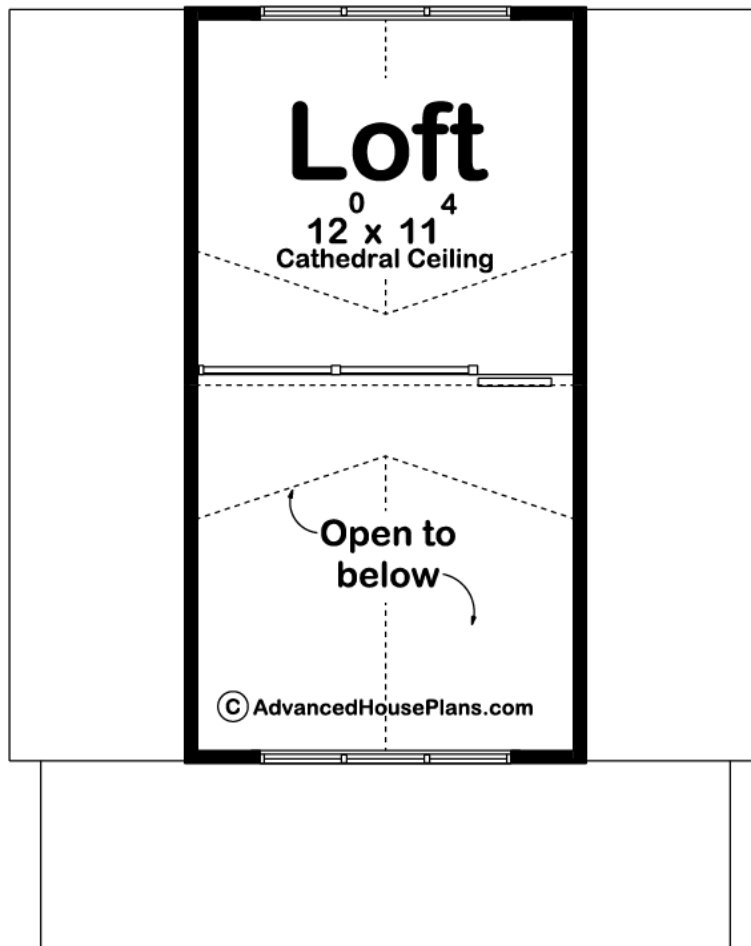

Construction Specs

Layout

Bedrooms	1
Bathrooms	1

Square Footage

Main Level	576 Sq. Ft.
Second Level	146 Sq. Ft.
Total Finished Area	722 Sq. Ft.

Exterior Dimensions

Width	24' 0"
Depth	30' 0"
Ridge Height	21' 0"
<i>Calculated from main floor line</i>	

Default Construction Stats

Stats are unique to the individual plan.

Foundation Type	Crawlspace
-----------------	------------

Exterior Wall Construction	2x4
Roof Pitches	Primary 12/12, Secondary 4/12
Main Wall Height	8'
Second Wall Height	7'

Plan Description

The Madeline, with its charming craftsman style and great curb appeal, is a great home for a fun getaway. The exterior is enhanced by a covered deck with 4 columns that give this cabin a classic craftsman look. Inside you'll find a large great room that is warmed by a fireplace and a full kitchen complete with an island and breakfast bar. The master bedroom, located on the main floor, has a walk-in closet. In the great room you will find a ladder that leads to a loft that can be used as a second bedroom. The cathedral ceilings make this cabin feel even larger than it is.