

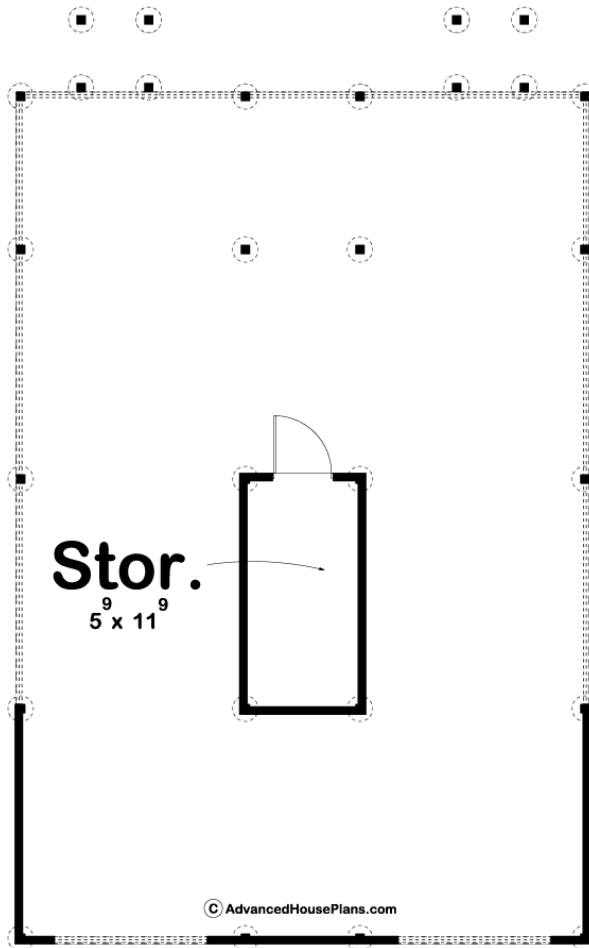

29759 - Marco Island Data Sheet

1064 SQ FT	2 BEDS	1 BATHS	0 BAYS	30' 0" WIDE	45' 0" DEEP
---------------	-----------	------------	-----------	----------------	----------------

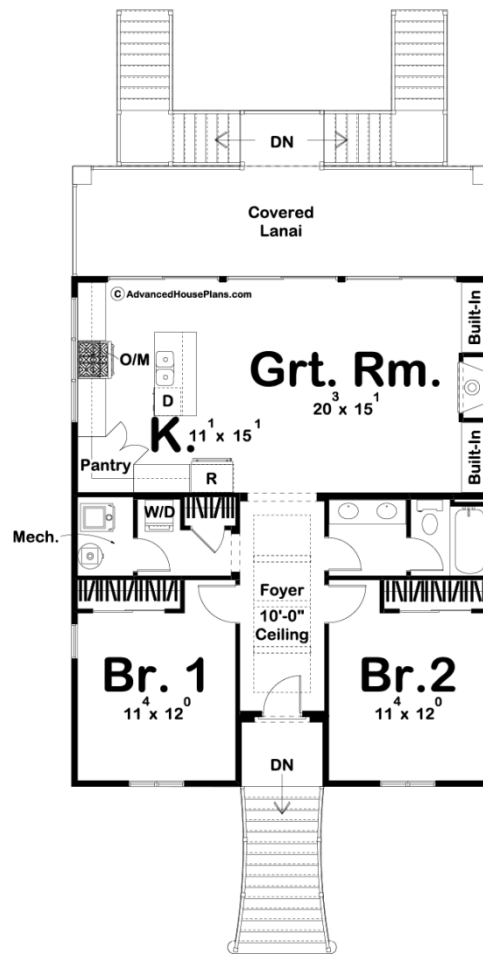



Construction Specs

Layout

Bedrooms	2
Bathrooms	1

Square Footage

Main Level	1064 Sq. Ft.
Total Finished Area	1064 Sq. Ft.

Exterior Dimensions

Width	30' 0"
Depth	45' 0"
Ridge Height <i>Calculated from main floor line</i>	31' 0"

Default Construction Stats

Stats are unique to the individual plan.

Foundation Type	Post and Pier
Exterior Wall Construction	2x4

Roof Pitches

6/12 Primary

Foundation Wall Height

9'

Main Wall Height

9'

Plan Description

Waterfront views can be enjoyed from any room in this captivating Coastal-style, beach house plan. On the outside, you will find a grand staircase at ground level leading up to the raised main level, and two separate stairways leading up to the covered lanai on the backside of the house. On the inside of the Marco Island plan, the great room and kitchen can open up to the covered lanai with 3 sliding glass doors. The great room includes a fireplace that is flanked by built-in bookshelves. The kitchen is well equipped with an island and a pantry.