

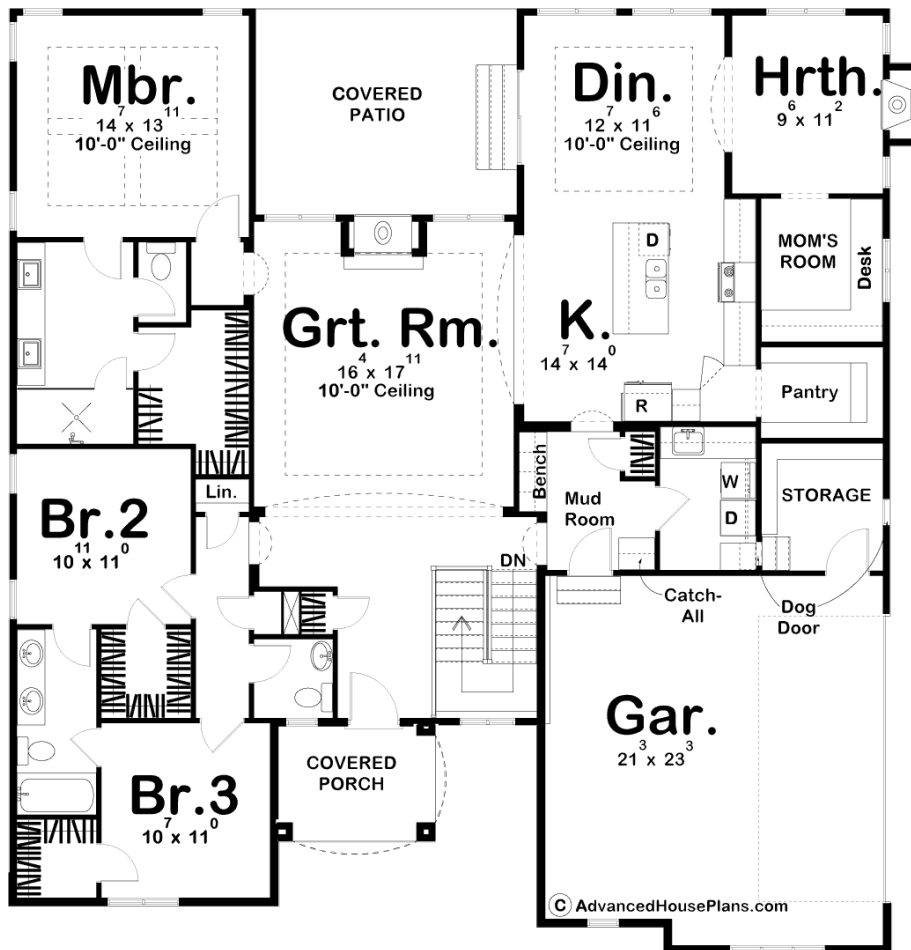

29349 - Matthews Data Sheet

| | | | | | |
|---------------|-----------|------------|-----------|----------------|----------------|
| 2193 SQ FT | 3 BEDS | 3 BATHS | 2 BAYS | 57' 0" WIDE | 60' 0" DEEP |
|---------------|-----------|------------|-----------|----------------|----------------|



Construction Specs

Layout

Bedrooms

| | |
|-------------|---|
| Bathrooms | 3 |
| Garage Bays | 2 |

Square Footage

| | |
|---------------------|--------------|
| Main Level | 2193 Sq. Ft. |
| Garage | 571 Sq. Ft. |
| Total Finished Area | 2193 Sq. Ft. |

Exterior Dimensions

| | |
|--|--------|
| Width | 57' 0" |
| Depth | 60' 0" |
| Ridge Height <i>Calculated from main floor line</i> | 27' 0" |

Default Construction Stats

Stats are unique to the individual plan.

| | |
|----------------------------|---------------------|
| Foundation Type | Basement |
| Exterior Wall Construction | 2x4 |
| Roof Pitches | 10/12 F-B 12/12 S-S |
| Foundation Wall Height | 9' |
| Main Wall Height | 9' |

Plan Description

The Matthews is a beautiful cottage-style ranch plan that is a perfect fit for families. This home plan has been specially crafted to make the lives of families more functional and enjoyable. An inviting front porch leads you into a wonderful great room that is warmed by a double sided fireplace that can also be enjoyed from the covered patio. The functional kitchen includes a large walk-in pantry and an island with a breakfast bar. A large dining room flows into a cozy hearth room where you can hang out by a second fireplace. This house is designed to keep your life organized and includes a mom's room with a built-in desk off of the hearth room. On the other side of the house, you will find the bedrooms. The master suite is situated perfectly with his and her vanities in the master bath and a large walk-in closet. Bedrooms 2 and 3 share a jack and jill bathroom with dual vanities. A house designed for families wouldn't be complete without thinking of your 4 legged friends. This house has a built in dog door that leads from the back yard through a storage room into the home. As always, any Advanced House Plans home plan can be customized to fit your needs with our alteration department. Whether you need to add another garage stall, change the front elevation, stretch the home larger or just make the home plan more affordable for your budget we can do that and more for you at AHP.