

ADVANCED
HOUSE PLANS

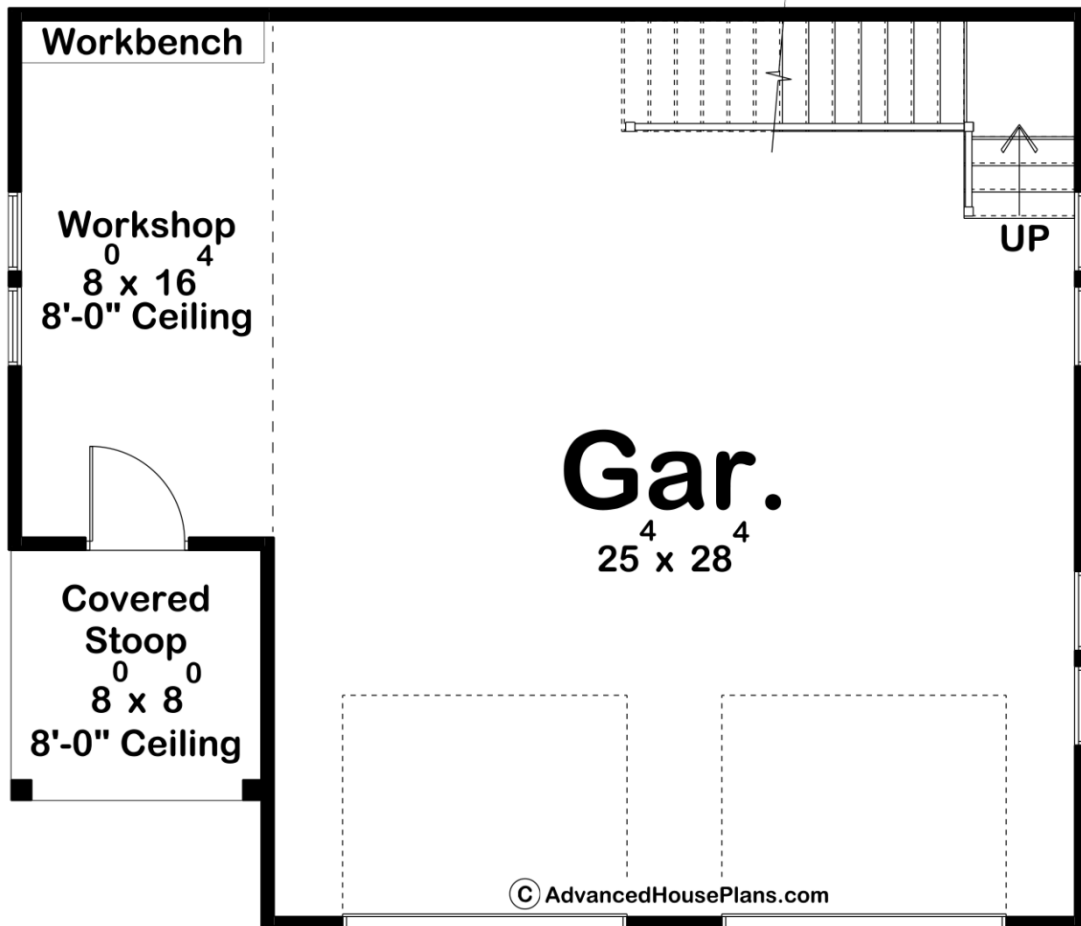

30448 - McAlpine Data Sheet

0 SQ FT	0 BEDS	0 BATHS	2 BAYS	34' 0" WIDE	29' 0" DEEP
------------	-----------	------------	-----------	----------------	----------------



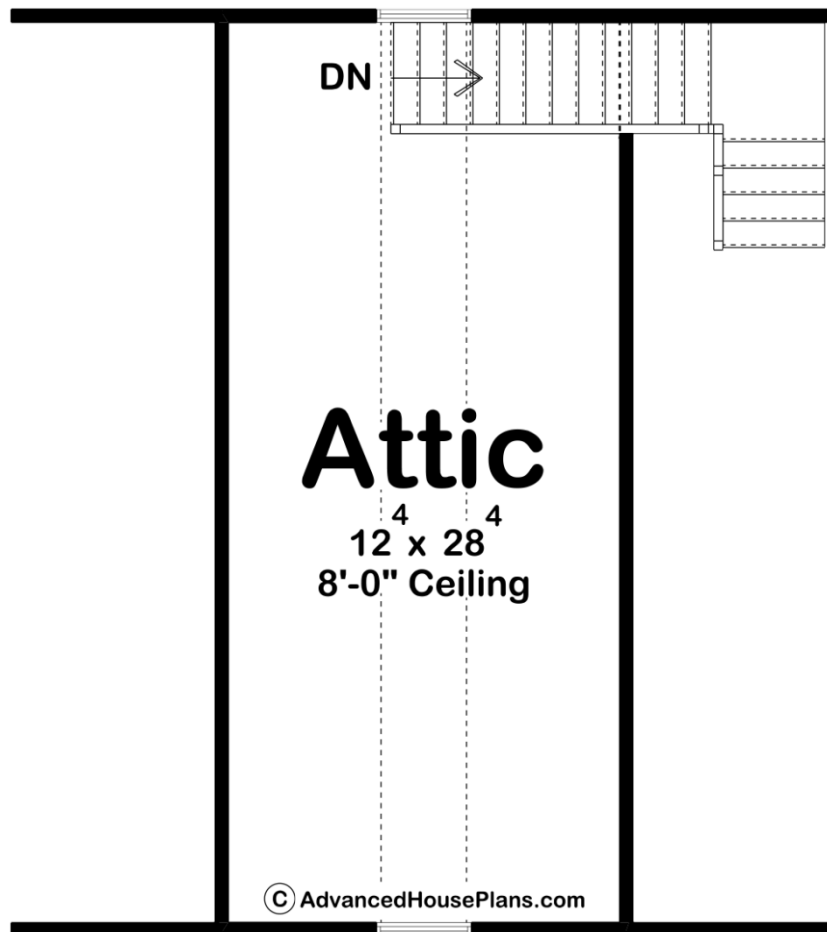

Construction Specs

Layout

Garage Bays 2

Square Footage

Covered Area 64 Sq. Ft.

Garage 890 Sq. Ft.

Exterior Dimensions

Width 34' 0"

Depth 29' 0"

Ridge Height 21' 0"
Calculated from main floor line

Default Construction Stats

Stats are unique to the individual plan.

Foundation Type Slab

Exterior Wall Construction 2x4

Roof Pitches Primary 9/12, Secondary 4/12, 6/12

Plan Description

Introducing the McAlpine, a versatile haven of functionality and potential – a 2-car garage featuring a workshop and an expansive attic space. This meticulously designed structure is tailored to meet the diverse needs of homeowners, offering a seamless blend of practicality and adaptability. The exterior of the garage is a testament to classic design, with a tasteful facade that complements various architectural styles. Sturdy garage doors open to reveal a spacious interior, accommodating two vehicles comfortably and providing a secure shelter against the elements. The workshop, intelligently integrated into the layout, is equipped with a durable workbench, ample storage solutions, and strategically placed power outlets to facilitate a range of DIY projects. Ascend the well-crafted staircase to discover the hidden gem of this structure – the attic space. Bathed in natural light streaming through well-positioned windows, the attic presents itself as a versatile area awaiting your personal touch. This garage is more than just a storage facility; it is a dynamic and adaptable extension of your home. Whether you're a car enthusiast, a DIY hobbyist, or in need of extra living space, this structure effortlessly accommodates your evolving needs, ensuring that your home evolves with you.