

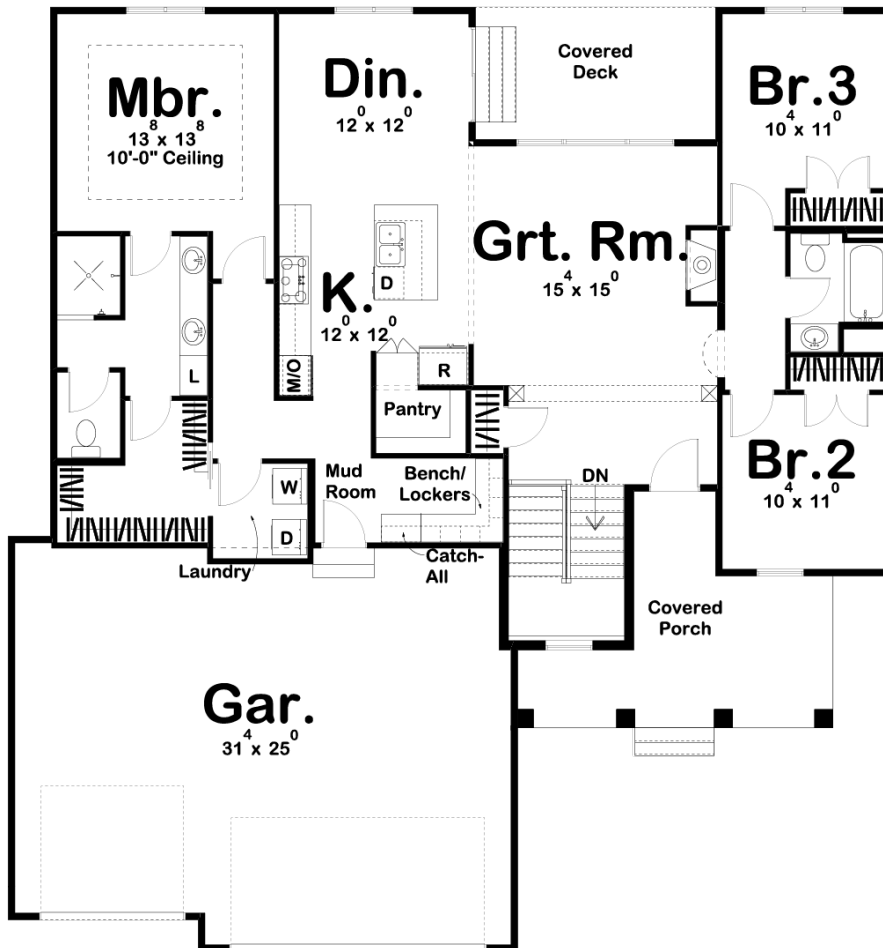

29649 - Meadow Grove Data Sheet

1733 SQ FT	3 BEDS	2 BATHS	3 BAYS	55' 8" WIDE	59' 4" DEEP
---------------	-----------	------------	-----------	----------------	----------------



Construction Specs

Layout

Bedrooms

Bathrooms	2
-----------	---

Garage Bays	3
-------------	---

Square Footage

Main Level	1733 Sq. Ft.
------------	--------------

Garage	775 Sq. Ft.
--------	-------------

Total Finished Area	1733 Sq. Ft.
---------------------	--------------

Exterior Dimensions

Width	55' 8"
-------	--------

Depth	59' 4"
-------	--------

Default Construction Stats

Stats are unique to the individual plan.

Foundation Type	Basement
-----------------	----------

Exterior Wall Construction	2x4
----------------------------	-----

Roof Pitches	8/12 Primary, 12/12 Secondary
--------------	-------------------------------

Foundation Wall Height	9'
------------------------	----

Main Wall Height	9'
------------------	----

Plan Description

Charming Modern Farmhouse details on the outside, coupled with efficiently designed spaces inside, make this 1,733 sq. ft, 1-story house plan an attractive choice for those seeking a home design under 1,800 sq. ft. Just inside from the covered porch, guests are greeted by views into the great room and the rear covered deck beyond. The great room, with fireplace, has open views to the kitchen and dining area -- which expands entertaining options with access to the rear covered deck. The kitchen features a practical island workspace with breakfast bar, in addition to a handy walk-in pantry. Just off the kitchen, a mudroom with built-in bench, lockers, and catch-all area, acts as a buffer between the 3-car garage and the home's living spaces. The secluded master suite features a 10-foot-high boxed ceiling and a bath area that includes dual sinks, compartmented toilet, and a generous walk-in closet. Bedrooms 2 and 3 are located on the opposite side of the home and share a central hall bath.